



Ketley House, SW18

£400,000

 2  2  1  B

- Two bedrooms
- Two bathrooms
- Off Street Car Parking Space
- Chain Free
- Close To Transport
- Modern Development

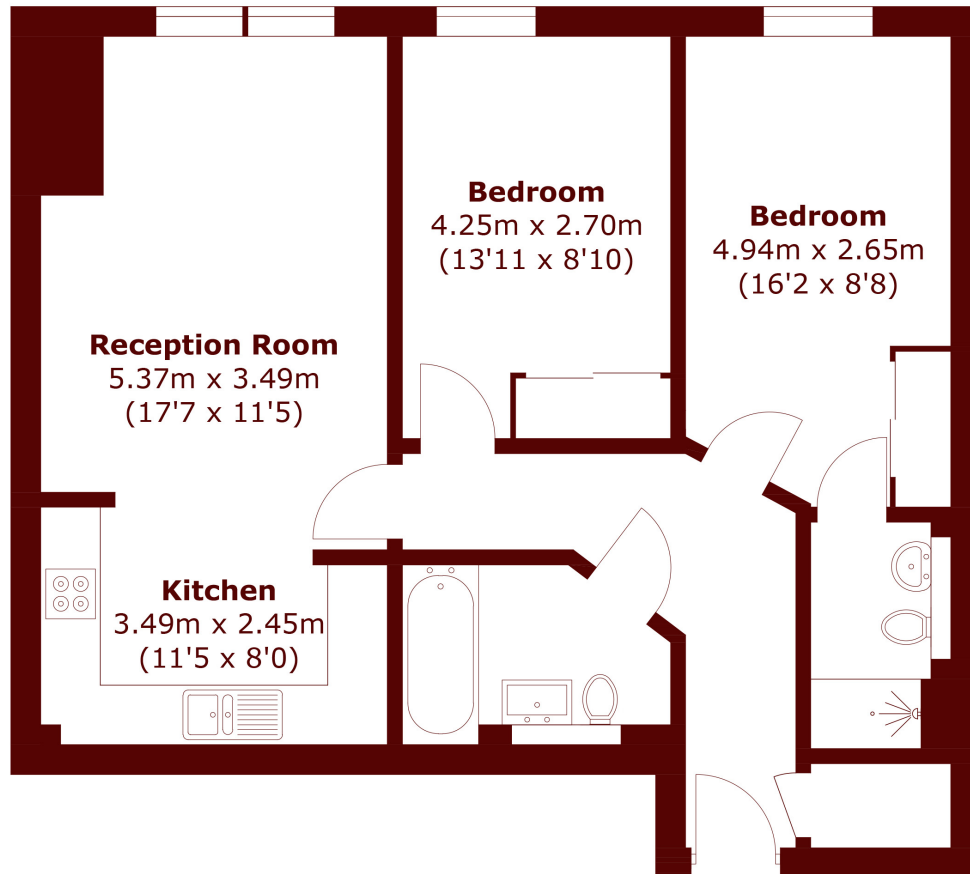

Total area (approx.): 68.2 sq. m (734.0 sq. ft)

Marsh & Parsons Battersea

118 Northcote Road, London,
SW11 6QP
020 8673 4377