



281A Sharrow Vale Road, Sharrow Vale, Sheffield,

£895 Per Calendar Month

- Stunning Duplex Apartment
- Contemporary Kitchen with Appliances
- located In A Vibrant Area
- Viewing Essential
- Superbly Presented Throughout
- Stylish Shower Room
- Close To A Range of Amenities
- One Large Double Bedroom
- Part Furnished
- Yard Garden*

First Floor

Approx. 31.3 sq. metres (337.3 sq. feet)

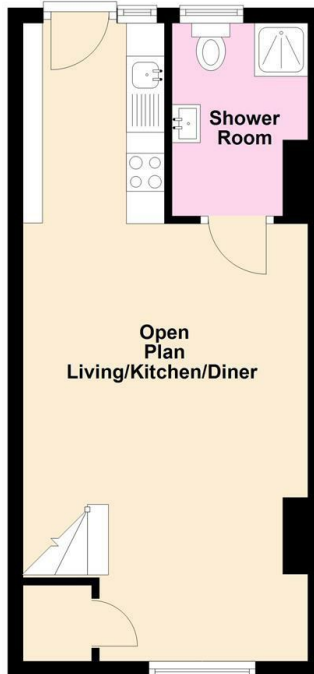

Second Floor

Approx. 18.3 sq. metres (197.4 sq. feet)



281 Sharrow Vale Road, Sheffield

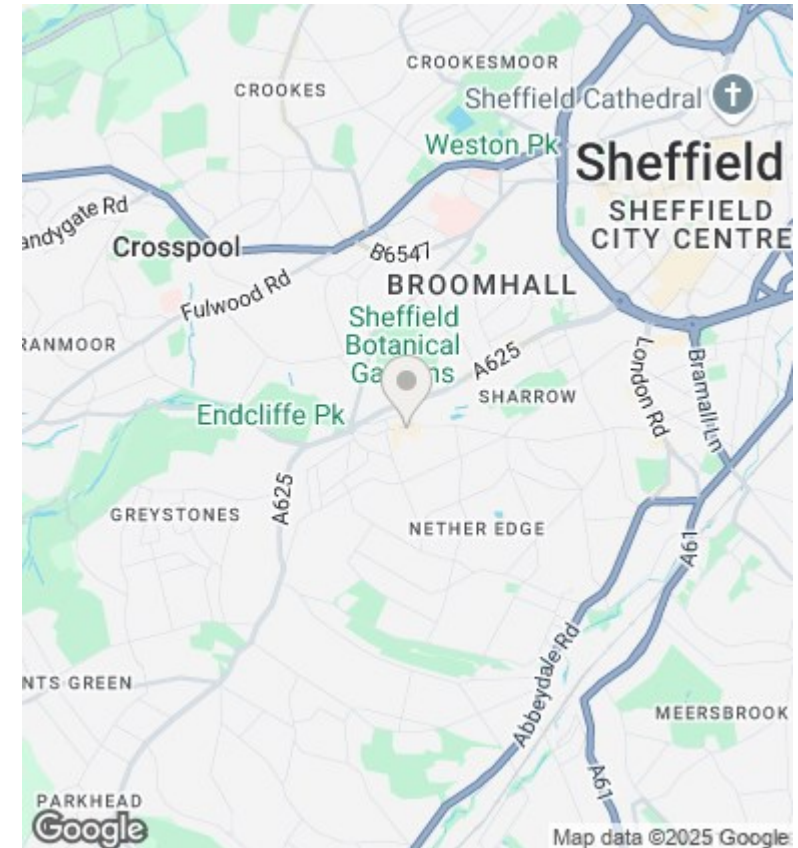

Directions

Viewings

Viewings by arrangement only. Call 0114 283 4050 to make an appointment.

Council Tax Band

EPC Rating:

Energy Efficiency Rating		
	Current	Potential
Very energy efficient - lower running costs		
(92 plus) A		
(81-91) B		
(69-80) C		
(55-68) D		
(39-54) E		
(21-38) F		
(1-20) G		
Not energy efficient - higher running costs		
England & Wales	EU Directive 2002/91/EC	