

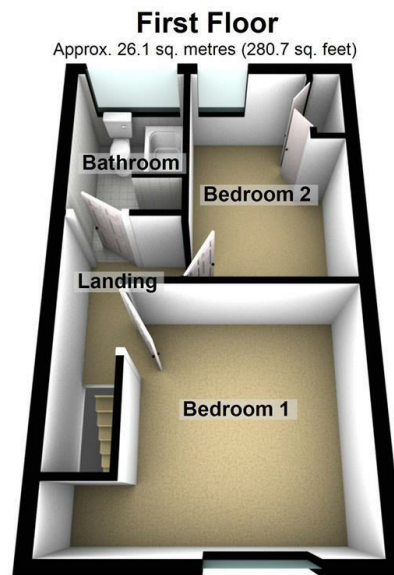

12 The Green, North Wingfield, Chesterfield, £725 Per Calendar Month

- Charming Mid Terraced Home
- Modern Kitchen and Bathroom
- Enclosed Rear Garden
- Close to amenities and M1
- Two Bedrooms
- uPVC Double Glazing
- Un-Furnished
- Well Presented Accommodation
- Gas Centrally Heated
- Pleasant Village Location

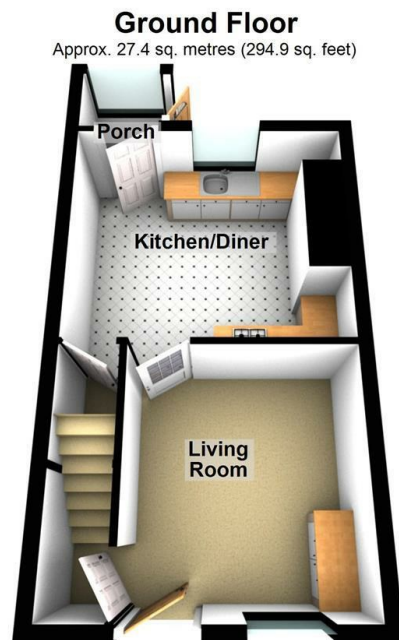

12 The Green, North Wingfield

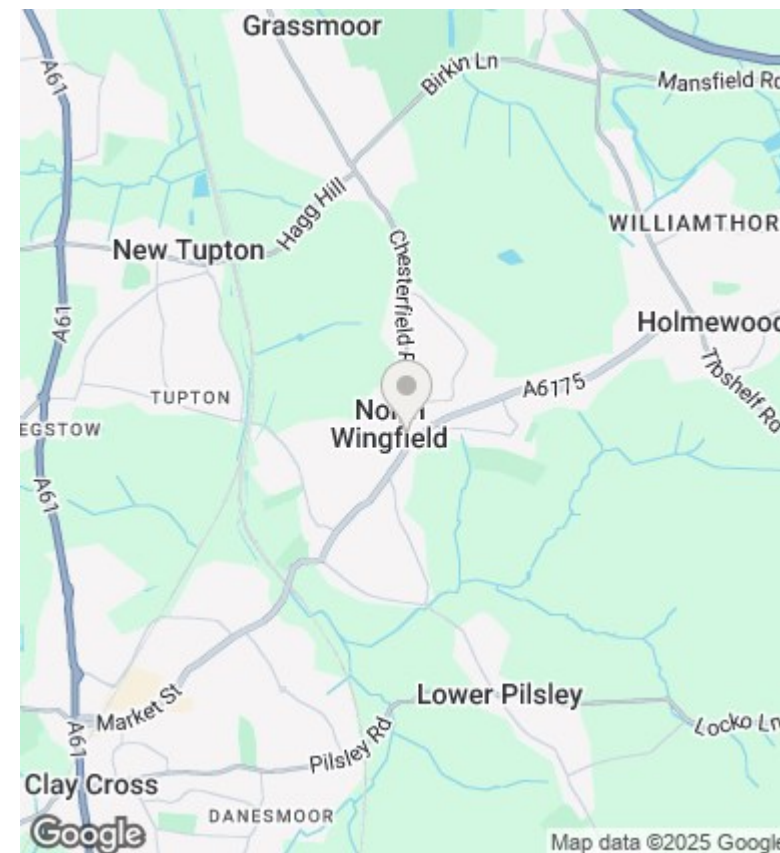

Directions

Viewings

Viewings by arrangement only. Call 0114 283 4050 to make an appointment.

Council Tax Band

B

EPC Rating:

D

Energy Efficiency Rating		
	Current	Potential
Very energy efficient - lower running costs		
(92-plus) A		87
(81-91) B		
(69-80) C	67	
(55-68) D		
(39-54) E		
(21-38) F		
(1-20) G		
Not energy efficient - higher running costs		
England & Wales	EU Directive 2002/91/EC	