

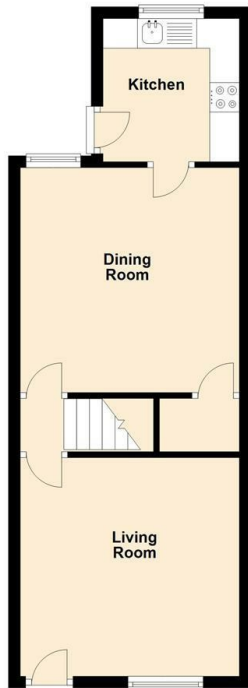

4 School Board Lane, Brampton, Chesterfield,  
£725 PCM

**Ground Floor**  
Approx. 37.6 sq. metres (405.2 sq. feet)



**First Floor**  
Approx. 41.9 sq. metres (451.0 sq. feet)



Total area: approx. 79.5 sq. metres (856.2 sq. feet)  
Whilst every care has been taken to prepare these floor plans, they are for guidance purposes only.  
Plan produced using PlanUp.

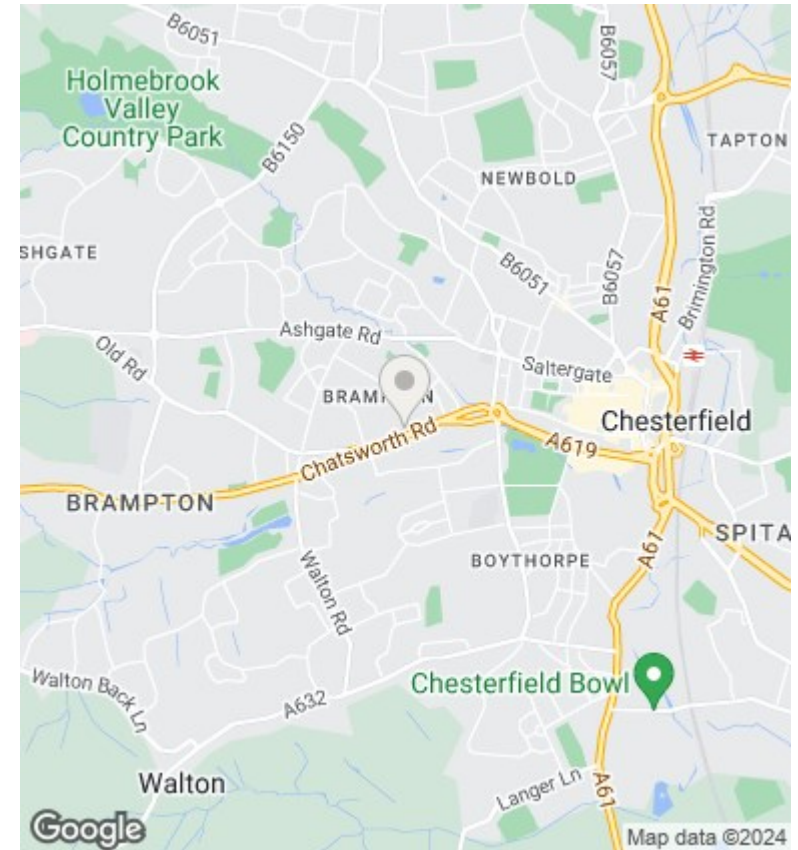

## Directions

## Viewings

Viewings by arrangement only. Call 0114 283 4050 to make an appointment.

## Council Tax Band

B

## EPC Rating:

D

Energy Efficiency Rating		Current	Potential
<i>Very energy efficient - lower running costs</i>			
(92 plus) <b>A</b>			88
(81-91) <b>B</b>			
(69-80) <b>C</b>			
(55-68) <b>D</b>		66	
(39-54) <b>E</b>			
(21-38) <b>F</b>			
(1-20) <b>G</b>			
<i>Not energy efficient - higher running costs</i>			
<b>England &amp; Wales</b>		EU Directive 2002/91/EC	