



Hetherington Road, SW4

£625,000



- Victorian conversion flat
- Generous living space
- West facing garden
- Long lease - 187 years
- Quiet residential street
- Chain free





ABOUT THE PROPERTY

A superb two- double bedroom garden flat on a popular residential street, close to Clapham Common and Brixton. Long lease and offered chain free.

This bright and spacious flat benefits from a superb 187-year lease and generous living space opening onto a lovely west-facing garden. Hetherington Road is a quiet residential street, ideally positioned for the amenities of Clapham Common, Abbeville Village and vibrant Brixton, all offering excellent transport links into the City and West End.



Nearby stations include Clapham North and Brixton Underground (Northern & Victoria lines), along with Clapham High Street (services to Clapham Junction and Canary Wharf via Canada Water), complemented by frequent local bus routes.



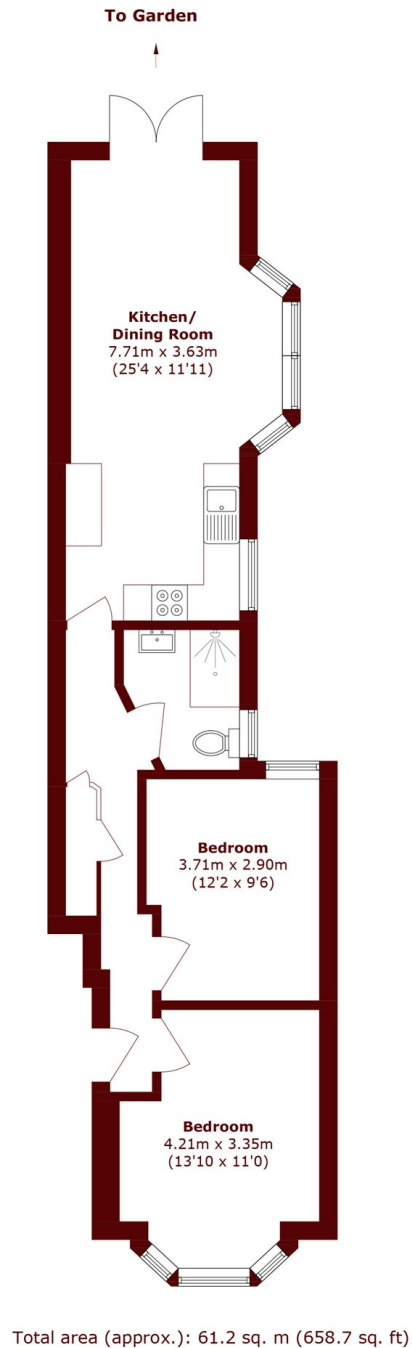

Marsh & Parsons Clapham

28 Old Town, London, SW4

OLB

020 7501 3666