



Ladbroke Grove, W11

£1,250 per week



- Beautifully Renovated
- Raised Ground Floor
- Communal Gardens
- Wooden Flooring
- High Ceilings
- Period Features

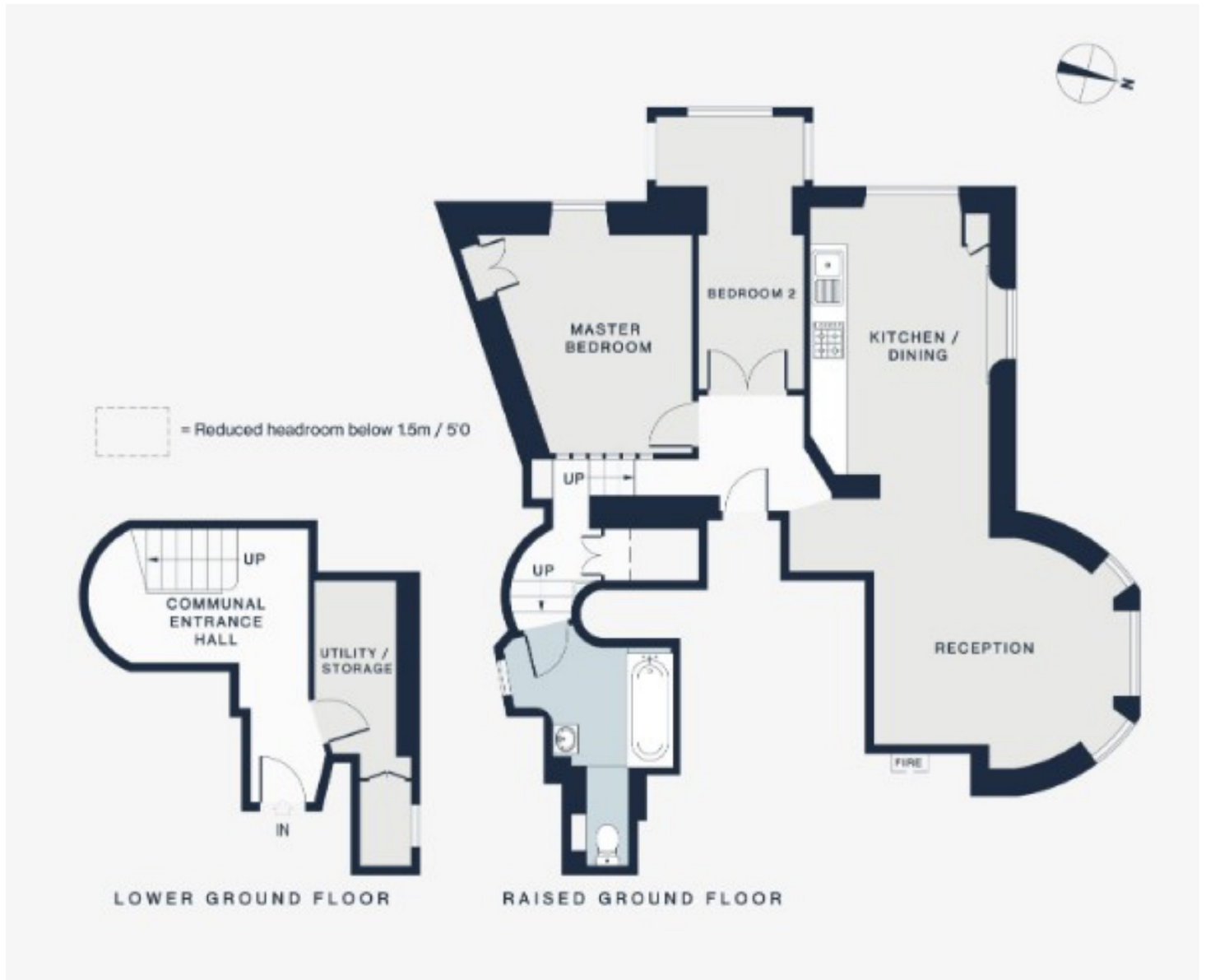

Marsh & Parsons Holland Park

57 Norland Square, London,
W11 4QJ
020 7605 6890

We aim to make our particulars both accurate and reliable. However, they are not guaranteed; nor do they form part of an offer or contract. If you require clarification on any points then please contact us, especially if you're traveling some distance to view. Please note that appliances and heating systems have not been tested and therefore no warranties can be given as to their good working order.