



Kensington Place, W8

£1,350,000

 2  2  1  D

- Two Bedrooms
- Two Bathrooms
- Private Patio
- Porter
- Excellent Kensington Location
- Share of Freehold





ABOUT THE PROPERTY

A two bedroom, two bathroom flat with spacious reception, private patio, off-street parking, lift access and ground floor storage.

This two bedroom flat in Melbourne House, a well-maintained portered building, offers a spacious reception room opening onto a private patio, a modern separate kitchen, two bathrooms and fitted wardrobes. Additional benefits include lift access, off-street parking and a ground floor storage room.

Melbourne House is located on a quiet, one-way residential street in the Hill Gate Village area of Kensington, offering easy access to either Notting Hill Gate or High Street Kensington tube stations (Circle, District and Central lines) as well as the A4 to Heathrow and M4.



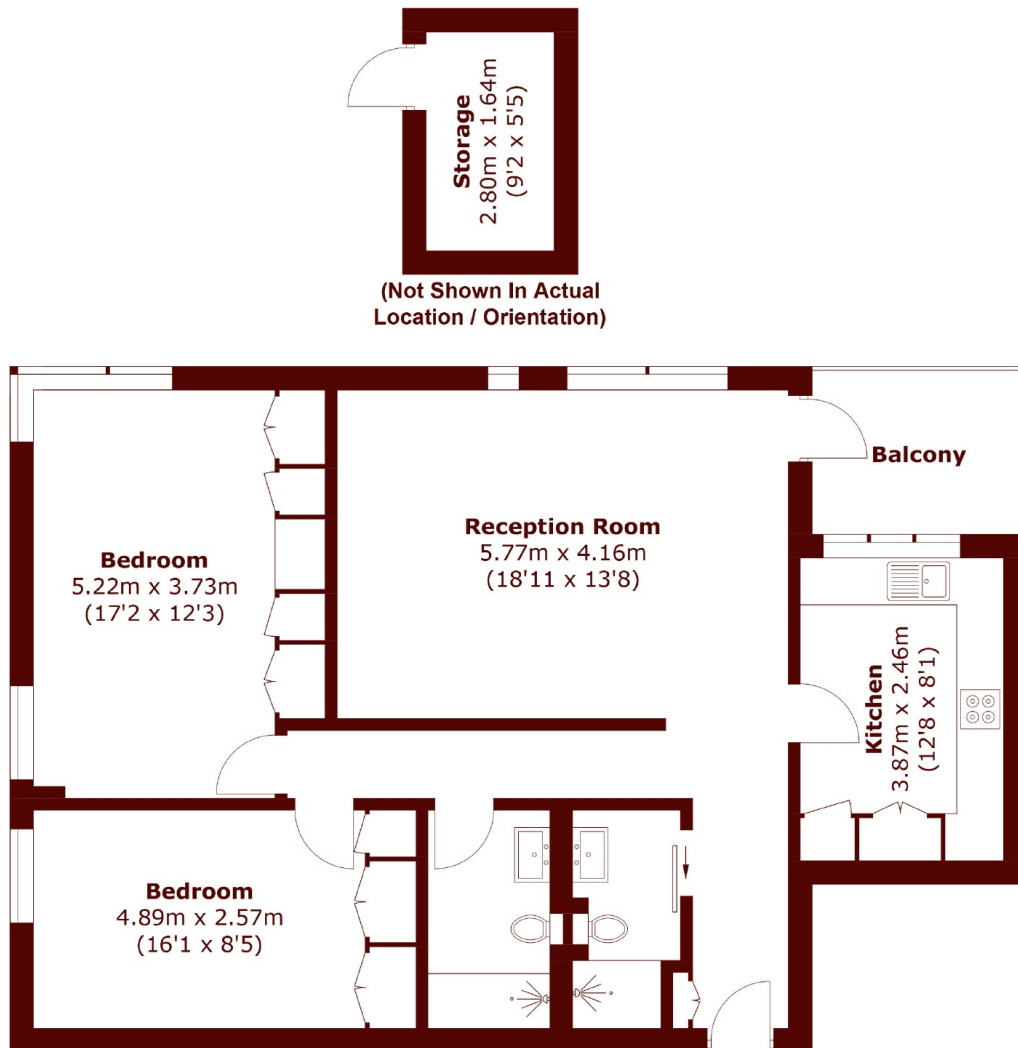

(Not Shown In Actual
Location / Orientation)

Total area (approx.): 89.6 sq. m (964.4 sq. ft)
External Storage: 4.7 sq. m (50.6 sq. ft)
Balcony: 5.6 sq. m (60.3 sq. ft)

Marsh & Parsons Kensington

9 Kensington Church Street,
London, W8 4LF
020 7368 4450