



Chambers Walk Stanmore £3,500 Per month

A four bedroom, three bathroom, townhouse available in excellent condition with Davidson Frost-Wellings.

Downstairs on the ground floor, there is a large bay windowed reception room, a guest WC, and a good size dine-in kitchen providing access to a pergola-covered patio, pretty garden with lawn, flowerbeds, and a summerhouse.

On the first floor there are three double bedrooms, one with built-in wardrobes and an ensuite bathroom, another also with built in wardrobes, as well as a modern family bathroom. On the top floor there is an excellent airing cupboard plus master bedroom suite with an ensuite bathroom and built-in wardrobes.

Stanmore Park is a popular development in the heart of Stanmore close to the shops, cafes, restaurants and amenities of Stanmore Broadway and Church Road, offering access to multiple transport links and Stanmore Tube Station. Stanmore Park also offers a convenient location for a multitude of local schools.

Harrow council tax band G
Security deposit of £4,038.46 based on the full asking price.

- Four bedrooms
- Three bathrooms
- End of terrace townhouse
- Excellent condition
- Attractive garden and summerhouse

Viewing

Please contact our Davidson Frost-Wellings Office on 020 8954 8806 if you wish to arrange a viewing appointment for this property or require further information.



Floor Plan

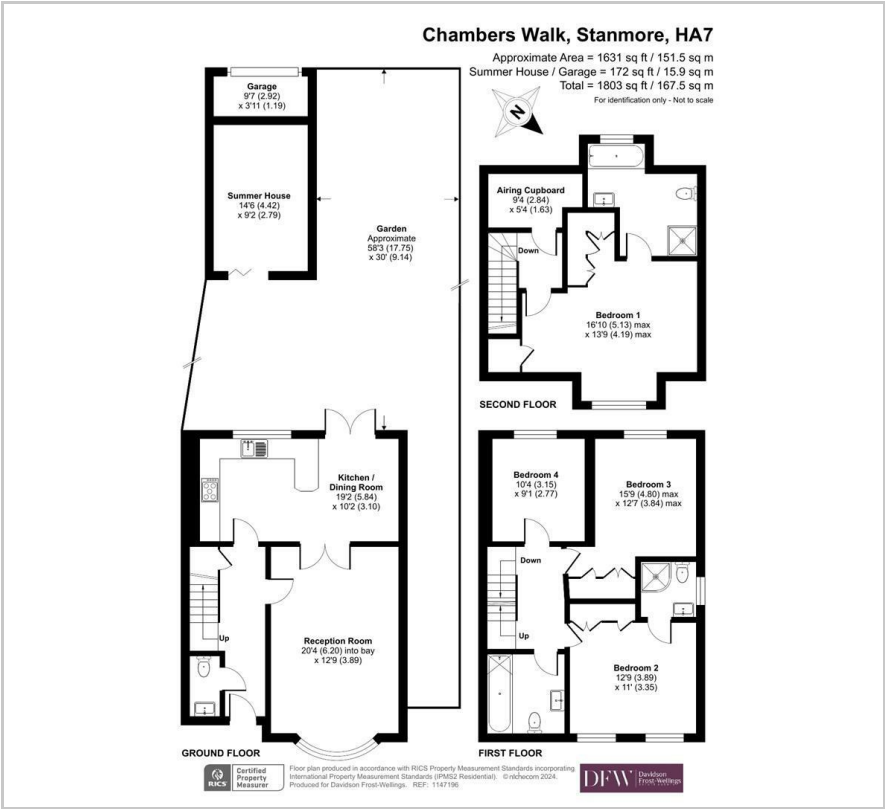

Area Map

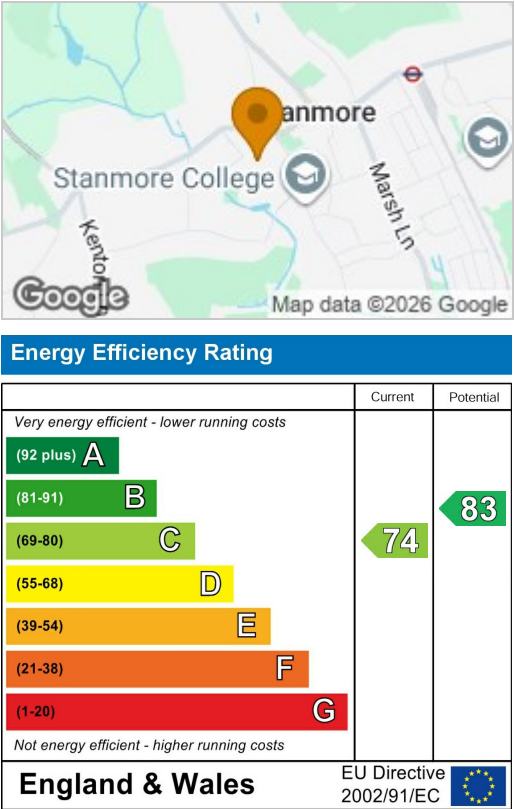

These particulars, whilst believed to be accurate are set out as a general outline only for guidance and do not constitute any part of an offer or contract. Intending purchasers should not rely on them as statements of representation of fact, but must satisfy themselves by inspection or otherwise as to their accuracy. No person in this firms employment has the authority to make or give any representation or warranty in respect of the property.