



California Lane

Bushey

£2,250,000

A beautiful five bedroom family detached house available with Davidson Frost-Wellings on a premier road in Bushey Heath.

Downstairs the house has a large reception room with feature fireplace and windows overlooking the rear garden. There is also a modern, dine-in kitchen, open plan to an L-shaped family room offering great space for modern family life. In addition downstairs there is a bay windowed dining room, office room and two utility rooms off the kitchen.

Upstairs, on the first floor, is the master bedroom with built-in wardrobes, a walk-in closet and En Suite bathroom. There are also three further double bedrooms, a family bathroom and a spacious store room. On the second floor is a spacious loft-conversion offering eaves storage, a double bedroom with built-in wardrobes and En Suite bathroom.

To the rear of the property is a secluded, private garden with patio and mostly laid to lawn with a mature border, plus a summer house with over 200 sq ft of space. The front of the property provides parking for multiple cars, and a small integrated garage.

Hertsmere council tax band E.

- Five bedrooms
- Three bathrooms
- Multiple reception rooms
- Chain free
- 116' rear garden
- Detached freehold

Viewing

Please contact our Davidson Frost-Wellings Office on 020 8954 8806 if you wish to arrange a viewing appointment for this property or require further information.

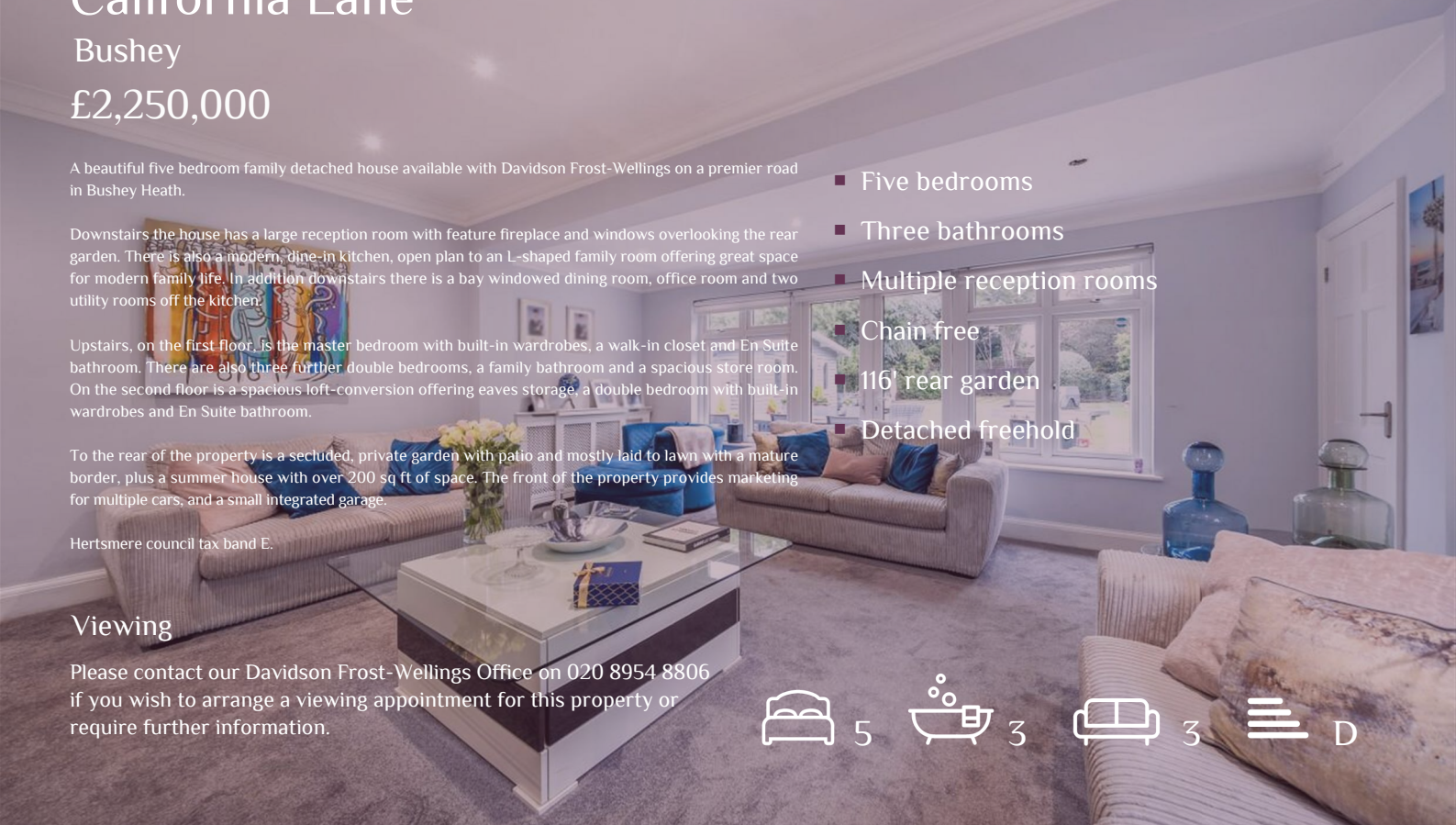

Floor Plan

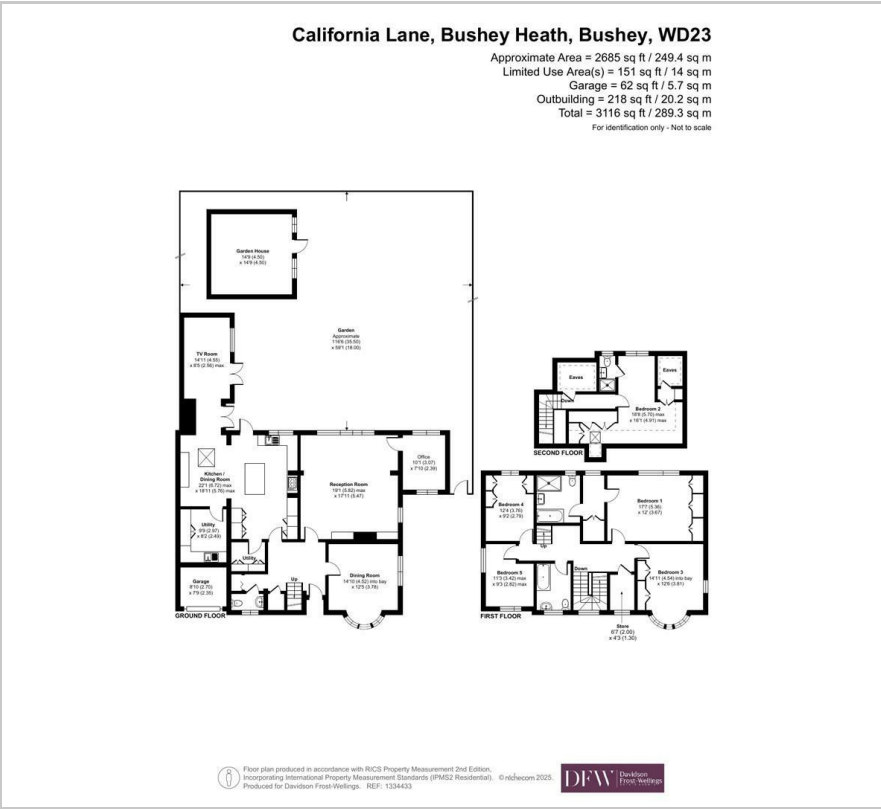

Area Map

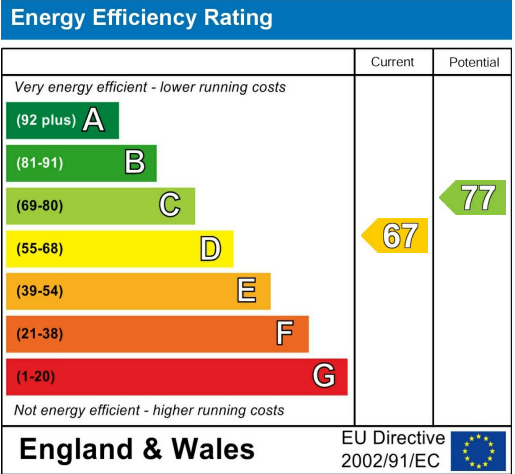

These particulars, whilst believed to be accurate are set out as a general outline only for guidance and do not constitute any part of an offer or contract. Intending purchasers should not rely on them as statements of representation of fact, but must satisfy themselves by inspection or otherwise as to their accuracy. No person in this firms employment has the authority to make or give any representation or warranty in respect of the property.