



Longcrofte Road

Edgware

£525,000

A large 943 square foot, first floor, two bedroom, two bathroom flat available chain free with Davidson Frost-Wellings.

Bartholomew Court is set in a modern, purpose built gated community, offering optimal security, and an excellent location for transport links and local shops, with allocated parking, free visitor parking spaces and communal gardens.

The flat has a large reception room with Juliette balcony, and a separate eat-in kitchen. There is also an impressive master suite with built-in wardrobes and ensuite bathroom, plus a second double bedroom and family bathroom.

Leasehold with 96 years remaining.
Service charge approximately £2,500 per annum.
Ground Rent £200 per annum.
Harrow Council Tax Band F.

Viewing

Please contact our Davidson Frost-Wellings Office on 020 8954 8806 if you wish to arrange a viewing appointment for this property or require further information.

- Two bedrooms
- Two bathrooms
- Chain free
- Krishna Avanti catchment
- Gated and allocated parking
- Communal gardens

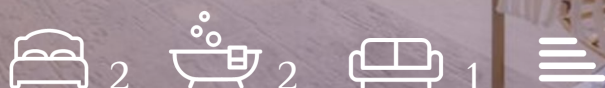

Floor Plan

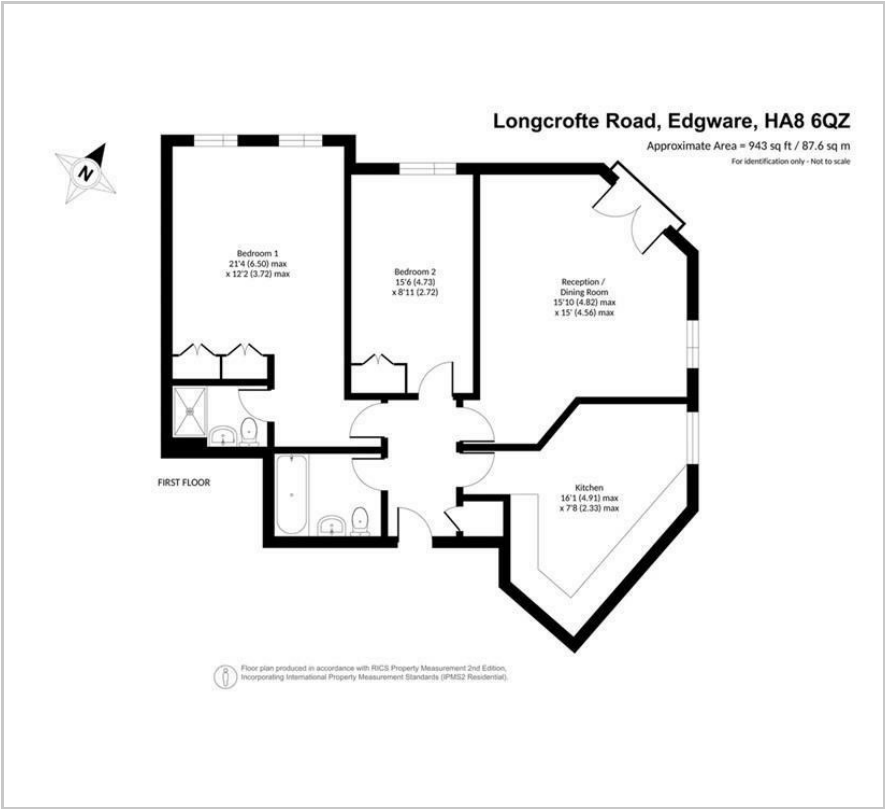

Area Map

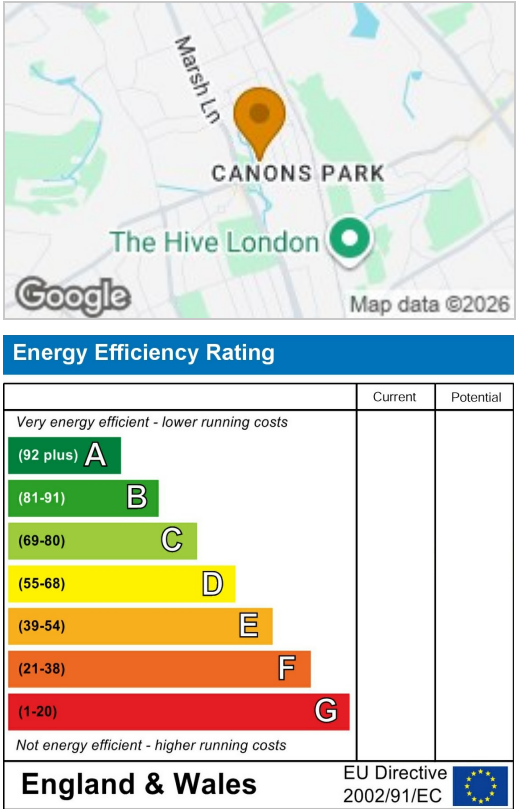

These particulars, whilst believed to be accurate are set out as a general outline only for guidance and do not constitute any part of an offer or contract. Intending purchasers should not rely on them as statements of representation of fact, but must satisfy themselves by inspection or otherwise as to their accuracy. No person in this firms employment has the authority to make or give any representation or warranty in respect of the property.