



Stanmore Hill

Stanmore

£275,000

This charming first floor one-bedroom apartment offers modern living in the heart of Stanmore with integrated appliances, modern fully tiled bathroom, flooring throughout and allocated parking.

Featuring a spacious open-plan kitchen and living area, this property is ideal for first-time buyers, professionals and investors seeking convenience and style. The apartment is located just a 1-minute walk from Stanmore's vibrant shops and amenities, with Stanmore station only a 7-minute walk away.

Stanmore is a delightful village, located in the North West of London. It offers the perfect blend of suburban tranquillity and urban convenience, making it a highly desirable area for property buyers. Known for its leafy streets, open green spaces and a sense of community, Stanmore is an ideal location for those seeking a peaceful lifestyle without sacrificing connectivity to central London.

Leasehold with 150 Years from 2019
Ground Rent of approximately £350 per year.
Service Charge of approximately £1300 per year.
Harrow Council Tax Band C.

- One bedroom
- High quality oak laminate wood flooring in hall and living room
- Lift
- Allocated parking space

Open plan kitchen with Quartz stone worktop

Contemporary bathroom with chrome heated towel radiator

Viewing

Please contact our Davidson Frost-Wellings Office on 020 8954 8806 if you wish to arrange a viewing appointment for this property or require further information.



Floor Plan

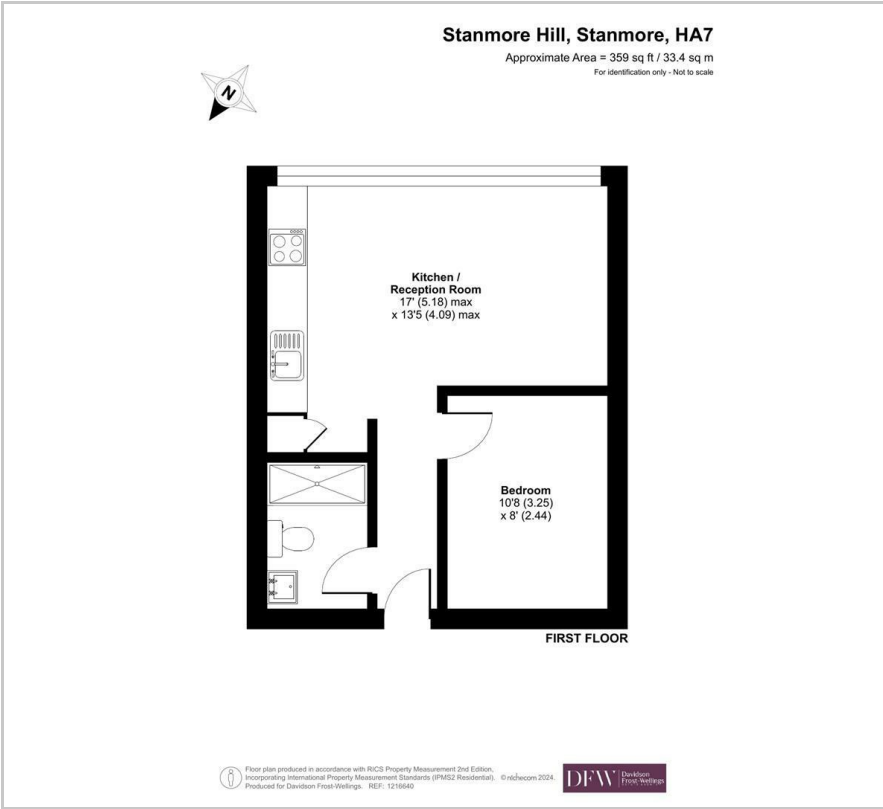

Area Map

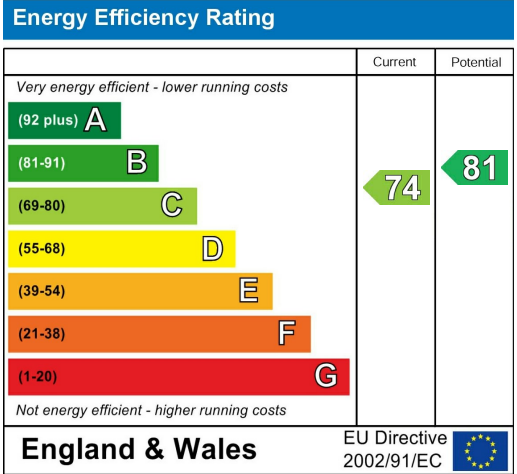

These particulars, whilst believed to be accurate are set out as a general outline only for guidance and do not constitute any part of an offer or contract. Intending purchasers should not rely on them as statements of representation of fact, but must satisfy themselves by inspection or otherwise as to their accuracy. No person in this firms employment has the authority to make or give any representation or warranty in respect of the property.