



Brindley Court South

Stanmore Place

£1,600 Per month

A modern and spacious flat in a popular development close to Canons Park Station available immediately with Davidson Frost-Wellings.

On the top floor with a large roof terrace, lots of storage and in good condition throughout. The flat has an open plan kitchen/living room, large double bedroom with built-in wardrobes and a spacious family bathroom.

Potentially fully furnished.

Harrow Council Tax Band C.

Deposit of £1,846.15 based on the full asking price.

- One Bedroom
- Top Floor
- Modern Building
- Available Furnished
- Amazing Roof Terrace
- Available Immediately

Viewing

Please contact our Davidson Frost-Wellings Office on 020 8954 8806 if you wish to arrange a viewing appointment for this property or require further information.



Floor Plan

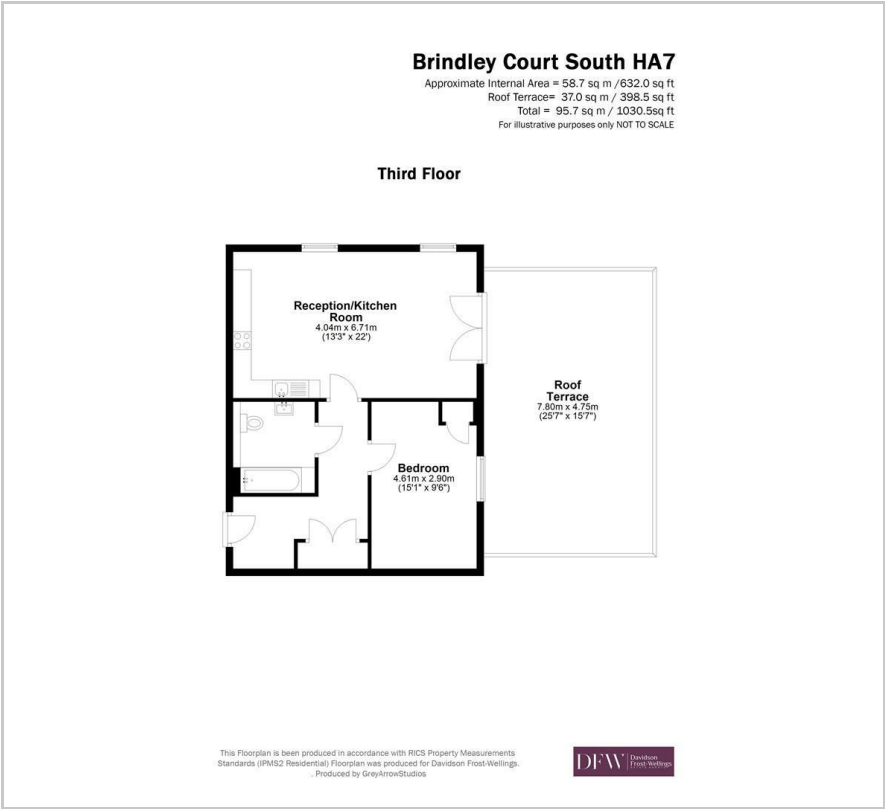

Area Map

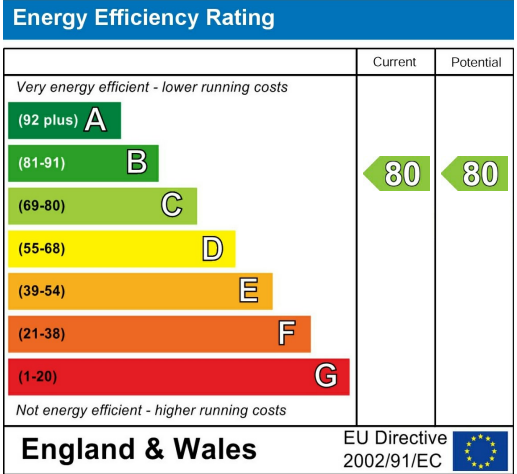

These particulars, whilst believed to be accurate are set out as a general outline only for guidance and do not constitute any part of an offer or contract. Intending purchasers should not rely on them as statements of representation of fact, but must satisfy themselves by inspection or otherwise as to their accuracy. No person in this firms employment has the authority to make or give any representation or warranty in respect of the property.