



Sterling Avenue

Edgware

£1,700 Per month

A well presented, two double bedroom maisonette in Edgware. With a large reception room, separate kitchen and family bathroom all in excellent condition.

The property benefits from a private patio which leads to well maintained communal gardens to the rear, as well as its own front door and allocated off-street parking for one car

Sterling Avenue is a quiet, no-through road equidistant from Edgware Station (Northern Line) and Stanmore Station (Jubilee Line).

Barnet Council Tax Band D.

Deposit of £1,961.53 based on the full asking price.

Viewing

Please contact our Davidson Frost-Wellings Office on 020 8954 8806 if you wish to arrange a viewing appointment for this property or require further information.

- Two Bedrooms
- Excellent Condition
- Separate Kitchen
- Private Patio and Communal Gardens
- Own Front Door
- Off Street Parking

Floor Plan

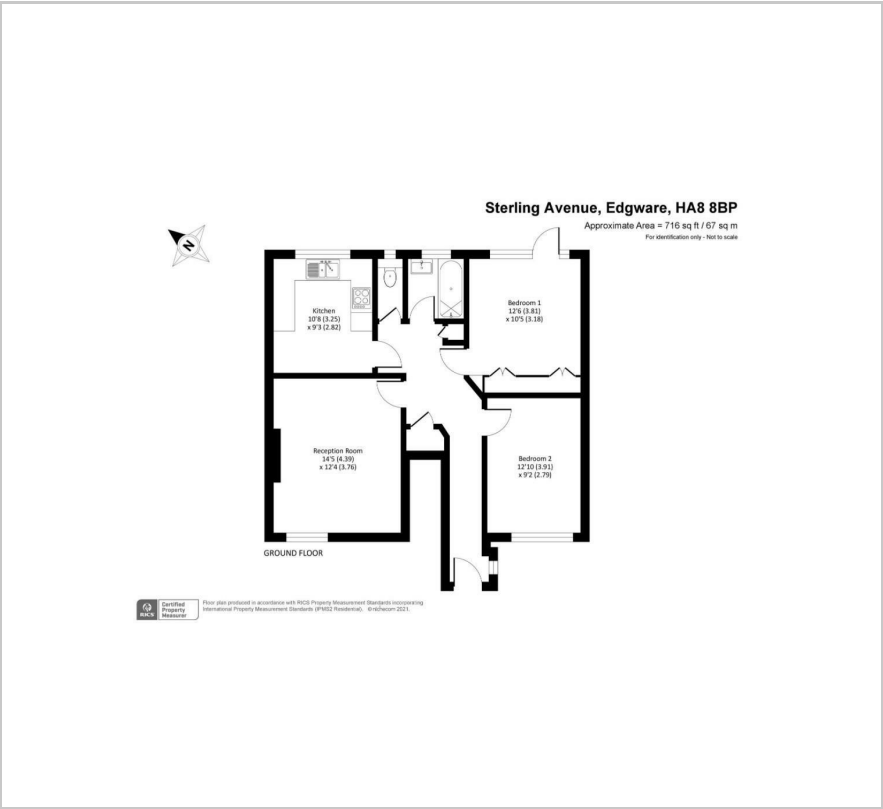

Area Map

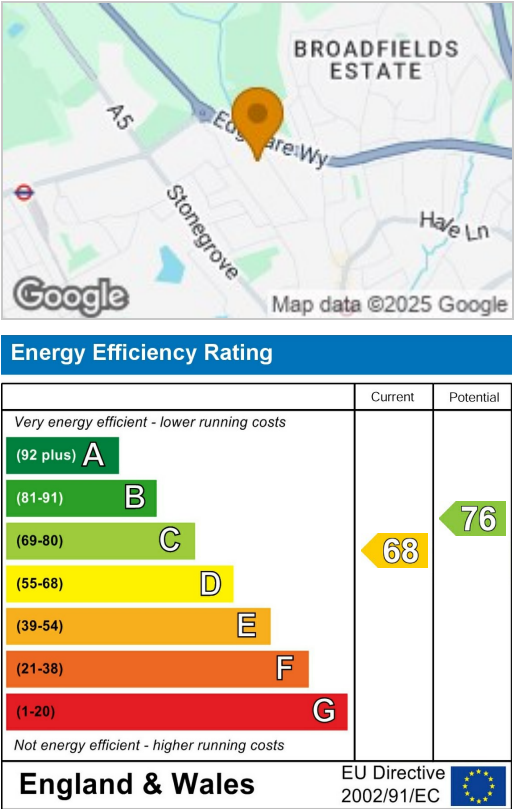

These particulars, whilst believed to be accurate are set out as a general outline only for guidance and do not constitute any part of an offer or contract. Intending purchasers should not rely on them as statements of representation of fact, but must satisfy themselves by inspection or otherwise as to their accuracy. No person in this firms employment has the authority to make or give any representation or warranty in respect of the property.