



## Chatsworth Court Stanmore

Asking price £449,999

A two bedroom, two bathroom ground floor flat available with Davidson Frost-Wellings in a central Stanmore location. This flat has a spacious reception room with a separate large kitchen area, large master bedroom with built-in wardrobes and ensuite bathroom, an additional second bedroom and a family bathroom.

The flat also comes with a separate single garage.

Chatsworth Court is walking distance to both Stanmore Tube Station for the Jubilee line and Stanmore Broadway.

Leasehold with 84 years remaining.  
Service Charge of £2,104 per annum  
Ground Rent of £195 per annum  
Harrow Council Tax Band F.

- Two bedrooms
- Two bathrooms
- Garage
- Chain Free
- Communal Gardens
- Fitted kitchen

### Viewing

Please contact our Davidson Frost-Wellings Office on 020 8954 8806 if you wish to arrange a viewing appointment for this property or require further information.





Floor Plan

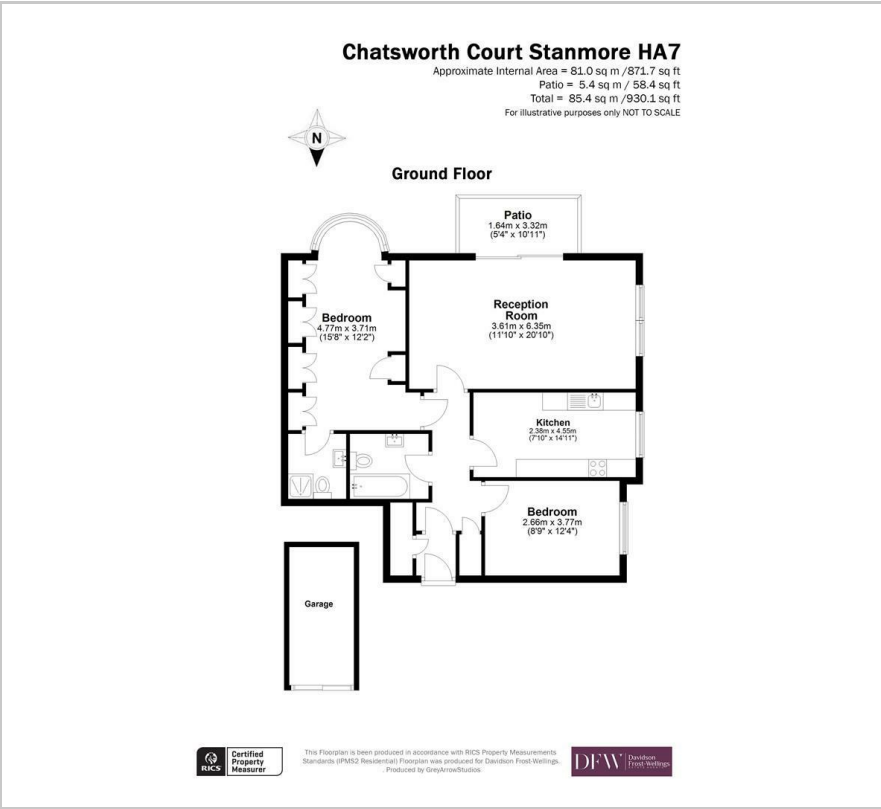

Area Map

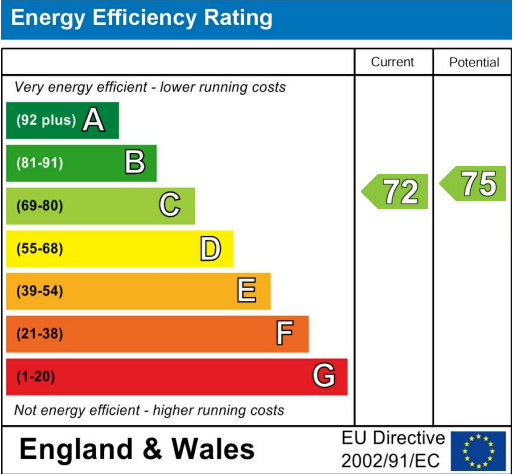

These particulars, whilst believed to be accurate are set out as a general outline only for guidance and do not constitute any part of an offer or contract. Intending purchasers should not rely on them as statements of representation of fact, but must satisfy themselves by inspection or otherwise as to their accuracy. No person in this firms employment has the authority to make or give any representation or warranty in respect of the property.