



Union Court, Fauna Walk

Watford

£2,100 Per month

Davidson Frost-Wellings are pleased to present this two bedroom, two bathroom third floor brand new flat. This flat has access to a gym, 24 hour concierge and meeting rooms plus a cinema.

Union Court is a 4 minute walk from Watford Junction station taking you into London in 14 minutes which makes this development an amazing location for commuters. Residents facilities include 24 hour concierge, gym, cinema and a business lounge.

Union Court has its own roof garden on the 9th floor however the development is surrounded by landscaped gardens and walkways

Available 1st May 2025.

Deposit of £2,538.46 based on the full asking price.

Watford Council Tax Band D.

- Two bedrooms
- Two bathrooms
- Balcony
- Gym plus cinema room
- 24 hour Concierge
- Close to Watford junction station

Viewing

Please contact our Davidson Frost-Wellings Office on 020 8954 8806 if you wish to arrange a viewing appointment for this property or require further information.



Floor Plan

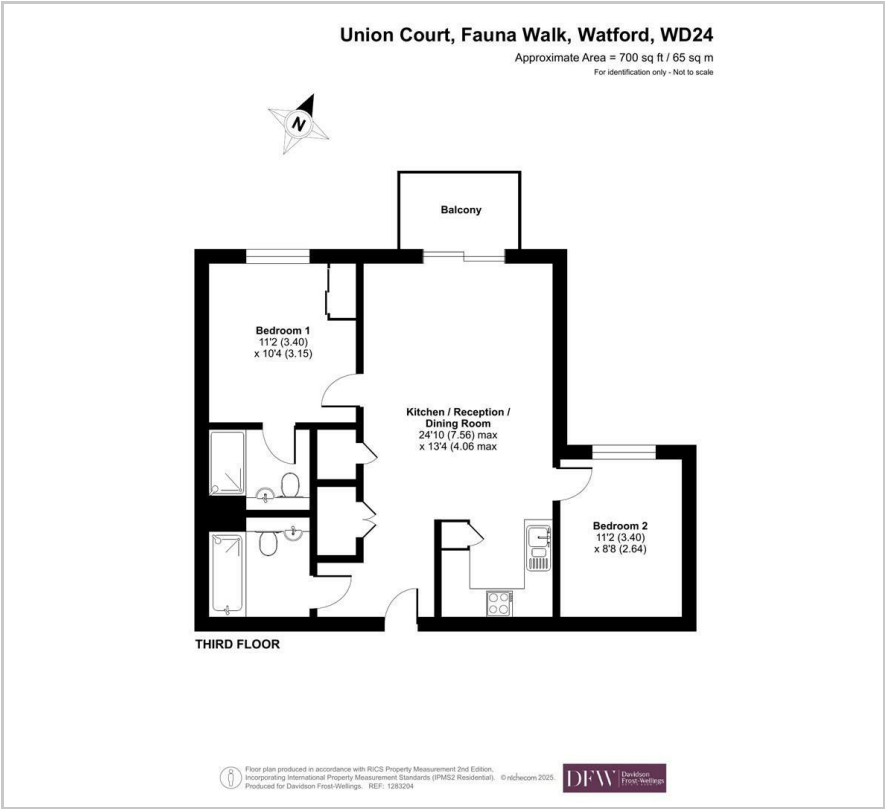

Area Map

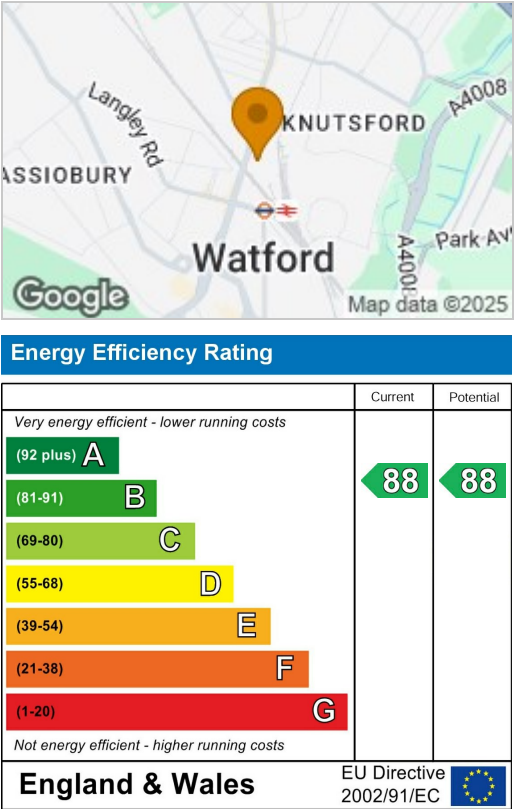

These particulars, whilst believed to be accurate are set out as a general outline only for guidance and do not constitute any part of an offer or contract. Intending purchasers should not rely on them as statements of representation of fact, but must satisfy themselves by inspection or otherwise as to their accuracy. No person in this firms employment has the authority to make or give any representation or warranty in respect of the property.