



Culverlands Close

Stanmore

£489,999

A three bedroom flat with over 1000 sq ft of space available on a quiet residential road in Stanmore with Davidson Frost-Wellings.

The flat has a large reception room with floor-to-ceiling windows ensuring lots of natural light throughout the day, with a separate kitchen. The master bedroom has lots of fitted wardrobes, there are two further bedrooms and a family bathroom.

The property has a separate single garage and communal gardens accessible directly from the flat.

Share of freehold with a long underlying lease.
Service Charge of approximately £1440 payable quarterly.
Ground Rent nil.
Harrow Council Tax Band D.

- Three bedrooms
- Over 1000 sq ft
- Separate kitchen
- Residential cul-de-sac
- Bright reception room
- Separate single garage

Viewing

Please contact our Davidson Frost-Wellings Office on 020 8954 8806 if you wish to arrange a viewing appointment for this property or require further information.



3



1



1



C

Floor Plan

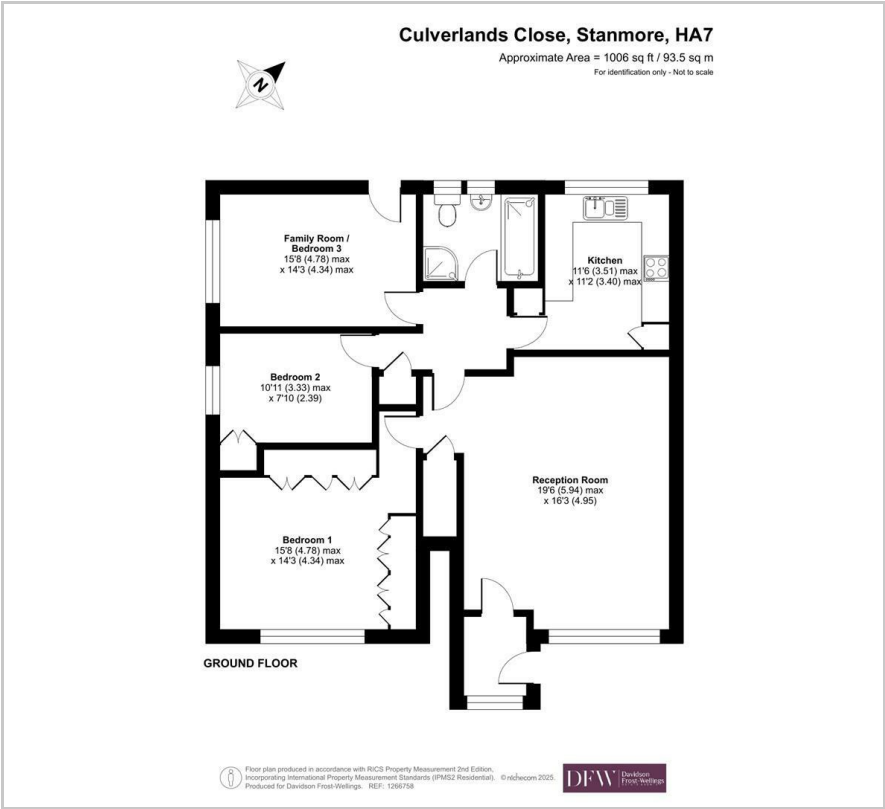

Area Map

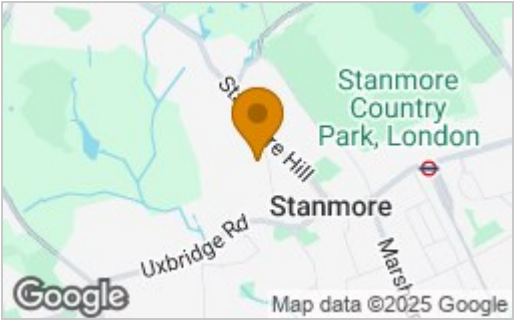

Energy Efficiency Rating		
	Current	Potential
Very energy efficient - lower running costs		
(92 plus) A		
(81-91) B		
(69-80) C		
(55-68) D		
(39-54) E		
(21-38) F		
(1-20) G		
Not energy efficient - higher running costs		
	70	76
England & Wales	EU Directive 2002/91/EC	



These particulars, whilst believed to be accurate are set out as a general outline only for guidance and do not constitute any part of an offer or contract. Intending purchasers should not rely on them as statements of representation of fact, but must satisfy themselves by inspection or otherwise as to their accuracy. No person in this firms employment has the authority to make or give any representation or warranty in respect of the property.