



## Regency Court

Stanmore Place

### Offers over £350,000

A one bedroom second floor flat available chain free with Davidson Frost-Wellings in Stanmore Place.

The flat comes with an open-plan kitchen / reception room, a double bedroom with private balcony overlooking the communal gardens and fountains. There is also a large family bathroom and lots of built-in storage.

Stanmore Place is in an excellent location for Canon's Park tube station. On site and included for tenants is a gym, a children's playground, a 24 hour concierge and a secure parking space.

Leasehold with 999 years from 2010  
Service Charge of Approximately £3000 per annum.  
Ground Rent of Approximately £500 pa  
Harrow Council Tax Band C.

#### Viewing

Please contact our Davidson Frost-Wellings Office on 020 8954 8806 if you wish to arrange a viewing appointment for this property or require further information.

- One bedroom
- Allocated Parking space
- Open plan kitchen
- Communal gardens
- Second floor
- Balcony



1



1



1



B



Floor Plan

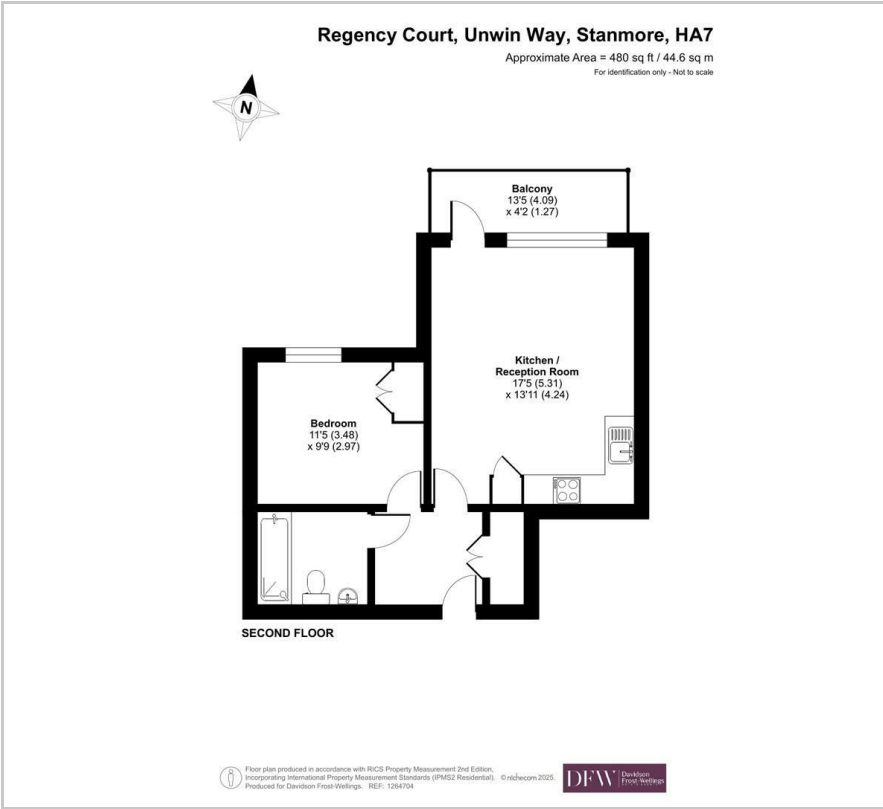

Area Map



Energy Efficiency Rating		
	Current	Potential
Very energy efficient - lower running costs		
(92 plus) <b>A</b>		
(81-91) <b>B</b>	<b>81</b>	<b>81</b>
(69-80) <b>C</b>		
(55-68) <b>D</b>		
(39-54) <b>E</b>		
(21-38) <b>F</b>		
(1-20) <b>G</b>		
Not energy efficient - higher running costs		
<b>England &amp; Wales</b>	EU Directive 2002/91/EC	



These particulars, whilst believed to be accurate are set out as a general outline only for guidance and do not constitute any part of an offer or contract. Intending purchasers should not rely on them as statements of representation of fact, but must satisfy themselves by inspection or otherwise as to their accuracy. No person in this firms employment has the authority to make or give any representation or warranty in respect of the property.