



## Rusper Close

Stanmore

£425,000

A three bedroom, first floor flat with nearly 1000 sq ft of space, available chain free in an excellent location with Davidson Frost-Wellings.

The flat is available with a large L-shaped kitchen and reception room with multiple aspect and doors leading to a private balcony. There are three double bedrooms, a family bathroom with a separate WC as well as multiple built-in storage cupboards.

Rusper Close is a purpose built block within easy reach of Stanmore Tube Station and the shops, cafes and amenities of Stanmore Broadway. Off street, gated, parking is available for residents.

New lease of 125 years from February 2025.

Peppercorn ground rent.

Service charges of £1,860 per annum.

Harrow Council Tax Band D.

- Three bedrooms
- Private balcony
- Gated off street parking
- Open plan kitchen
- First floor flat
- Leasehold

### Viewing

Please contact our Davidson Frost-Wellings Office on 020 8954 8806 if you wish to arrange a viewing appointment for this property or require further information.





Floor Plan

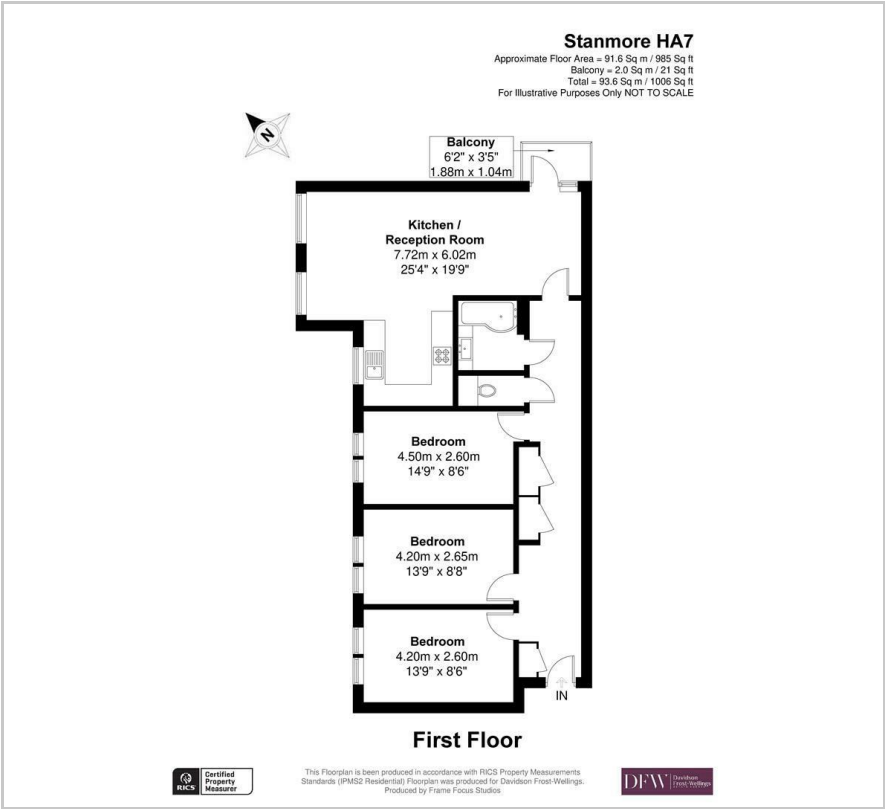

Area Map

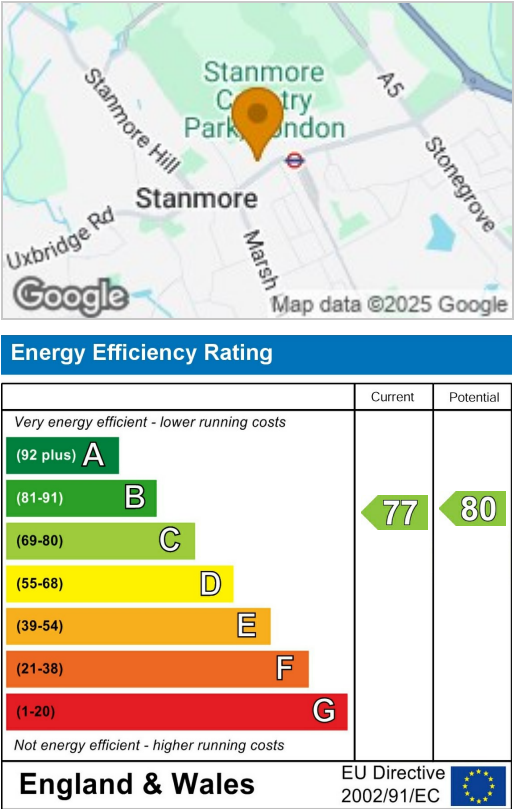

These particulars, whilst believed to be accurate are set out as a general outline only for guidance and do not constitute any part of an offer or contract. Intending purchasers should not rely on them as statements of representation of fact, but must satisfy themselves by inspection or otherwise as to their accuracy. No person in this firms employment has the authority to make or give any representation or warranty in respect of the property.