



## Sunningdale Close

Stanmore

£699,999

A three bedroom, end of terrace house available chain free with Davidson Frost-Wellings.

On the ground floor the house has a large, L-shaped reception room with French doors leading to a large private rear garden. There is also a separate kitchen and guest WC. On the first floor is an impressive master bedroom with built-in wardrobes and ensuite bathroom. In addition, there are two further bedrooms and a family bathroom.

The house is available chain free with extension potential at the rear, into the loft and at the side (subject to planning permission). There is a separate single garage and unrestricted on-street parking.

Harrow Council Tax Band G.

### Viewing

Please contact our Davidson Frost-Wellings Office on 020 8954 8806 if you wish to arrange a viewing appointment for this property or require further information.

- Three bedrooms
- Two bathrooms
- Extension potential (STPP)
- Chain free
- Single garage
- Cul-De-Sac location



3



2



1



C



Floor Plan

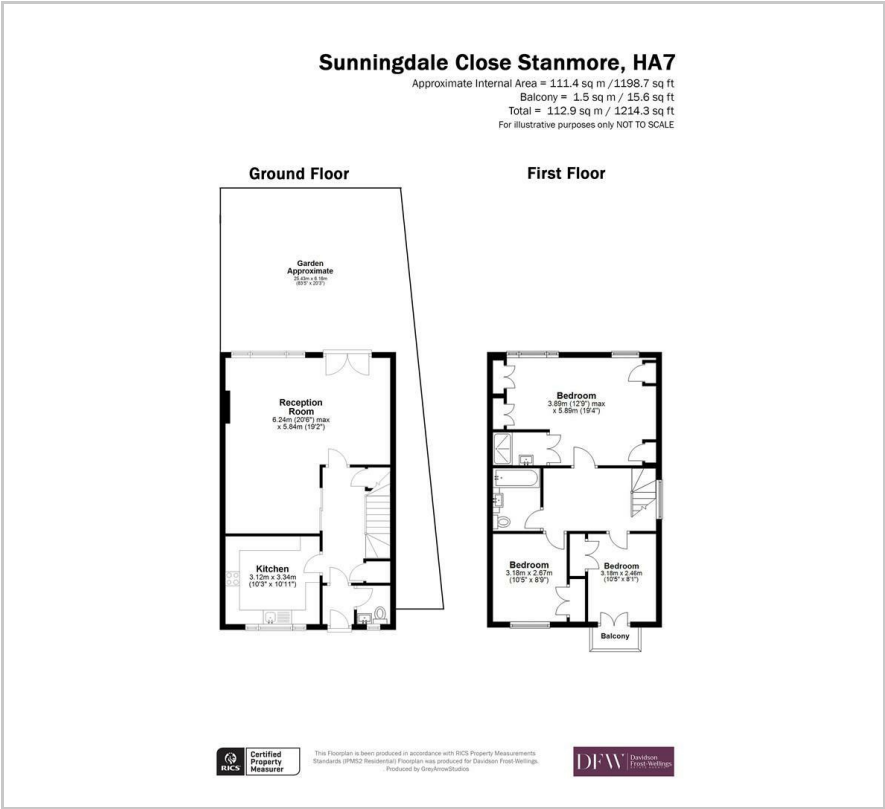

Area Map

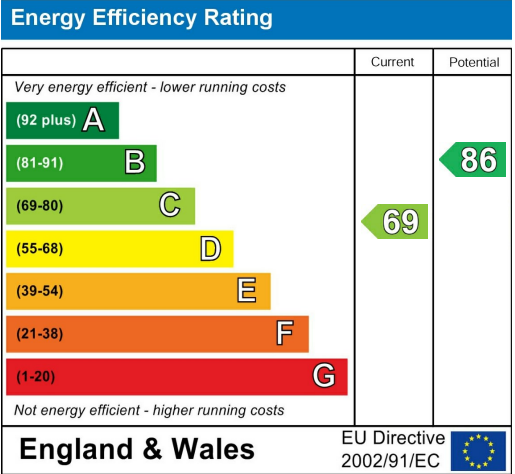

These particulars, whilst believed to be accurate are set out as a general outline only for guidance and do not constitute any part of an offer or contract. Intending purchasers should not rely on them as statements of representation of fact, but must satisfy themselves by inspection or otherwise as to their accuracy. No person in this firms employment has the authority to make or give any representation or warranty in respect of the property.