



## Coombe Close Edgware £1,800 Per month

A two bedroom, modern flat on the first floor of this recent house conversion.

The flat has a large open plan kitchen and reception room, a large master bedroom with bay window, an additional second bedroom and family bathroom. The flat has been recently converted and includes modern kitchen and bathrooms.

Available at the end of a no-through road, with views overlooking playing fields, and off-street parking.

Harrow Council Tax Band D.  
Deposit of £2076.92 at the asking price.

### Viewing

Please contact our Davidson Frost-Wellings Office on 020 8954 8806 if you wish to arrange a viewing appointment for this property or require further information.

- Two Bedrooms
- First Floor Flat
- Modern Kitchen and Bathroom
- Off Street Parking
- Part Furnished
- Available Immediately

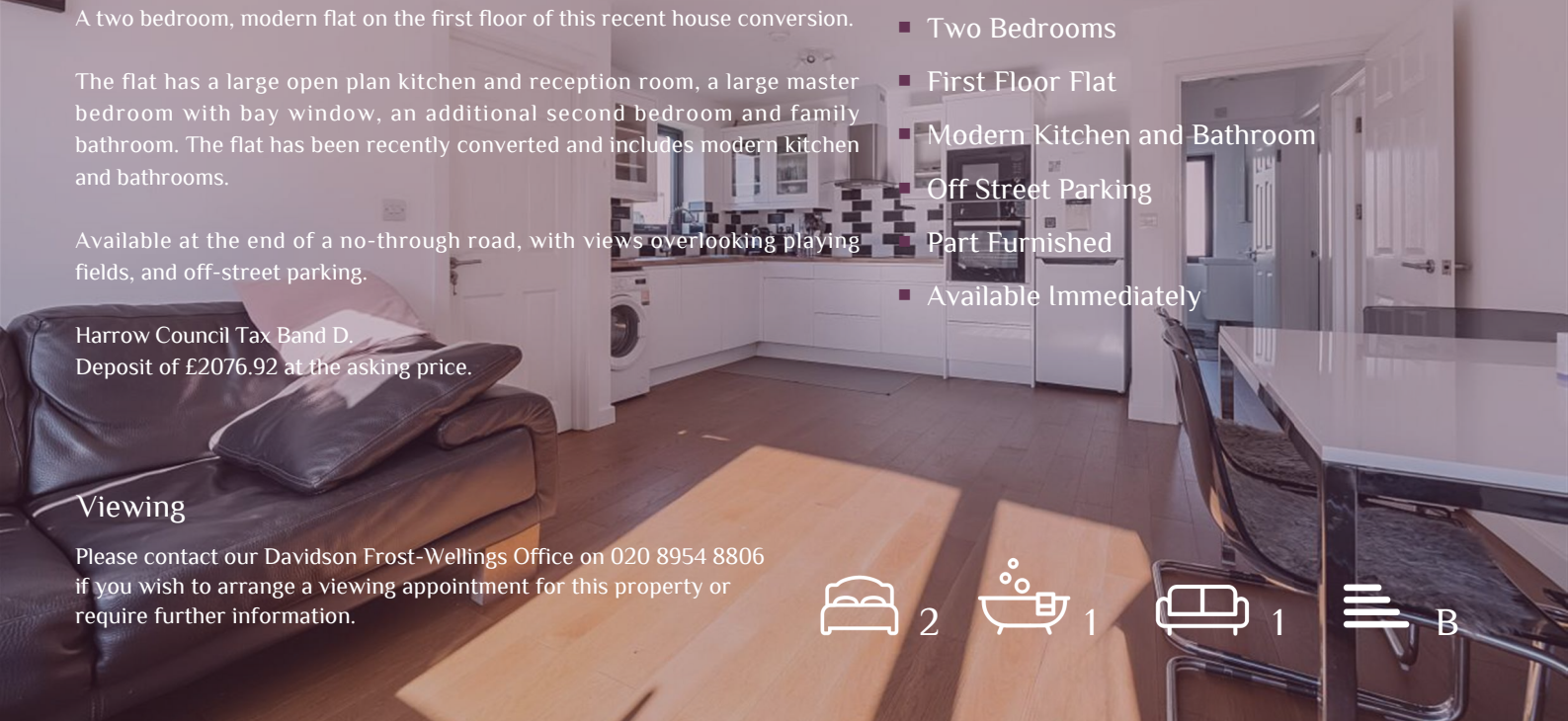

## Floor Plan

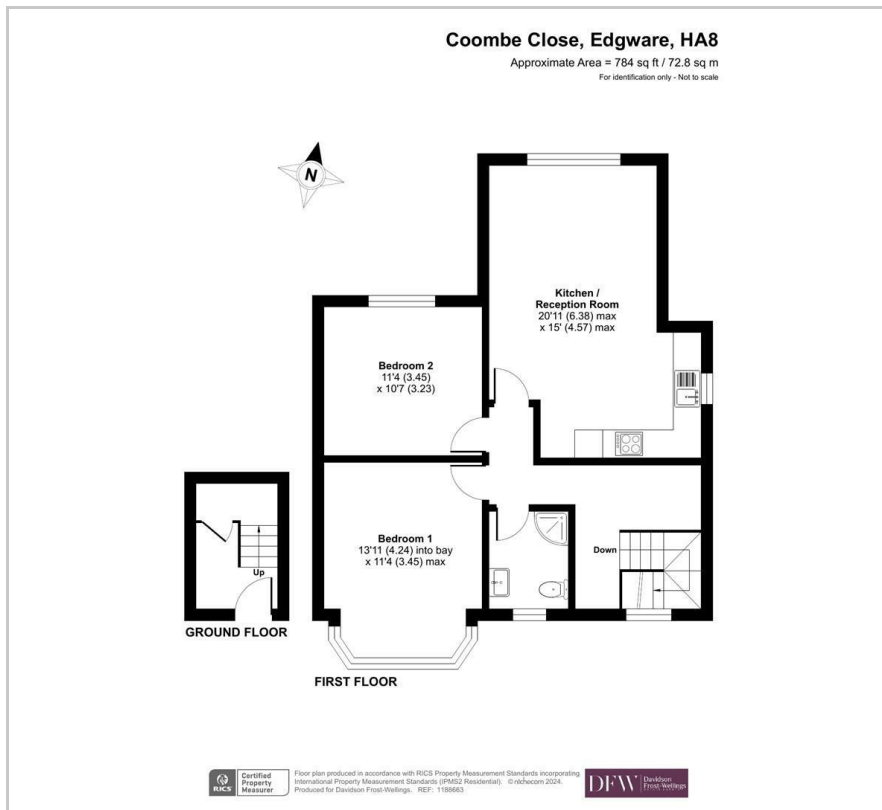

## Area Map

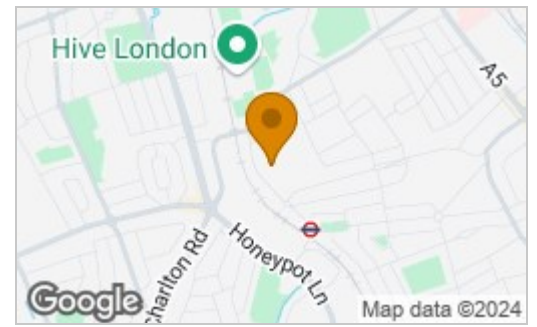

### Energy Efficiency Rating

	Current	Potential
Very energy efficient - lower running costs		
(92 plus) <b>A</b>		
(81-91) <b>B</b>	<b>81</b>	<b>82</b>
(69-80) <b>C</b>		
(55-68) <b>D</b>		
(39-54) <b>E</b>		
(21-38) <b>F</b>		
(1-20) <b>G</b>		
Not energy efficient - higher running costs		
<b>England &amp; Wales</b>	EU Directive 2002/91/EC	



These particulars, whilst believed to be accurate are set out as a general outline only for guidance and do not constitute any part of an offer or contract. Intending purchasers should not rely on them as statements of representation of fact, but must satisfy themselves by inspection or otherwise as to their accuracy. No person in this firm's employment has the authority to make or give any representation or warranty in respect of the property.