



Letchworth Road

Stanmore

£2,200 Per month

A two bedroom, one bathroom, ground floor flat available furnished, in a modern development minutes from Canons Park Station.

The flat has an open plan kitchen/living room, a private balcony, two large double bedrooms with wardrobes, a spacious family bathroom and built-in storage.

An allocated parking space is available with the flat.

Harrow Council Tax Band D.

Deposit of £2,538 based on the asking price.

Available from 9th August 2024.

Viewing

Please contact our Davidson Frost-Wellings Office on 020 8954 8806 if you wish to arrange a viewing appointment for this property or require further information.

- Two Bedrooms
- One Bathroom
- Modern Development
- Open Plan Kitchen
- Balcony
- Furnished



Floor Plan

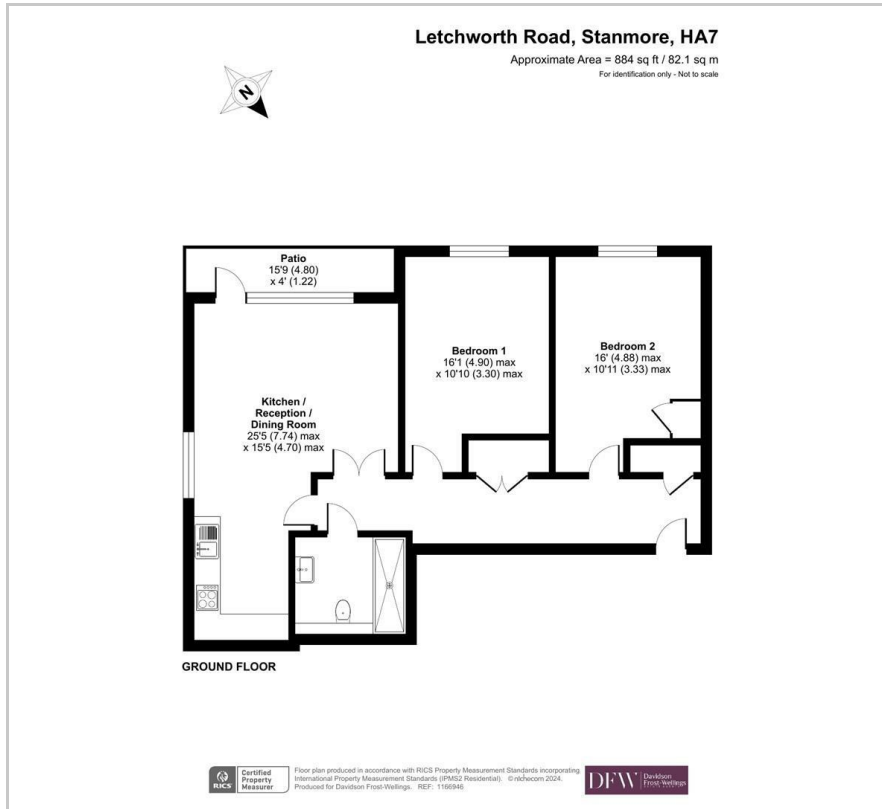

Area Map

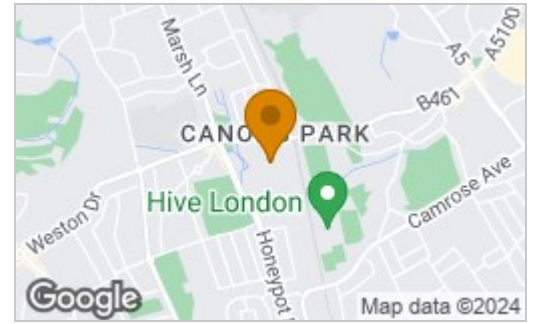

Energy Efficiency Rating		
	Current	Potential
Very energy efficient - lower running costs		
(92 plus) A		
(81-91) B	81	81
(69-80) C		
(55-68) D		
(39-54) E		
(21-38) F		
(1-20) G		
Not energy efficient - higher running costs		
England & Wales	EU Directive 2002/91/EC	



These particulars, whilst believed to be accurate are set out as a general outline only for guidance and do not constitute any part of an offer or contract. Intending purchasers should not rely on them as statements of representation of fact, but must satisfy themselves by inspection or otherwise as to their accuracy. No person in this firm's employment has the authority to make or give any representation or warranty in respect of the property.