



Grover Road

Watford

£465,000

This fantastic two bedroom, two bathroom terrace house offers spacious accommodation throughout. This property benefits from two reception rooms, separate kitchen, upstairs bathroom, private rear garden with an office, gas central heating and double glazing.

Situated walking distance from Bushey station you will find Pinner Road. Close to shops, schools, village bakery, coffee shops and road links this is the perfect commuter location. The green open space of Watford Heath and Attenborough fields are also literally on your doorstep.

Watford Council Tax Band D

Viewing

Please contact our Davidson Frost-Wellings Office on 020 8954 8806 if you wish to arrange a viewing appointment for this property or require further information.

- Two bedrooms
- Two bathrooms
- Private office space in the garden
- Superb condition
- Lots of natural light
- Walking distance to Bushey station



2



2



2



D

Floor Plan

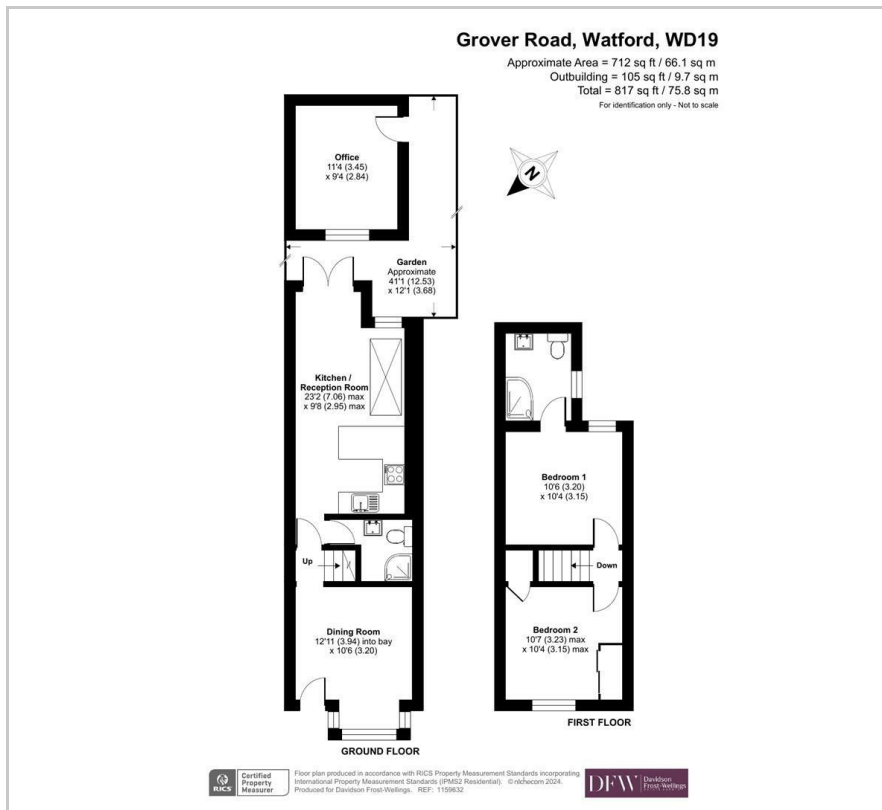

Area Map

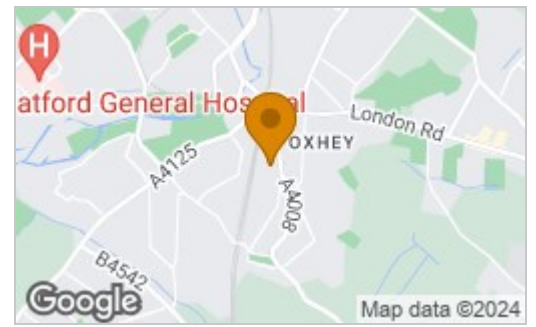

Energy Efficiency Rating

	Current	Potential
<i>Very energy efficient - lower running costs</i>		
(92 plus) A		
(81-91) B		80
(69-80) C		
(55-68) D	58	
(39-54) E		
(21-38) F		
(1-20) G		
<i>Not energy efficient - higher running costs</i>		
England & Wales	EU Directive 2002/91/EC	



These particulars, whilst believed to be accurate are set out as a general outline only for guidance and do not constitute any part of an offer or contract. Intending purchasers should not rely on them as statements of representation of fact, but must satisfy themselves by inspection or otherwise as to their accuracy. No person in this firm's employment has the authority to make or give any representation or warranty in respect of the property.