



## Cavendish Drive Edgware Offers over £1,500,000

A well proportioned, five bedroom detached house on an enviable corner plot on Cavendish Drive in the popular and sought after Canon's Park Estate, with access to its private seven acre lake.

The ground floor offers a huge reception room with triple aspect and doors leading to the garden. There is also a sizeable additional reception room with bay window and fully functional fireplace, as well as a separate dine-in farmhouse style kitchen. Further benefits downstairs include a welcome porch, a modern shower room and large understairs cupboard.

Upstairs on the first floor the house has a large master bedroom with ensuite bathroom and built in storage. There are four further double bedrooms, a family bathroom and a guest WC.

The house sits on a large corner plot, with a wide and bright rear garden, detached double garage and a large driveway suitable for multiple cars.

Harrow Council Tax Band G.

- Five Bedrooms
- Three Bathrooms
- Corner Plot
- Detached Double Garage
- Carriage Driveway
- Canons Park Estate

### Viewing

Please contact our Davidson Frost-Wellings Office on 020 8954 8806 if you wish to arrange a viewing appointment for this property or require further information.





Floor Plan

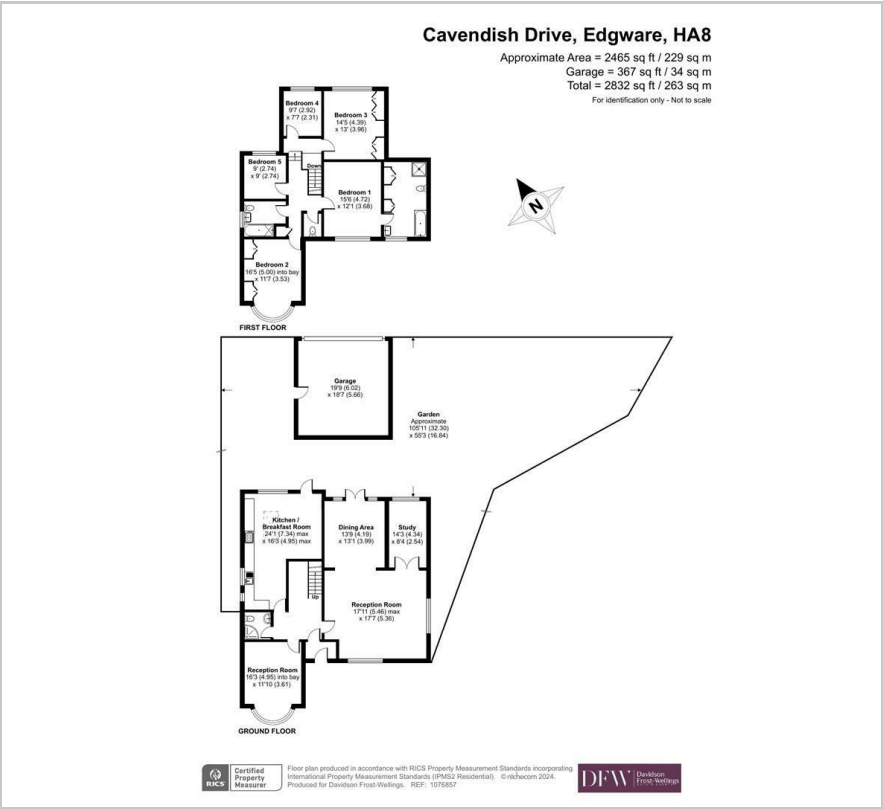

Area Map

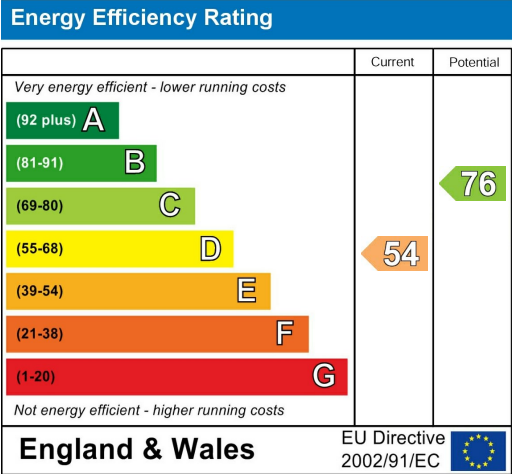
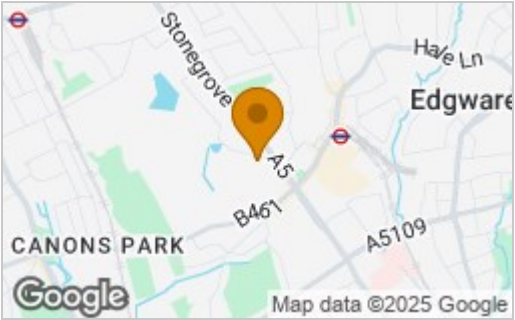

These particulars, whilst believed to be accurate are set out as a general outline only for guidance and do not constitute any part of an offer or contract. Intending purchasers should not rely on them as statements of representation of fact, but must satisfy themselves by inspection or otherwise as to their accuracy. No person in this firms employment has the authority to make or give any representation or warranty in respect of the property.