



 3
Bedrooms

 2
Bathrooms



***** DETACHED FAMILY HOME IN A PRIME LOCATION *****

Discover the epitome of family living in this captivating three-bedroom detached property. Located in a sought-after central area, it boasts a new resin driveway, upgraded rear garden with a glass car showroom, owned solar panels, gas heating, and potential loft conversion. Enjoy spacious interiors, modern amenities, and convenient access to schools and amenities. Don't miss out on this perfect blend of comfort and convenience—schedule a viewing today!

Experience the pinnacle of family living with this enchanting three-bedroom detached property, situated in a highly sought-after central residential enclave. Conveniently located within close proximity to the town center, this abode seamlessly combines accessibility with tranquility, presenting an ideal sanctuary for families yearning for both space and convenience.

Greeted by a brand new resin driveway that gracefully extends through to the carport, along with upgraded fencing to the extensive rear garden, this property sets a new standard of charm and functionality. Notably, it features a remarkable 6m x 3m glass car showroom with roller door access, and artificial lawn flooring, a testament to its commitment to modern living. Adding to its allure are the solar panels adorning both the front and rear of the roof, owned outright and generating revenue, alongside two storage batteries for sustainable energy consumption. Further enhancing its appeal are additional outbuildings, gas central heating for optimal comfort, and a loft space ripe for conversion, offering endless possibilities for expansion. Nestled amidst lush landscaped gardens, this home exudes serenity and seclusion, providing an idyllic backdrop for cherished family moments. Step inside to discover a thoughtfully designed interior, featuring three inviting bedrooms, including a generously sized third bedroom adaptable to your family's evolving needs. Two spacious double bedrooms offer cozy retreats for unwinding after a long day. The sleek high gloss fitted kitchen, equipped with integral appliances and polished quartz flooring, embodies modern elegance, while the bright and airy living area, flooded with natural light, sets the stage for memorable family gatherings. Luxurious amenities extend to the stylish fitted bathroom, complete with a gloss fronted vanity hand basin and an indulgent over bath shower, providing a spa-like experience within the comforts of home. Practical conveniences such as a rear walk-in pantry, ground floor WC, and a sizable utility room with ample storage space enhance everyday living. Benefiting from secure off-road parking, this residence ensures peace of mind for your vehicles. Nearby schools cater to your children's educational needs, while local amenities and green spaces offer endless opportunities for leisure and recreation. With effortless access to major shopping facilities and key motorway links including the M180, M18, and A1077, commuting becomes a breeze.

Don't miss this exceptional opportunity to embrace a lifestyle of comfort, convenience, and cherished family moments. Schedule a viewing today and transform this into your forever home.

Entrance Hall - 2.92m x 2.11m (9'7" x 6'11")

Lounge / Diner - 7.34m x 4.52m (24'1" x 14'10")

Kitchen - 4.32m x 2.71m (14'2" x 8'11")

Pantry - 1.54m x 0.72m (5'1" x 2'4")

Utility - 2.70m x 2.28m (8'10" x 7'6")

Master Bedroom - 4.07m x 3.38m (13'4" x 11'1")

Bedroom Two - 3.93m x 3.17m (12'11" x 10'5")

Bedroom Three - 2.73m x 2.70m (8'11" x 8'10")

Bathroom - 2.06m x 1.81m (6'9" x 5'11")

Entrance *2.92 x 2.11m*

Step into this inviting home through a glazed porch, adorned with uPVC double glazed windows and a front aspect door. The porch boasts ample lighting and solid flooring, setting the tone for the comfort within. Transition seamlessly into the main entrance hall through a second uPVC glazed door. Here, you'll find wood laminate flooring, a double radiator, and ceiling lighting, creating a warm and welcoming ambiance. The open space under the stairs offers versatility, while the carpeted stairs lead to the first floor. Convenient coat storage space adds practicality to this stylish entrance area.

Lounge & Diner *7.34m x 4.52m*

Enjoy the perfect blend of relaxation and entertainment in this spacious lounge/diner, offering comfort and style for your family gatherings. Bathed in natural light, the lounge welcomes you with a bay uPVC window, complemented by wood laminate flooring that exudes warmth and charm. A side aspect obscure glazed window adds privacy while maintaining brightness. The capped-off fireplace presents an opportunity for personalization, currently serving as open storage for a freestanding electric stove. Stay cozy with a double radiator and ample ceiling lighting enhancing the ambiance. Adjacent to the lounge, the dining area invites you to share meals and create memories. Featuring wood laminate flooring for easy maintenance, it offers a comfortable space for family dinners. Double radiator ensures warmth during colder months, while uPVC French doors open to the rear garden, seamlessly blending indoor and outdoor living. Enjoy the versatility of this well-lit space, perfect for hosting gatherings or enjoying quiet family meals.

Kitchen *4.32m x 2.71m*

Prepare culinary delights in style within this modern fitted kitchen. Adorned with white gloss fronted wall and base units, it offers both functionality and aesthetic appeal. The kitchen is equipped with an integral induction hob, electric oven, and extractor fan light unit, ensuring seamless cooking experiences. Tiled walls and polished quartz flooring add a touch of elegance to the space, while the breakfast bar with laminate worktop provides a cozy spot for casual dining. A stainless steel sink and drainer enhance both practicality and visual appeal. Ample lighting illuminates the kitchen, complemented by a double radiator for added comfort. There's plenty of space for an American-style fridge freezer, catering to all your storage needs with ease.

Utility *2.70m x 2.28m*

Step into practicality with the rear aspect porch, offering seamless access to utility rooms and the ground floor WC, as well as a convenient pathway to the rear garden through a uPVC glazed door. Discover practicality and functionality in this expansive utility room, designed to streamline household chores and storage needs with ease. Featuring a generous layout, this utility room offers plenty of room to maneuver and organize. A side aspect uPVC window floods the space with natural light, creating a bright and inviting atmosphere. Wall-mounted lighting ensures visibility, even during evening tasks, while plumbing for white goods allows for convenient installation of laundry appliances. Base units provide essential storage for housing white goods, keeping your utility room tidy and organized. A laminate worktop offers a versatile surface for folding laundry, sorting supplies, or even serving as a temporary workspace for household projects. Enjoy comfort underfoot with carpet flooring, providing a soft and cozy feel as you go about your daily tasks. With its combination of practical features and stylish design elements, this large utility room enhances the functionality and efficiency of your home, making it a valuable asset for busy households.

WC

Equipped with a close coupled toilet, this WC provides essential functionality for your daily needs. The compact design maximizes space while offering convenience for guests and household members alike.

Pantry *1.54m x 0.72m*

Wood-fronted wall-fixed storage units provide ample room for organizing pantry essentials with ease. From dry goods to kitchen gadgets, you'll find plenty of space to keep everything neatly arranged and within reach. The laminate worktop offers a smooth surface for meal prep or displaying your favorite kitchen decor.

Master bedroom *4.07m x 3.38m*

Discover comfort and versatility in this inviting master bedroom, offering ample space and natural light for your enjoyment. Dual aspect uPVC double glazed windows

flood the room with natural light, creating a bright and welcoming atmosphere. Laminate flooring adds a touch of elegance to the room while providing durability and easy maintenance. Stay cozy and comfortable year-round with a double radiator providing warmth during cooler months. Whether you're curling up with a book or unwinding after a long day, this bedroom ensures your comfort is always a priority. The abundance of natural light, combined with the light to ceiling, enhances the sense of space and openness in the room, creating a relaxing environment that promotes rest and rejuvenation.

Bedroom two *3.93m x 3.17m*

Escape to comfort and tranquility in this spacious double bedroom, thoughtfully designed to provide a serene sanctuary for rest and relaxation. Enjoy ample space to unwind and recharge in this generously sized master bedroom. Laminate flooring adds a touch of warmth and elegance, enhancing the overall ambiance of the room. A convenient integral single wardrobe offers plenty of storage space for your clothing and personal belongings, keeping your bedroom neat and organized. Say goodbye to clutter and hello to streamlined living. Stay cozy year-round with a double radiator providing warmth during cooler months. A front aspect uPVC window welcomes natural light into the room, creating a bright and airy atmosphere that promotes relaxation. From the practical storage solutions to the inviting ambiance, every detail of this master bedroom has been carefully considered to ensure your comfort and satisfaction. Experience the epitome of relaxation in your own private retreat.

Bedroom three *2.73m x 2.70m*

Find comfort and versatility in this charming third small double bedroom, offering a cozy haven for relaxation and rest. Despite its compact size, this bedroom maximizes space and functionality, providing a comfortable retreat for a variety of purposes. Laminate flooring adds a touch of sophistication while ensuring durability and easy maintenance. Stay cozy year-round with a double radiator providing warmth during cooler months. Whether you're unwinding after a long day or enjoying a peaceful night's sleep, this bedroom ensures your comfort is always a priority. A rear aspect uPVC double glazed window welcomes natural light into the room, creating a bright and airy ambiance that promotes relaxation. Enjoy the beauty of the outdoors from the comfort of your own private sanctuary. With light to ceiling illuminating the space, this bedroom offers a well-lit environment for reading, studying, or simply enjoying quiet moments of solitude. Whether used as a guest room, home office, or personal retreat, this cozy third bedroom offers endless possibilities for customization and enjoyment. Embrace the opportunity to create a space that reflects your unique style and preferences.

Bathroom *2.06m x 1.81m*

Indulge in relaxation and luxury within this modern bathroom suite, meticulously designed to elevate your bathing experience. The centerpiece of the bathroom is the side and end panel bath, complete with a sleek glazed shower screen for added convenience and style. Enjoy the indulgence of an over bath mains connected waterfall shower, providing a rejuvenating cascade of water to wash away the stresses of the day. A vanity hand basin unit offers ample storage space for your toiletries, keeping the bathroom clutter-free and organized. The close coupled toilet complements the suite's modern aesthetic while providing essential functionality. A chrome towel radiator adds a touch of elegance while ensuring your towels are warm and ready for use. A front aspect obscure glazed window floods the space with natural light, creating a bright and inviting atmosphere. Tiled walls provide a sleek backdrop for the bathroom suite, while vinyl flooring offers durability and easy maintenance, perfect for withstanding the demands of daily use. With its blend of modern fixtures, stylish accents, and practical finishes, this bathroom suite offers the ultimate retreat for relaxation and rejuvenation, transforming your daily routine into a luxurious spa-like experience.

External

Indulge in luxury as you enter through a recently upgraded resin driveway, extending seamlessly to the carport and rear garden. This transformation offers not just practicality but a touch of sophistication to your home. Multiple vehicles find ample parking space on this elegant driveway, ensuring convenience for you and your guests. A sheltered carport on the side aspect provides protection from the elements, while secure gated access to the rear garden enhances security and peace of mind. The walled perimeter to the front elevation ensures privacy and adds to the overall sense of security. Escape to your own private paradise in the expansive rear gardens, meticulously landscaped to provide a haven of tranquility and leisure. These gardens are divided into distinct sections, catering to every aspect of outdoor living. Ideal for hosting outdoor gatherings or simply lounging in the sun, the large shingle patio provides the perfect setting for al-fresco dining and relaxation. Enjoy the freedom of space in the sprawling manicured lawn, where children can play freely and outdoor activities abound. Surround yourself with the beauty of nature in the meticulously maintained herbaceous borders and hedgerows, which add color and texture to the landscape year-round. Unleash your creativity or nurture your green thumb in the spacious workshop and greenhouse, offering ample storage and workspace for DIY projects and gardening endeavors. Additionally, a glass car showroom with roller door access adds a touch of luxury and practicality to this outdoor oasis, providing secure storage for your prized vehicles while showcasing them

in style.

Disclaimer

Louise Oliver Properties Limited themselves and for the vendors or lessors of this property whose agents they are, give notice that the particulars are set out as a general outline only for the guidance of intending purchasers or lessors, and do not constitute part of an offer or contract; all descriptions, dimensions, references to condition and necessary permission for use and occupation, and other details are given without responsibility and any intending purchasers or tenants should not rely on them as statements or presentations of fact but must satisfy themselves by inspection or otherwise as to the correctness of each of them. Room sizes are given on a gross basis, excluding chimney breasts, pillars, cupboards, etc. and should not be relied upon for carpets and furnishings. We have not carried out a detailed survey and/or tested services, appliances, and specific fittings. No person in the employment of Louise Oliver Properties Limited has any authority to make or give any representation of warranty whatever in relation to this property and it is suggested that prospective purchasers walk the land and boundaries of the property, prior to exchange of contracts, to satisfy themselves as to the exact area of land they are purchasing.

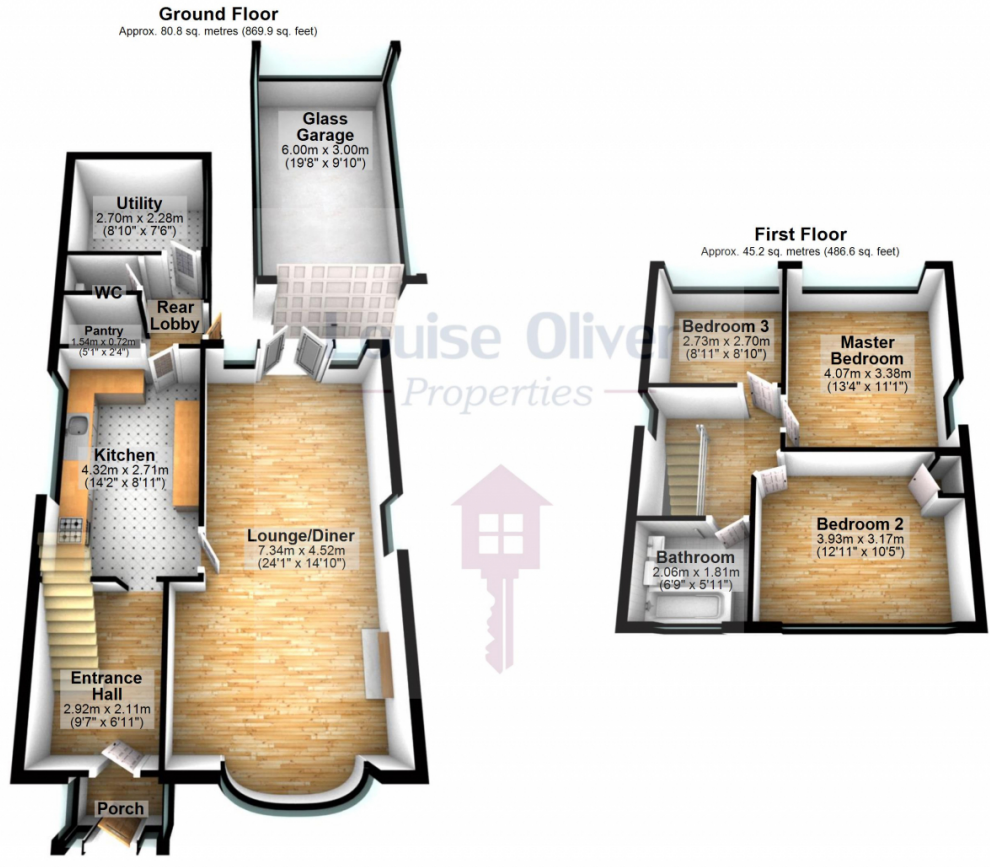

Total area: approx. 126.0 sq. metres (1356.5 sq. feet)
Buckingham Avenue

Energy Efficiency Rating		Current	Potential
Very energy efficient - lower running costs			
(92+)	A		97
(81-91)	B	81	
(69-80)	C		
(55-68)	D		
(39-54)	E		
(21-38)	F		
(1-20)	G		
Not energy efficient - higher running costs			
England, Scotland & Wales		EU Directive 2002/91/EC	

Address: Buckingham Avenue, DN15

