



Longfield Street, SW18

£375,000

A stunning and newly developed one double bedroom apartment with an immaculate interior finished with a stylish open-plan kitchen/reception room with fitted appliances, a comfortable seating and dining area, a large double bedroom and a three piece family bathroom. The property is sold with a new lease, with zero Ground Rent and low outgoings.

Longfield Street is conveniently located for the many shops, bars and amenities of Southfield with Earlsfield town centre only moments walk away. Southfields Underground Stations is a stone's throw away with bus links also on the doorstep.

Features

- Brand New Conversion
- Luxury One Bedroom Apartment
- Open-Plan Kitchen/Reception
- Stamp Duty Paid for First Time Buyers
- Desirable Location
- Chain Free

Longfield Street, LONDON, SW18

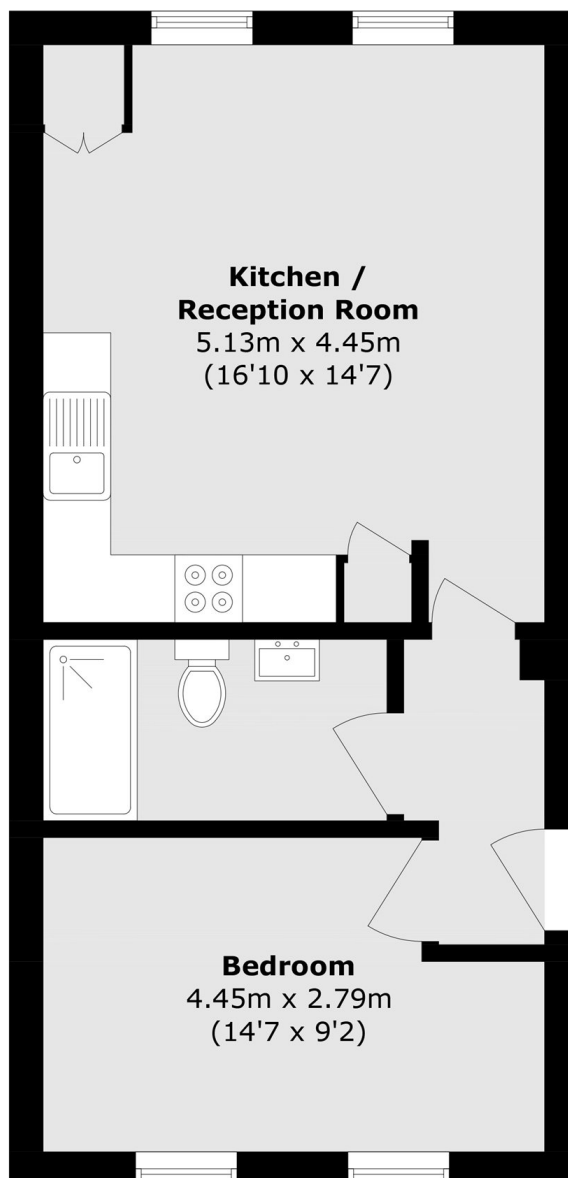

Total area (approx.): 43.7 sq. m (470.3 sq. ft)