



Kellino Street, SW17

£450,000

A larger than average two double bedroom ground floor garden flat with huge potential for extending and alterations (STPP) for any incoming purchaser. With a generous footprint, the property offers two double bedrooms, an open plan kitchen/reception room and a private garden positioned in the heart of Tooting.

Kellino Street is conveniently located for the vibrant bars, restaurants and boutiques of central Tooting with the excellent transport links of Tooting Broadway Underground station also nearby.

Features

- Two Double Bedrooms
- Chain Free
- Potential to Extend (STPP)
- Generous Proportions
- Desirable Location
- Private Garden

Kellino Street, London, SW17

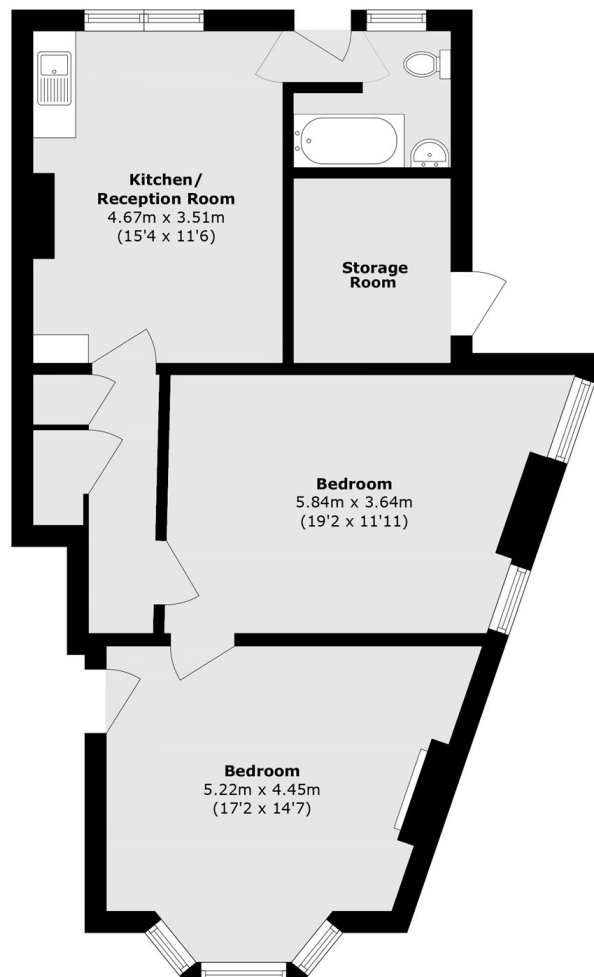

Total area (approx.): 65.4 sq. m (703.9 sq. ft)
Eternal Storage area (approx.): 5.7 sq. m (61.4 sq. ft)