



## Ashbourne Road, CR4

### £399,950

A beautifully arranged two double bedroom ground floor maisonette with accommodation that spans over 600 sqft of living space. This property benefits from two double bedrooms, family bathroom, separate kitchen to open plan reception/dining room and a generous south facing private garden. The property is also being offered chain free.

Ashbourne Road is a quiet tree lined residential street moments away from the green open spaces of Figges Marsh and the vast array of shops, bars and restaurants of Tooting nearby - including the popular Tooting Market. Easy access to the City can be found via Tooting station & Tooting Broadway underground.

### Features

- Two Bedrooms
- Ground Floor Flat
- Private Garden
- Own Front Door
- Chain Free
- Desirable Location

# Ashbourne Road, Mitcham, CR4

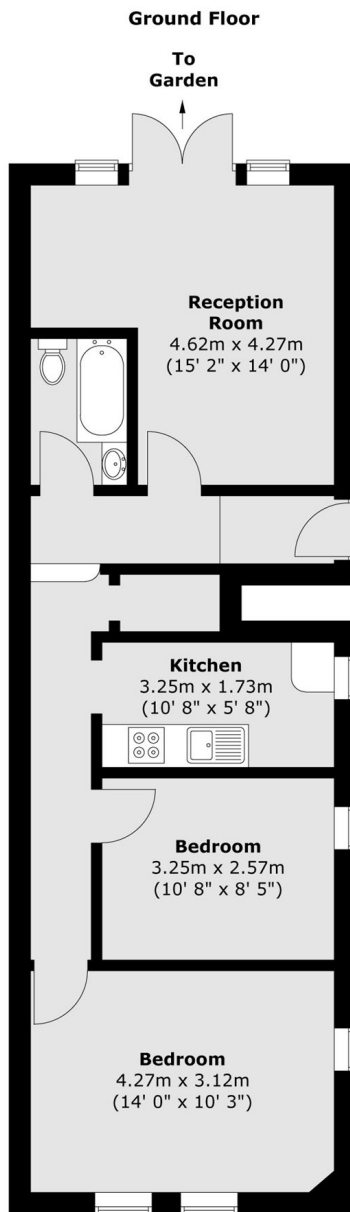

Total area (approx.) : 58.6 sq. m (631 sq. ft)