



Idlecombe Road, SW17

£450,000

An impressive larger than average three double bedroom ground floor maisonette. The property retains three bedrooms, a spacious reception room, separate kitchen and private garden. The property requires a quick transaction and is suitable for cash buyers, investors or chain free purchasers.

Idlecombe Road is a quiet tree lined residential street nestled between the borders of Furzedown and central Tooting with easy access to shops, bars and restaurants locally. The transport links of Tooting Broadway Underground and Tooting Railway Stations are a stone throws away.

Features

- Three Double Bedroom
- Chain Free
- Private Garden
- Own Front Door
- Furzedown Village
- Quick Transaction Needed

Idlecombe Road, London, SW17

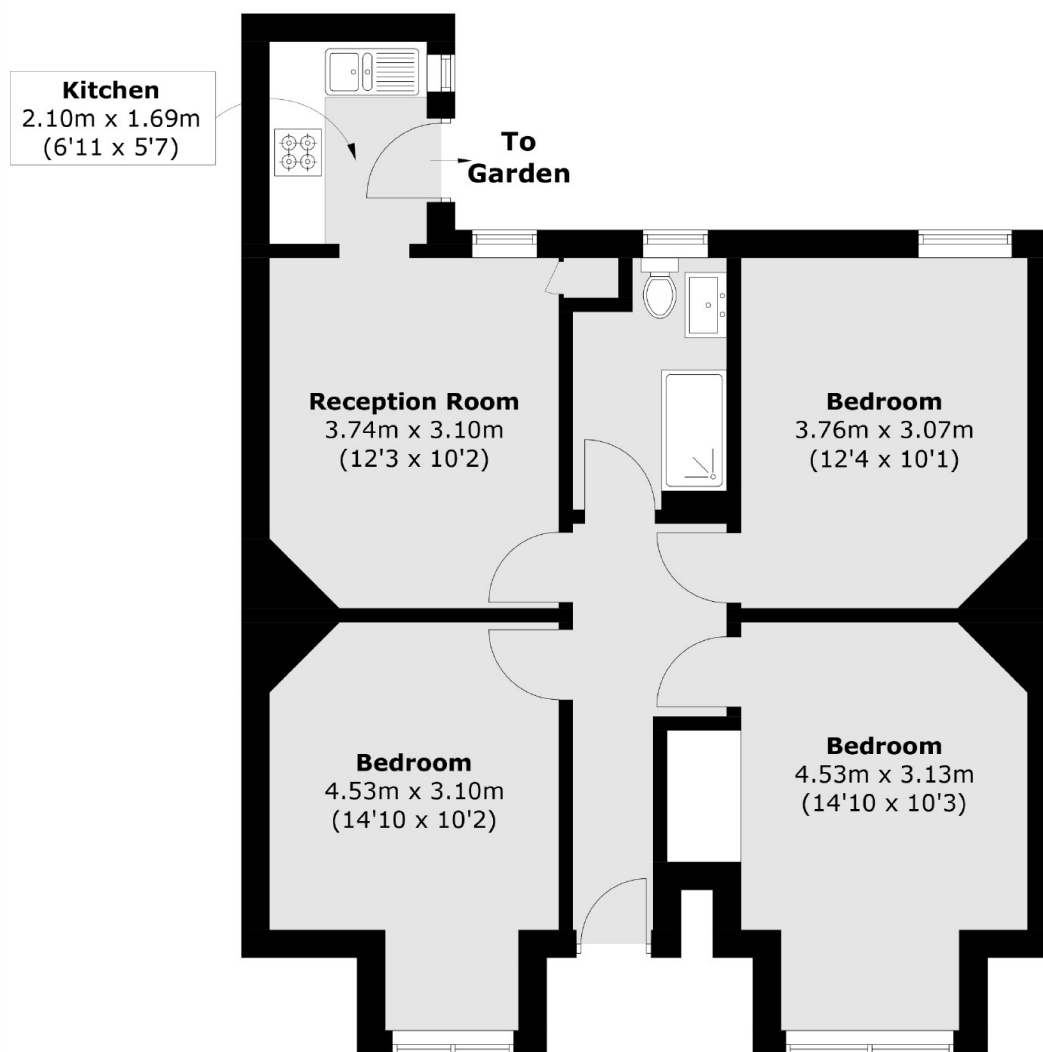

Total area (approx.): 65.6 sq. m (706.1 sq. ft)