



Alston Road, SW17

£880,000

A beautiful and immaculately presented end of terrace freehold home offering a generous footprint spanning over three floors with a superb open-plan kitchen/dining room, a front reception room, three generous double bedrooms, two bathrooms and a large private garden.

Alston Road is situated within a popular grid of residential roads providing easy access to the desirable shops, bars and restaurants of Tooting and Earlsfield town centres. The excellent transports links of Tooting Broadway Tube are only a short walk away alongside Earlsfield Railway Station and multiple bus routes. The vast green spaces of Wimbledon and Tooting Common are also close by.

Features

- Three Double Bedrooms
- Two Bathrooms
- Large Garden
- Open Plan Kitchen/Dining
- Superb Condition
- End Of Terrace
- Desirable Location



Alston Road, SW17

With an inviting and well arranged layout, the property opens onto a stylish front reception room furnished with bespoke cabinetry and a comfortable seating area. The heart of the home lies to the rear with a superb kitchen/dining/living space offering ample wall and base units, a kitchen island, solid worktops and integrated appliances, alongside a large dining space and casual seating area with bi-folding doors opening onto a lawned garden with two patio areas.

The first and second floor comprises of three double bedrooms, two bathrooms and additional eaves storage, with the principal bedroom benefitting from a stylish en-suite and Juliette balcony.



Alston Road, London, SW17

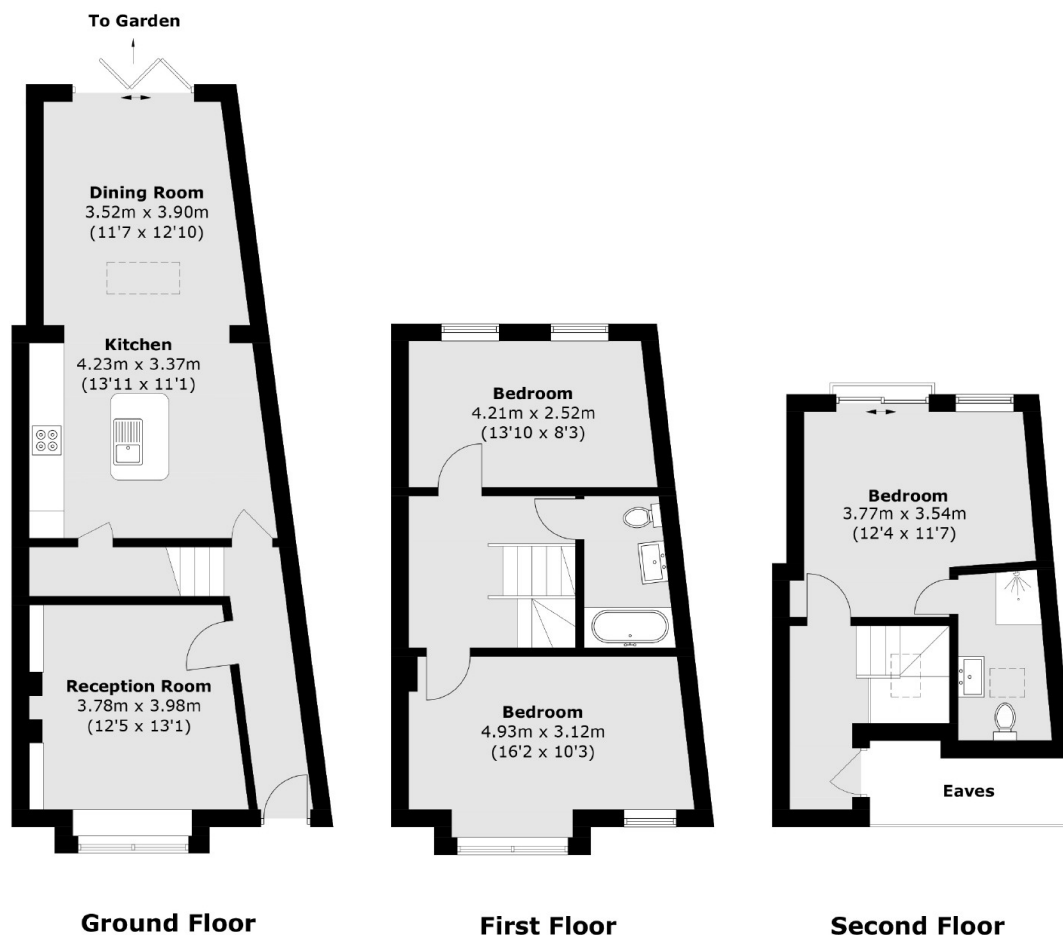

Total area (approx.): 111.9 sq. m (1,204.5 sq. ft)
(Excluding Eaves)

Dexters

Tooting
48 Tooting High Street
London
SW17 0RG
Sales
020 8545 8582

Energy Rating: C. We aim to make our particulars both accurate and reliable. However they are not guaranteed; nor do they form part of an offer or contract. If you require clarification on any points then please contact us, especially if you're traveling some distance to view. Please note that appliances and heating systems have not been tested and therefore no warranties can be given as to their good working order.

 **RICS** | Regulated
Estate Agent
and Letting Agent

[dexters.co.uk](https://www.dexters.co.uk)