

Derinton Road, SW17

£525,000

A charming freehold home in the highly sought after Totterdown Conservation Area with a footprint that spans over two floors and opens onto a front reception room furnished with a comfortable seating and dining area with a stylish fitted kitchen at the rear. The property benefits from two generous double bedrooms, a three piece family bathroom and a spacious rear garden.

Derinton Road is situated close to many local shops, bars and restaurants as well as the green spaces of both Wandsworth and Tooting Bec Commons. Tooting Broadway and Bec Underground stations are also a stones throw away.

Features

- Two Double Bedrooms
- Chain Free
- Totterdown Conservation Area
- Blank Canvas
- South Facing Garden
- Freehold Home

Derinton Road, London, SW17

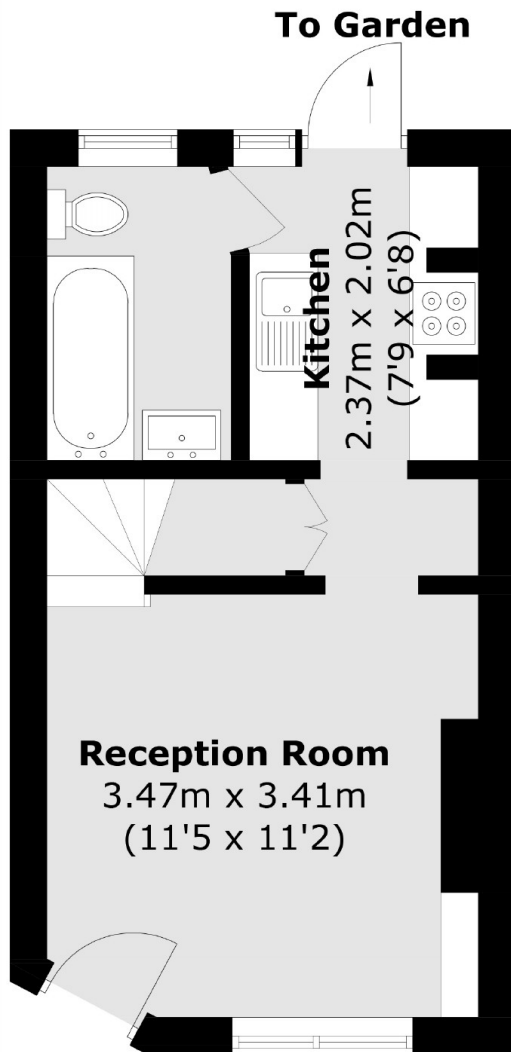

Ground Floor

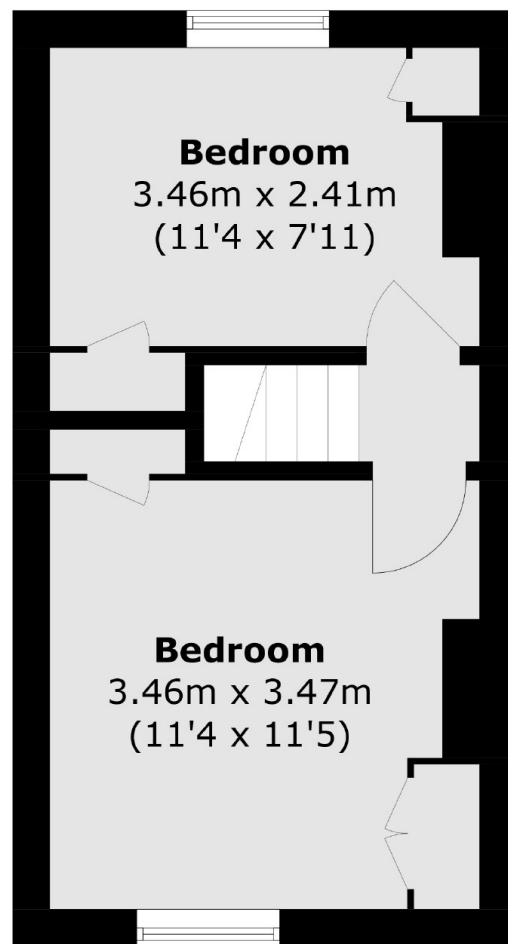

First Floor

Total area (approx.): 47.8 sq. m (514.5 sq. ft)