



Foss Road, SW17

£600,000

OFFERS IN EXCESS OF

A charming and lovingly maintained three double bedroom freehold home in wonderful condition throughout with a footprint that comprises a spacious open-plan living/dining room with an integral stylish fitted kitchen furnished with underfloor heating, three bedrooms, a downstairs w/c, a three piece family bathroom and a large rear garden with an outbuilding.

Foss Road is a quiet residential road located moments away from the fantastic amenities of Tooting and Earlsfield town centres with their excellent transport links also within walking distance.

Features

OFFERS IN EXCESS OF

- Three Bedrooms
- Private Garden
- Large Kitchen/Living Space
- Wonderful Interior
- Convenient Location
- Outbuilding/Shed

Foss Road, London, SW17

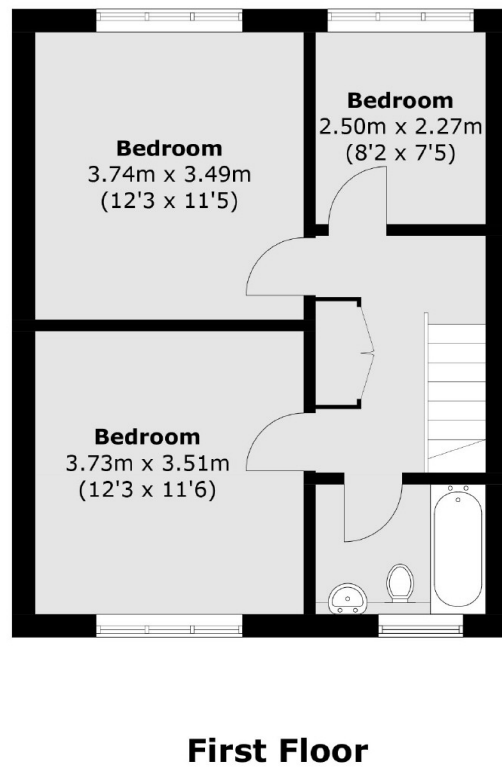
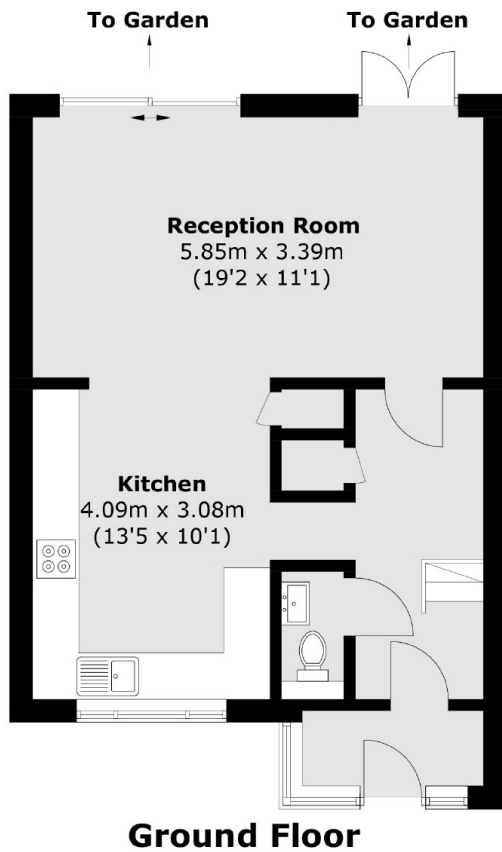

Total area (approx.): 91.9 sq. m (989.2 sq. ft)