



## Henry Doulton Drive, SW17

### £350,000

A charming and beautifully presented one double bedroom apartment in great condition throughout in the highly sought after Heritage Park Development. The property retains a generous reception room, a stylish kitchen and three piece family bathroom with off-street parking.

Henry Doulton Drive represents a close knit community of exclusive homes nestled away by Tooting Bec Common, with the vast amenities of Balham and Tooting town centres only a short walk away. Excellent transport links can be found via Tooting Bec Underground station.

### Features

- Heritage Park
- Spacious Double Bedroom
- x2 Parking Spaces
- Communal Grounds
- Share of Freehold
- Stylish Apartment

# Henry Doulton Drive, London, SW17

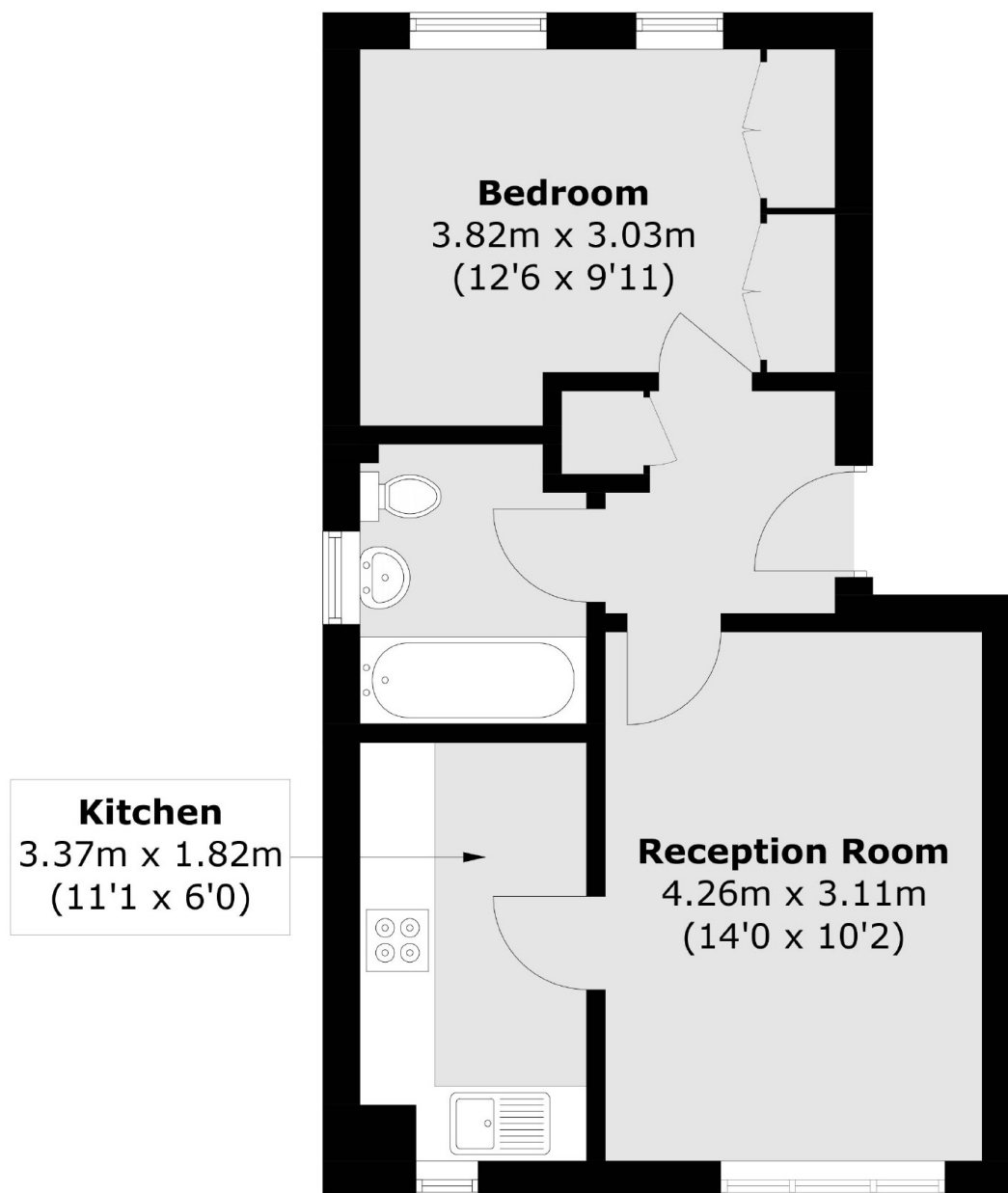

Total area (approx.): 39.3 sq. m (423.0 sq. ft)