



Henry Doulton Drive, SW17

£285,000

A charming and well maintained one double bedroom apartment in Heritage Park with a generous front reception room, a stylish newly refurbished kitchen and a large double bedroom with a three piece bathroom. The property also retains a healthy lease and two parking spaces.

Henry Doulton Drive represents a close knit community of exclusive homes nestled away by Tooting Bec Common, with the vast amenities of Balham and Tooting town centres only a short walk away. Excellent transport links can be found via Tooting Bec Underground station.

Features

- One Double Bedroom
- Newly Fitted Kitchen
- Large Reception Room
- x2 Parking Spaces
- Heritage Park
- Tooting Bec Common

Henry Doulton Drive, London, SW17

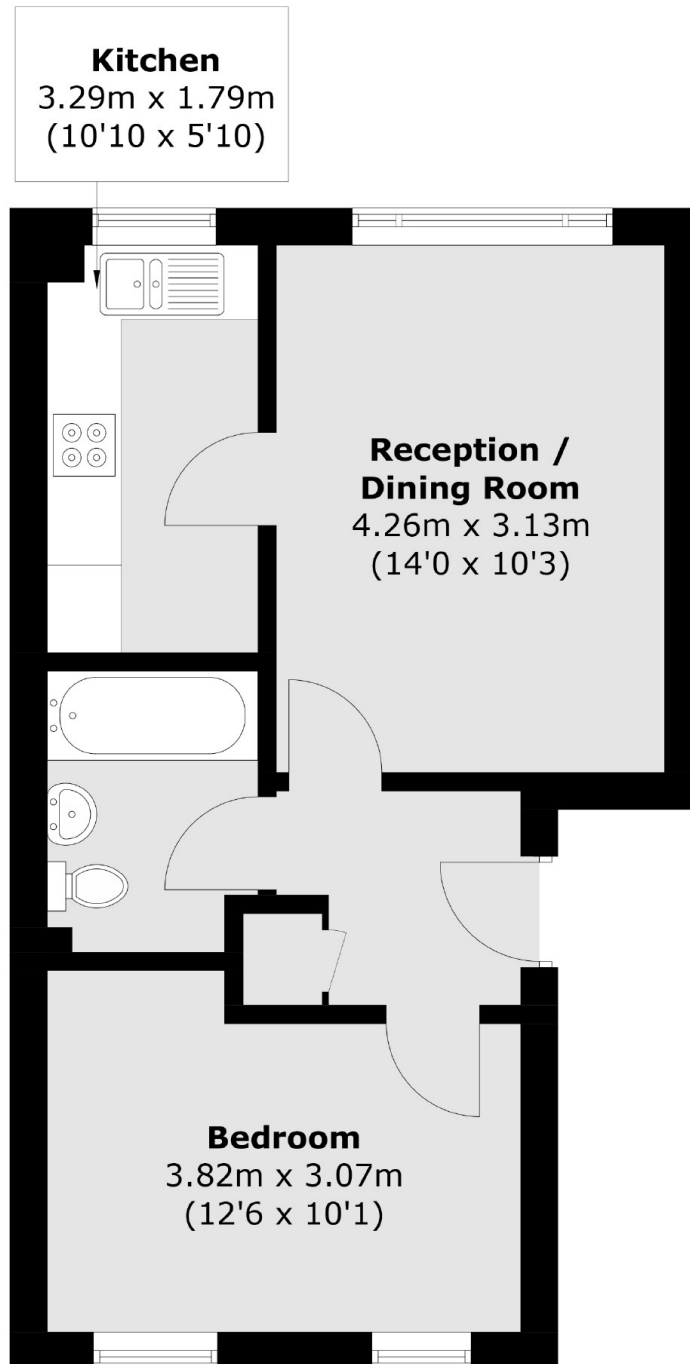

Total area (approx.): 38.6 sq. m (415.5 sq. ft)

Dexters

Tooting
48 Tooting High Street
London
SW17 0RG
Sales
020 8545 8582

Energy Rating: . We aim to make our particulars both accurate and reliable. However they are not guaranteed; nor do they form part of an offer or contract. If you require clarification on any points then please contact us, especially if you're traveling some distance to view. Please note that appliances and heating systems have not been tested and therefore no warranties can be given as to their good working order.

 **RICS** | Regulated
Estate Agent
and Letting Agent

[dexters.co.uk](https://www.dexters.co.uk)