



Coverton Road, SW17

£2,150 Per calendar month

A charming apartment set over the first floor of this Victorian building extending to just under 700 sqft. The property retains a spacious reception room with ample space for dining, a separate kitchen, two double bedrooms, a three piece bathroom and a private south facing garden.

Coverton Road is perfectly positioned for Tooting's eclectic mix of restaurants, bars and shops. Tooting Broadway Underground station is minutes walk away, providing frequent links to the City and West End via the Northern Line.

Features

- First Floor Apartment
- Two Double Bedrooms
- Large Reception Room
- Private Garden
- Recently Redecorated
- Tooting Broadway

Coverton Road, London, SW17

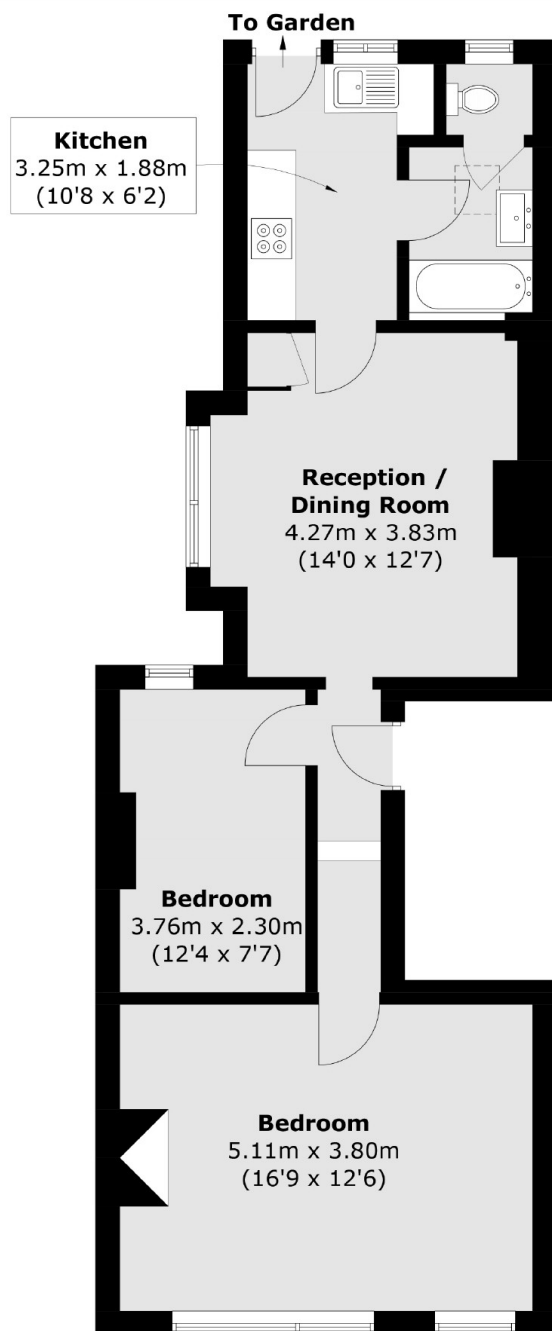

Total area (approx.): 60.3 sq. m (649.0 sq. ft)