



## Courtney Road, SW19

### £400,000

A stunning example of a charming ground floor maisonette holding a prominent position in the heart of Colliers Wood. The property comprises of two generous double bedrooms, a three piece family bathroom, an open plan kitchen/reception room and a south facing rear garden.

Courtney Road represents a close knit community of homes with excellent proximity to amenities of Colliers Wood High Street and within catchment of Singlegate Primary School. Colliers Wood Underground station & Recreation Ground are also nearby alongside the green open spaces of Wandle Park.

### Features

- Two Double Bedrooms
- South Facing Garden
- Family Bathroom
- Desirable Location
- Open Plan Kitchen/Reception Room
- Close to Local Amenities

# Courtney Road, London, SW19

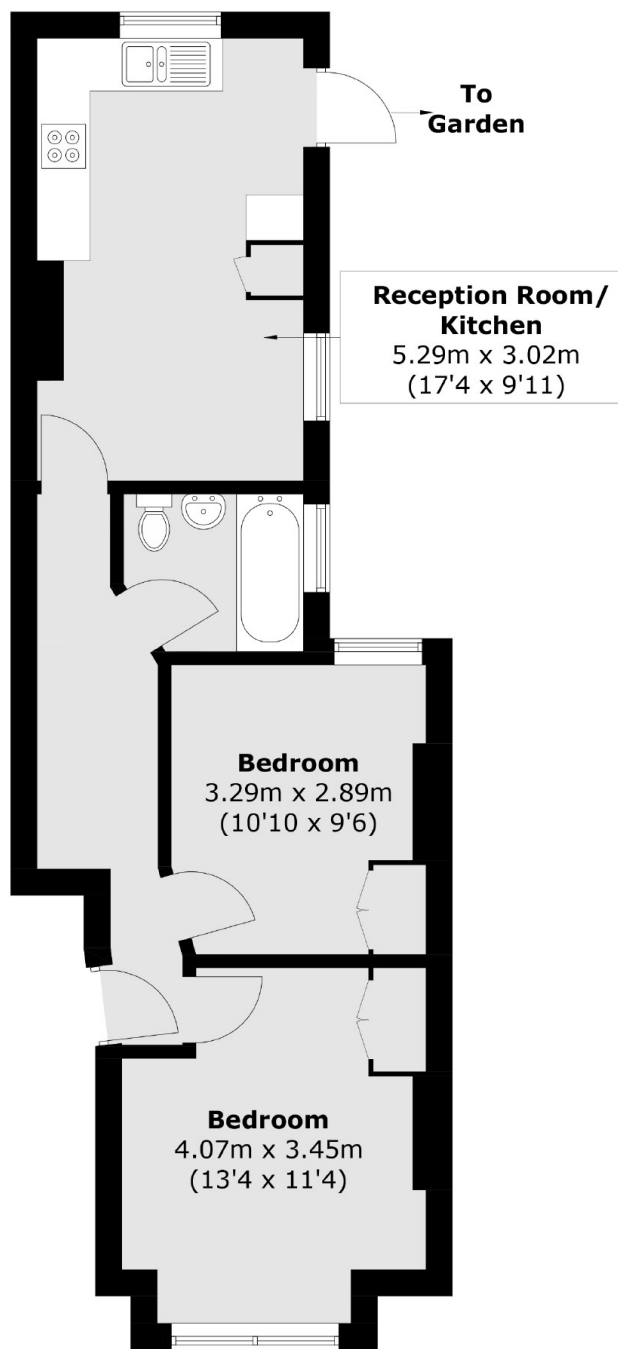

## Ground Floor

Total area (approx.): 49.2 sq. m (529.6 sq. ft)