



Coverton Road, SW17

£525,000

A charming and rarely available first floor apartment set over the first floor of this handsome Victorian building extending to just under 700 sqft. The property retains a spacious reception room with ample space for dining, a separate kitchen, two double bedrooms, a three piece bathroom and a private south facing garden.

Coverton Road is perfectly positioned for Tooting's eclectic mix of restaurants, bars and shops. Tooting Broadway Underground station is minutes walk away, providing frequent links to the City and West End via the Northern Line.

Features

- Two Double Bedrooms
- First Floor Apartment
- South Facing Garden
- Large Reception Room
- Share of Freehold
- Chain Free

Coverton Road, London, SW17

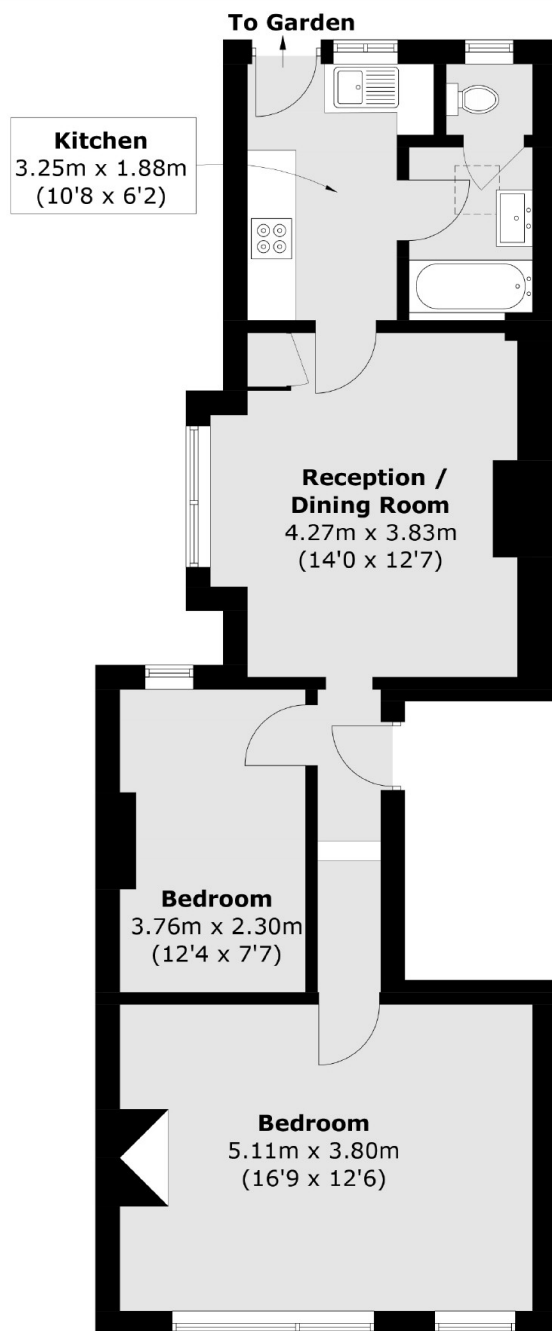

Total area (approx.): 60.3 sq. m (649.0 sq. ft)