



Brightwell Crescent, SW17

£775,000

A truly exquisite and exceptional split level apartment set over the first and top floors of this handsome Victorian building positioned on one of the most desirable roads in central Tooting with three double bedrooms and a unrivalled garden.

Brightwell Crescent is a quiet, leafy and highly sought after residential street perfectly positioned for Tooting Broadway Station and the vast shops, bars and restaurants Tooting has to offer on the doorstep. Tooting Railway station is also within walking distance.

Features

- Three Double Bedrooms
- Two Bathrooms
- Beautiful Condition
- Superb Garden
- Split Level
- Desirable Location=



Brightwell Crescent, SW17

Opening onto a spacious and bright stylish fitted kitchen, there is ample worktop space with a variety of wall and base units, integrated appliances and a comfortable dining area with direct access onto a superb, mature and beautifully landscaped rear garden. The first floor is further balanced with a stylish family bathroom, a spacious double bedroom with bespoke cabinetry and a fireplace and a stunning 16 sqft front reception room beautifully complimented with plantation shutters, original solid wooden floors, bespoke cabinetry and a fireplace.

Over the top floor, there are two spacious double bedrooms and three piece bathroom with a free-standing bath. The principal bedroom is wonderfully balanced with built-in wardrobes and a large footprint.



Brightwell Crescent, London, SW17

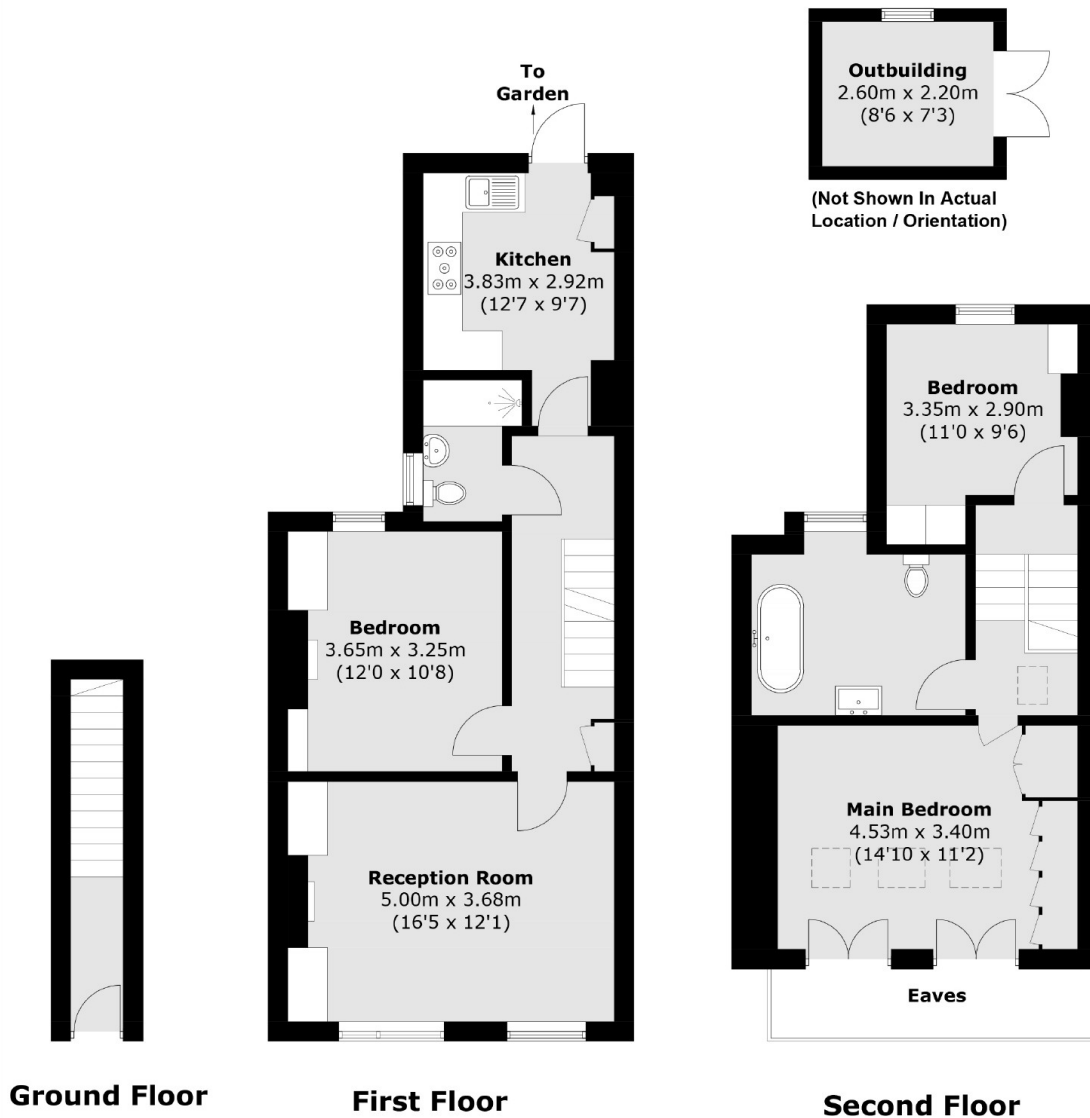

Total area (approx.): 96.1 sq. m (1,034.4 sq. ft)
(Excluding Eaves)
Outbuilding: 5.7 sq. m (61.3 sq. ft)