



Limetree Walk, SW17

£299,999

A beautifully presented one double bedroom apartment in the highly sought after development in central Tooting. This accommodation comprises of an open-plan kitchen/reception, one double bedroom and a three piece bathroom. The property is complete with communal gardens, private parking and a brand new lease.

Limetree Walk represents a close knit community of super homes, located moments away from the many shops, bars and restaurants of central Tooting. The vast open spaces of Tooting Bec Common are a short stroll away, with Tooting Bec and Broadway Underground Stations closeby.

Features

- One Double Bedroom
- Three Piece Bathroom
- Private Parking
- Communal Gardens
- High Desirable Location
- Brand New Lease

Limetree Walk, London, SW17

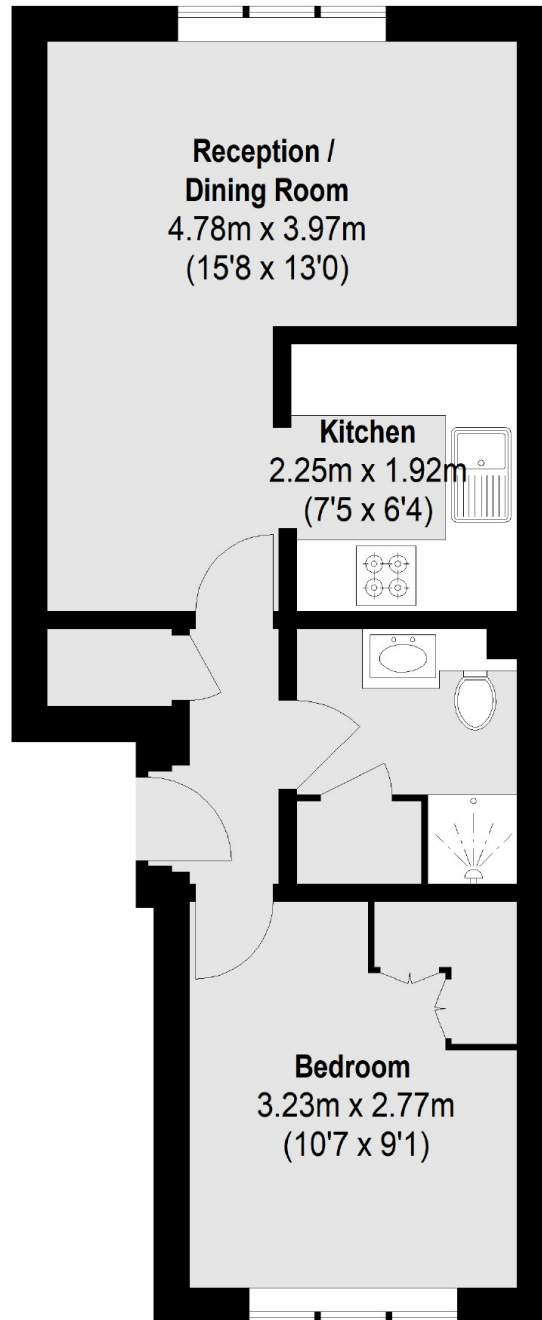

Ground Floor

Total area (approx.): 35.89 sq. m (386 Sq. ft)