



Lansdell Road, CR4

£425,000

A charming two double bedroom freehold house retaining all original features throughout with further scope for alterations and extending (STPP). Accommodation includes a generous front reception room with a dining room, an eat-in kitchen with access onto a private garden and two bedrooms and a family bathroom over the first floor.

Lansdell Road is conveniently located within great proximity to Figges Marsh and the vast amenities of both Tooting and Mitcham close by. The excellent transport links of Mitcham Eastfields and Tooting Railway station are also nearby.

Features

- Two Bedrooms
- Freehold Home
- Potential to Extend (STPP)
- Convenient Location
- Large Garden

Lansdell Road, Mitcham, CR4

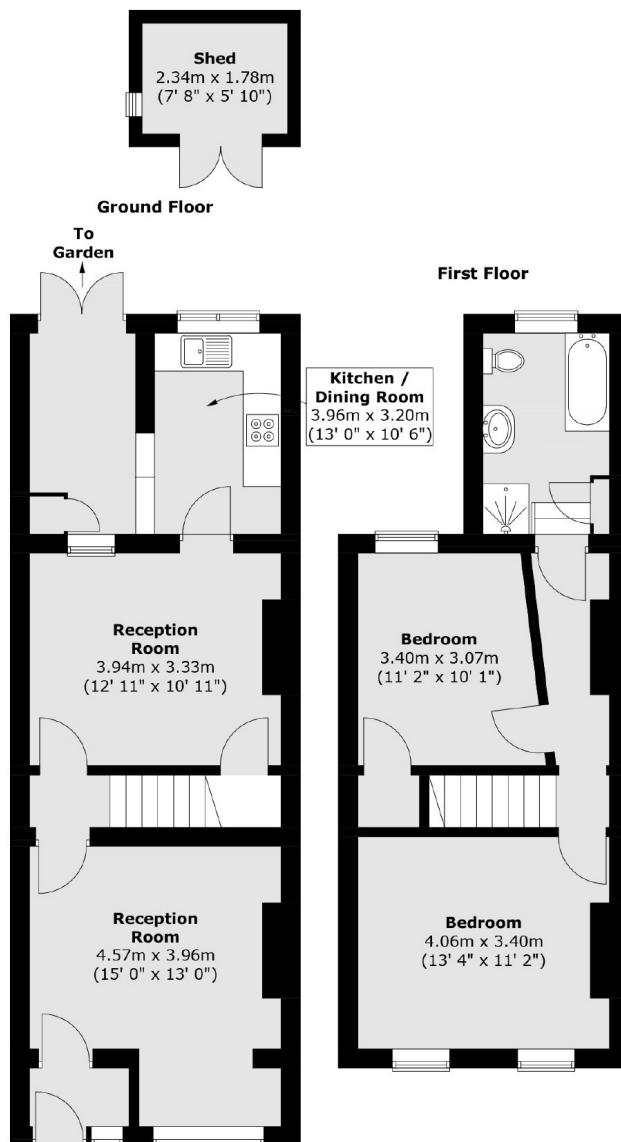

Total area (approx.) : 91.1 sq. m (981 sq. ft)
Total shed area (approx.) : 4.2 sq. m (45 sq. ft)