



Coteford Street, SW17

£545,000

A charming and characterful two bedroom freehold house set in the highly desirable Totterdown Fields Conservation Area with a spacious front reception room retaining original floors and a comfortable seating area, a spacious eat-in kitchen with doors leading onto a south facing garden and two double bedrooms and a family bathroom occupying the first floor.

Coteford Street is a quiet tree lined residential street nestled moments away from the green open spaces of Tooting Bec Common and the many shops, bars and restaurants of Tooting High Street with easy access to bus links and both Tooting Bec & Broadway Underground stations.

Features

- Two Bedrooms
- Freehold House
- South Facing Garden
- Desirable Location
- Period Features
- Chain Free

Coteford Street, London, SW17

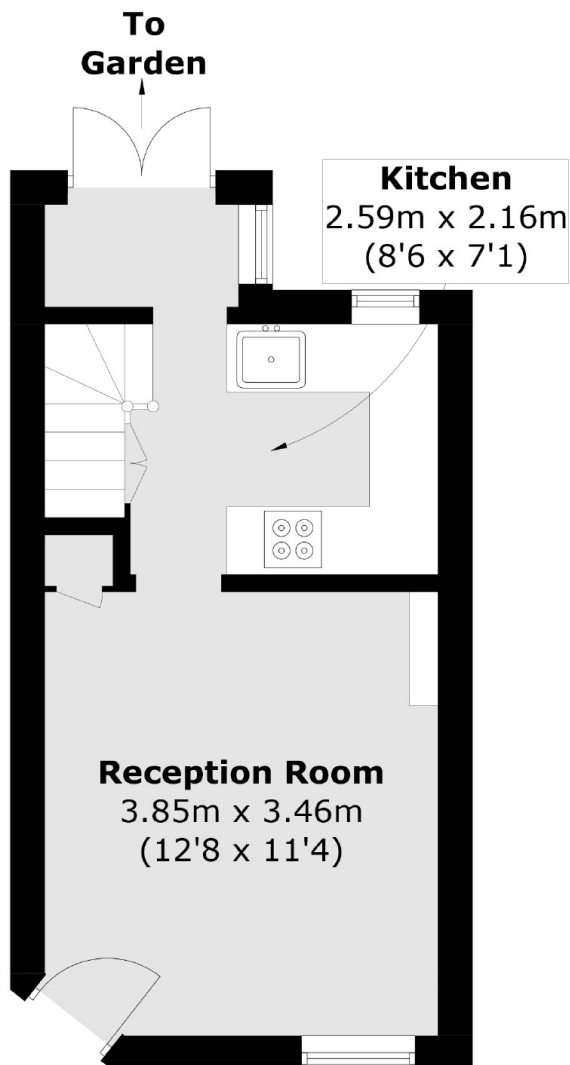

Ground Floor

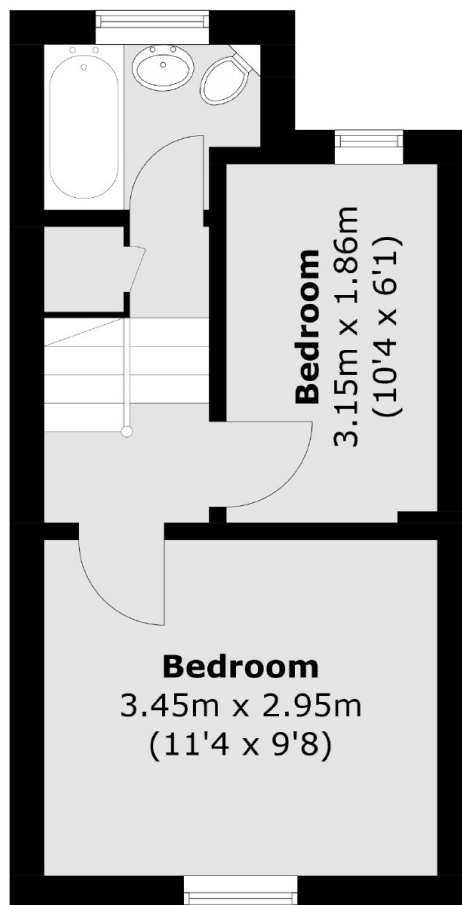

First Floor

Total area (approx.): 47.0 sq. m (505.8 sq. ft)