



## Garratt Lane, SW17

£685,000

A rare example of a three bedroom split level apartment located in the centre of Tooting. This accommodation spans up to 900sqft and retains three generous bedrooms, an exceptional living space, modern family bathroom. Complete with a share of the freehold and a large private garden.

Garratt Lane is perfectly positioned for the bustling streets, shops, bars and restaurants of Tooting Broadway with easy access to the many bus and transport links of Tooting Broadway Tube Station.

### Features

- Three Double Bedrooms
- Split Level
- Own Front Door
- Share of Freehold
- Private Garden
- Excellent Condition

# Garratt Lane, London, SW17

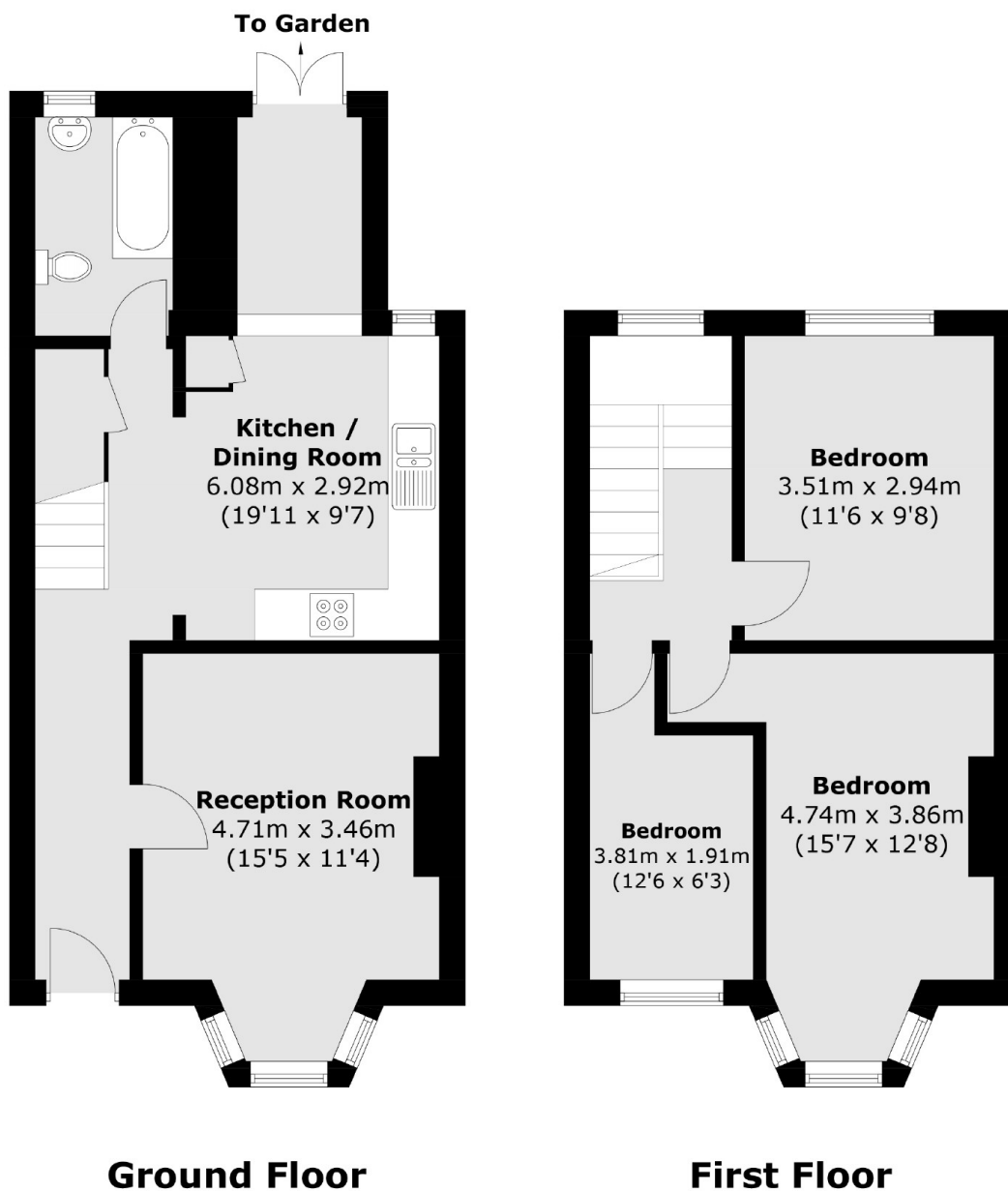

Total area (approx.): 83.2 sq. m (895.6 sq. ft)