



Garratt Terrace, SW17

£525,000

A delightful and well maintained two double bedroom ground floor garden flat located in the heart of Tooting. The property retains a large footprint with a spacious and comfortable reception room at the heart of the property and also comprises a separate kitchen, two double bedrooms, a stylish three piece bathroom and a south facing rear garden.

Garratt Terrace is an enclave of highly desirable homes and apartments with excellent proximity to shops, bars, restaurants and the desirable Tooting Market. Excellent transport links are also on the doorstep with Tooting Broadway Underground and many bus links a short walk away.

Features

- Long Lease
- Two Double Bedrooms
- Private South Facing Garden
- Desirable Location
- Large Reception Room
- Separate Kitchen

Garratt Terrace, London, SW17

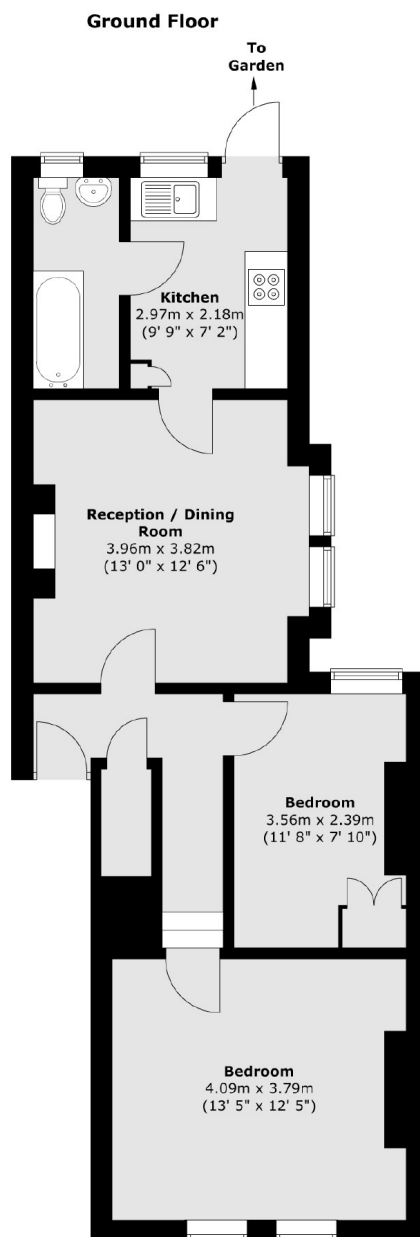

Total area (approx.) : 58.2 sq. m (626 sq. ft)

Dexters

Tooting
48 Tooting High Street
London
SW17 0RG
Sales
020 8545 8582

Energy Rating: . We aim to make our particulars both accurate and reliable. However they are not guaranteed; nor do they form part of an offer or contract. If you require clarification on any points then please contact us, especially if you're traveling some distance to view. Please note that appliances and heating systems have not been tested and therefore no warranties can be given as to their good working order.

 **RICS** | Regulated
Estate Agent
and Letting Agent

dexters.co.uk