



Flat 10 Streete Court, 22 Victoria Drive, PO21 2RL  
£120,000 Leasehold



1 Bedroom



1 Bathroom



1 Reception Room

*Sw*

Sims Williams



## Key Features

- Ground Floor Apartment
- One Bedroom
- Lounge/Diner
- Well Presented
- Kitchen/Breakfast Room
- Communal Gardens
- Long Lease
- Close To Seafront
- No Forward Chain

## EPC Rating

Current = C TBC

Potential = C TBC

## Council Tax Band

Band = A

## Tenure - Leasehold

Length of Lease: 28/09/2196

Years Remaining: 172

Ground Rent: £100.00 p.a

Service Charge: £1,989.40 p.a

Forward Funds: Upon Request



Approximate Area = 509 sq ft / 47.2 sq m

For identification only - Not to scale

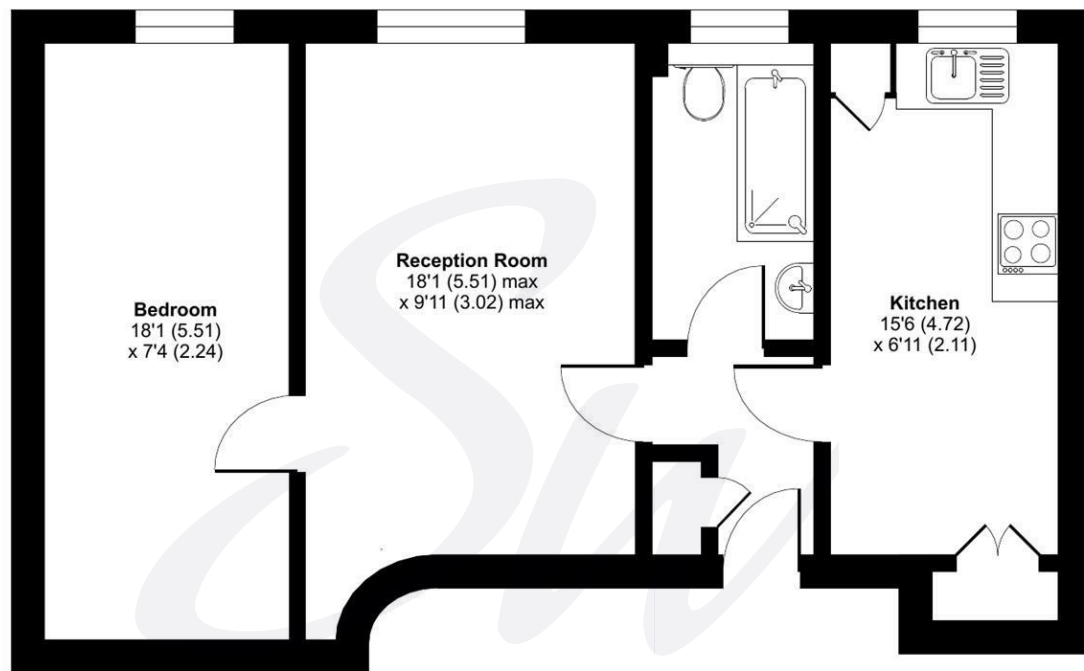

**GROUND FLOOR**



Floor plan produced in accordance with RICS Property Measurement 2nd Edition,  
Incorporating International Property Measurement Standards (IPMS2 Residential). © nichecom 2025.  
Produced for Sims Williams. REF: 1264366





[simswilliams.co.uk](http://simswilliams.co.uk)

#### CHICHESTER

---

8-9 Southgate  
Sales 01243 787868  
Lettings 01243 836055  
[chichester@simswilliams.co.uk](mailto:chichester@simswilliams.co.uk)

#### WALBERTON

---

5 Maple Parade  
Sales 01243 551368  
Lettings 01243 836055  
[walberton@simswilliams.co.uk](mailto:walberton@simswilliams.co.uk)

#### ARUNDEL

---

8a High Street  
Sales 01903 885678  
Lettings 01903 881133  
[arundel@simswilliams.co.uk](mailto:arundel@simswilliams.co.uk)

#### BOGNOR REGIS

---

46 High Street  
Sales 01243 862626  
Lettings 01243 836055  
[bognor-regis@simswilliams.co.uk](mailto:bognor-regis@simswilliams.co.uk)

Viewing Strictly by arrangement via the vendor's agent Sims Williams 01243 862626. These particulars are believed to be correct but their accuracy is not guaranteed and they do not form part of any contract.