





£600,000

# 57a Park Road

Hayling Island, PO11 0HT

- CONTEMPORARY DESIGN DETACHED HOME
- SHORT WALK FROM THE BEACH AND HAYLING ISLAND GOLF CLUB
- DRIVEWAY FOR TWO CARS
- TWO DOUBLE BEDROOMS
- BRIGHT AIRY ROOMS
- WEST HAYLING LOCATION

Built to a fantastic specification, this stunning contemporary design new build house located in the highly sought after West Hayling location is just a short walk from Hayling island beach and Golf Club and is situated down an extremely well thought of and picturesque tree lined road.



Nestled at the corner of the serene Sinah Lane and the picturesque Park Road on Hayling Island, this contemporary two-bedroom detached new build epitomizes modern coastal living. Just 500 meters from the Blue Flag beaches and Hayling Island Golf Club, and a short walk to the local amenities in West Town, this home offers the perfect balance of tranquility and convenience.

The sleek and stylish exterior is immediately welcoming, with a high-wall enclosed boundary and off-road parking accessible via a dropped kerb. The minimalist design and clean lines hint at the modern elegance found within. As you step inside, you are greeted by an open-plan living space bathed in natural light, with large windows framing views of the surrounding greenery, seamlessly blending the indoor and outdoor spaces. The living area is generously sized, perfect for both relaxation and entertaining, while the state-of-the-art kitchen features high-end appliances, sleek cabinetry, and a kitchen island—ideal for everything from casual breakfasts to gourmet dinners.

Both bedrooms are thoughtfully designed, providing a serene retreat, each with its own en-suite bathroom, ensuring privacy and comfort. The property benefits from energy-efficient features, including solar panels and double-glazed windows, offering environmentally conscious living while helping reduce utility costs.

Outside, the landscaped front garden offers a peaceful, low-maintenance retreat with a decked seating area and manicured lawn, perfect for enjoying the coastal air. The property also includes two off-road parking spaces, ensuring convenience for residents and visitors alike.

Located on one of the most sought-after roads on Hayling Island, residents will enjoy easy access to shops, restaurants, and recreational facilities. With its close proximity to the beach, scenic coastal paths, and the island's natural beauty, this property promises an unparalleled lifestyle. Whether enjoying the local golf club, taking in the stunning beaches, or exploring the island's rich history, this home offers a unique opportunity for luxurious coastal living.

Positioned at the corner of Sinah Lane, one of the island's most desirable locations, Hayling Island itself is a haven for nature lovers, history enthusiasts, and those seeking an active lifestyle, making this property perfect for full-time living or as a holiday retreat.







## Floor Plans

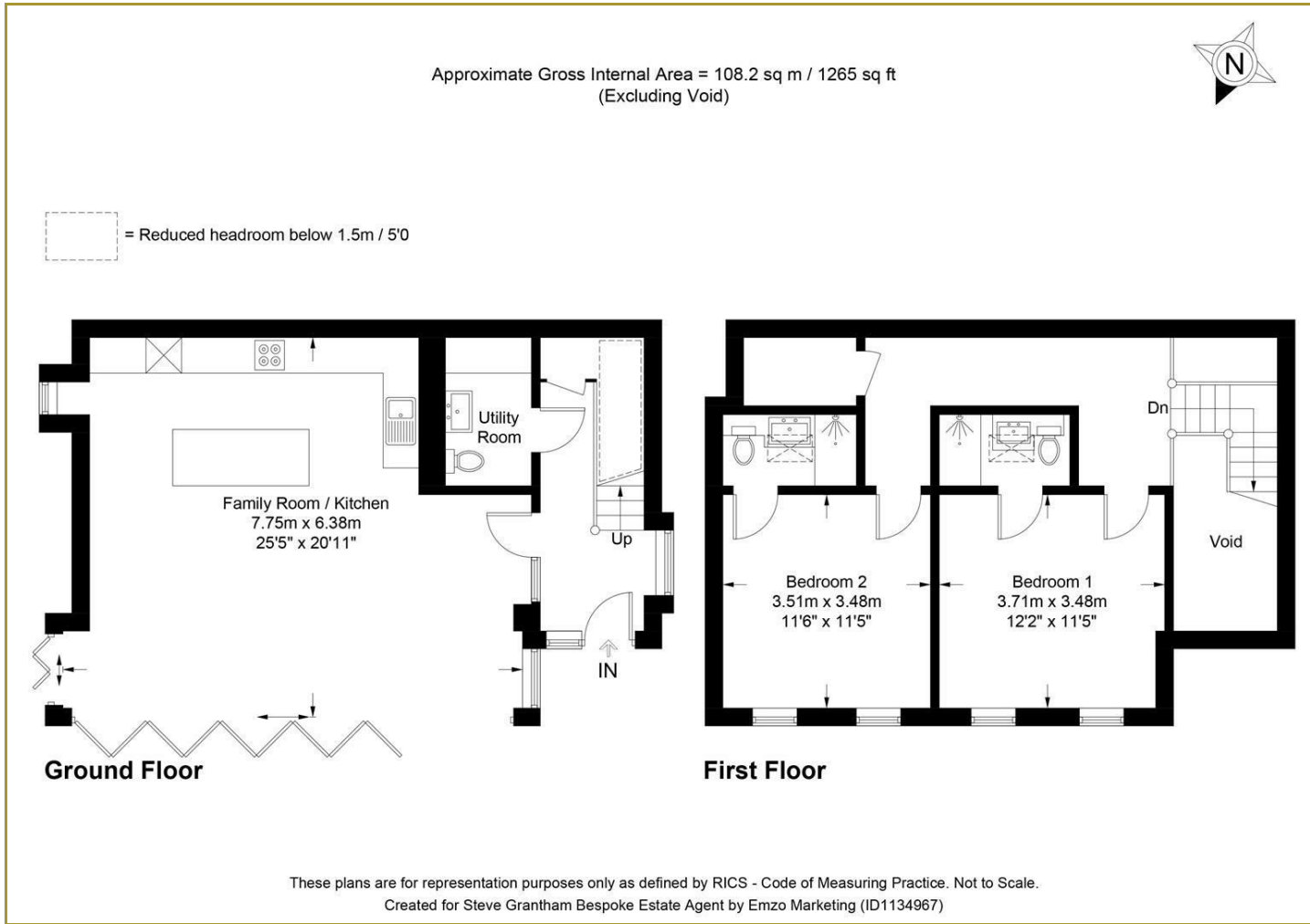

## Location Map

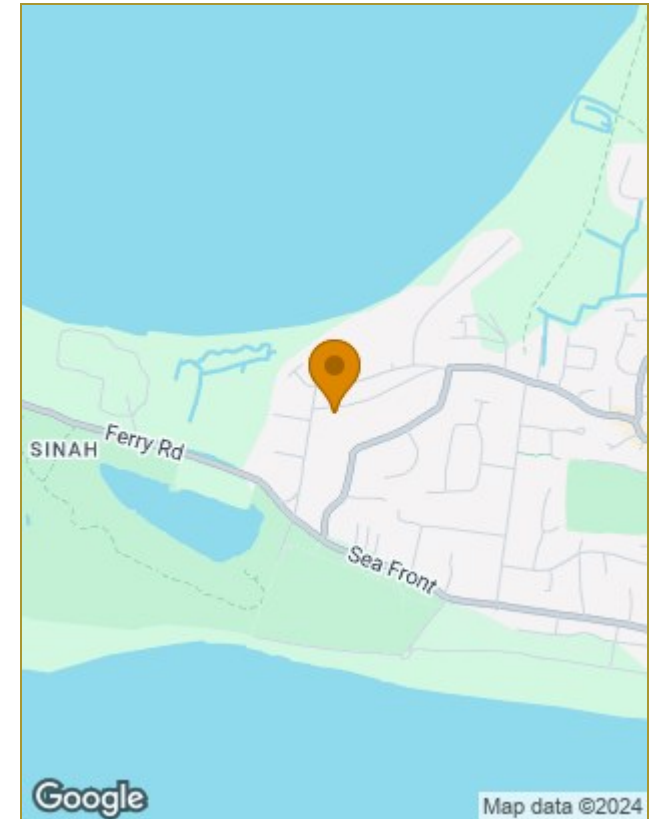

## Energy Performance Graph

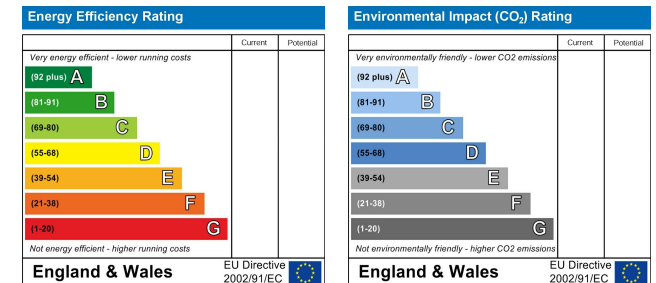

## Viewing

Please contact our Steve Grantham Bespoke Office on 02393 090015 if you wish to arrange a viewing appointment for this property or require further information.

The particulars are set out as a general outline only for the guidance of intended purchasers or lessees, and do not constitute, any part of a contract. Nothing in these particulars shall be deemed to be a statement that the property is in good structural condition or otherwise nor that any of the services, appliances, equipment or facilities are in good working order. Purchasers should satisfy themselves of this prior to purchasing.