





Offers in excess of £850,000

Whitehouse Little Hyden Lane

Clanfield, PO8 0RU

- ATTACHED HOME
- OVER 2500 SQ FT OF ACCOMMODATION
- LARGE MASTER BEDROOM WITH DRESSING ROOM PLUS EN-SUITE
- STUNNING VIEWS ACROSS SOUTHDOWNS NATIONAL PARK
- LANDSCAPED GARDEN PLUS ROOF TERRACE
- BEAUTIFULLY MODERNISED & EXTENDED
- FOUR BEDROOMS
- LARGE OPEN PLAN KITCHEN/DINING/FAMILY ROOM
- GOOD SIZED DRIVEWAY
- UTILITY ROOM PLUS BOOT ROOM

Welcome to this beautifully extended and modernised attached home, a captivating residence on the outskirts of the Southdown's National Park, boasting breathtaking panoramic views of the rural landscape. Aptly named with its appearance, reminiscent of its namesake, the White House, this residence is a local landmark renowned for its charm and character.



Believed to have origins as accommodation for priests associated with the neighboring chapel in the 1850s, this home seamlessly blends historical significance with contemporary elegance. Step inside, and you'll discover a harmonious mix of old and new, where the original features are preserved and enhanced by modern updates. The ground floor welcomes you with a large, open-plan kitchen/dining/family room adorned with floor-to-ceiling glazing. This design not only allows natural light to flood the space but also provides captivating panoramic views of the surrounding countryside. Sliding doors seamlessly connect this inviting space to the meticulously landscaped garden, creating a seamless indoor-outdoor flow. A snug living room, practical boot room, and a convenient cloakroom complete the ground floor layout. Ascend to the first floor, where luxury awaits. The spacious master suite boasts a walk-through wardrobe and a sumptuous en-suite shower room. French doors open onto a roof terrace, offering an idyllic spot to soak in the fantastic rural views. Another double bedroom, which also benefits from French doors to the terrace. A well-appointed family bathroom and a convenient laundry room, complete the first-floor accommodations. The top floor is a haven with two bedrooms featuring unique crescent windows, adding a touch of character and capturing the essence of this distinctive home. Outside, the lovingly landscaped garden provides an excellent entertaining area, where you can relax and enjoy the natural surroundings. A good-sized driveway ensures ample off-road parking, enhancing the practicality of this exceptional property.

In summary, this beautifully extended and modernized home invites you to experience a perfect blend of history and contemporary living. With its unique features, luxurious finishes, and captivating views, this residence is more than just a home; it's a lifestyle statement. Don't miss the chance to call this extraordinary property yours.







Floor Plans

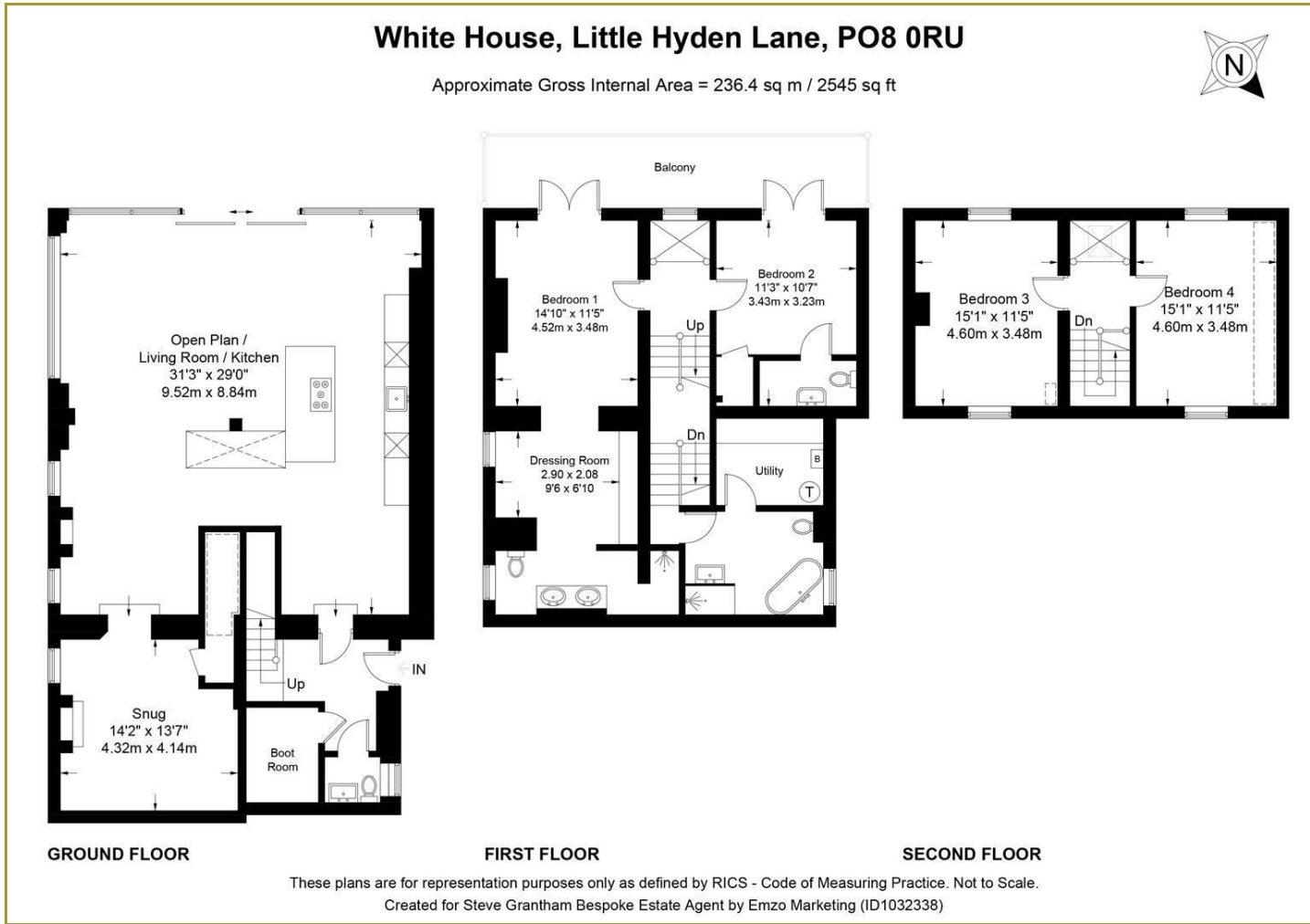

Location Map

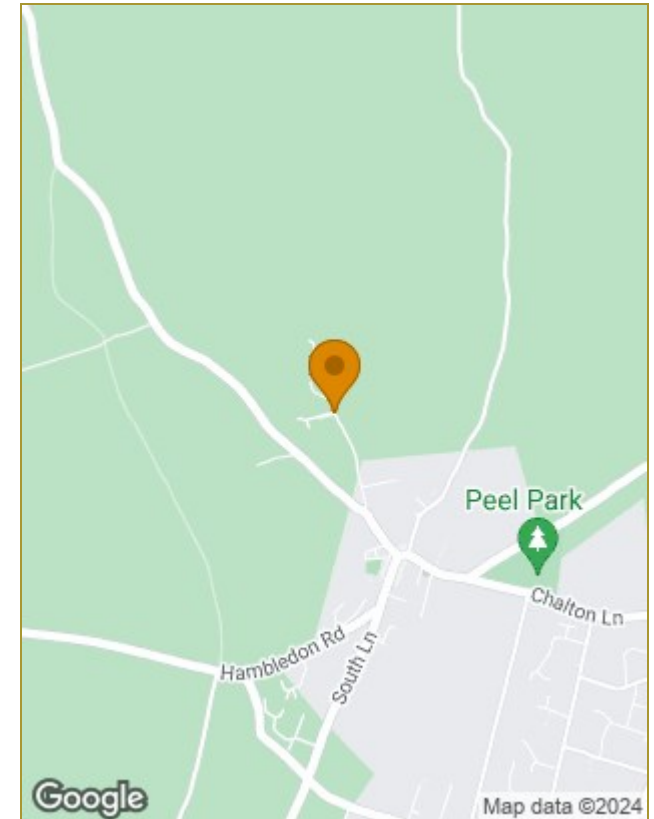

Energy Performance Graph

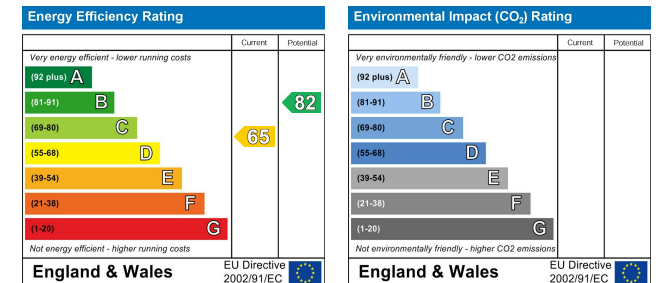

Viewing

Please contact our Steve Grantham Bespoke Office on 02393 090015 if you wish to arrange a viewing appointment for this property or require further information.

The particulars are set out as a general outline only for the guidance of intended purchasers or lessees, and do not constitute, any part of a contract. Nothing in these particulars shall be deemed to be a statement that the property is in good structural condition or otherwise nor that any of the services, appliances, equipment or facilities are in good working order. Purchasers should satisfy themselves of this prior to purchasing.