

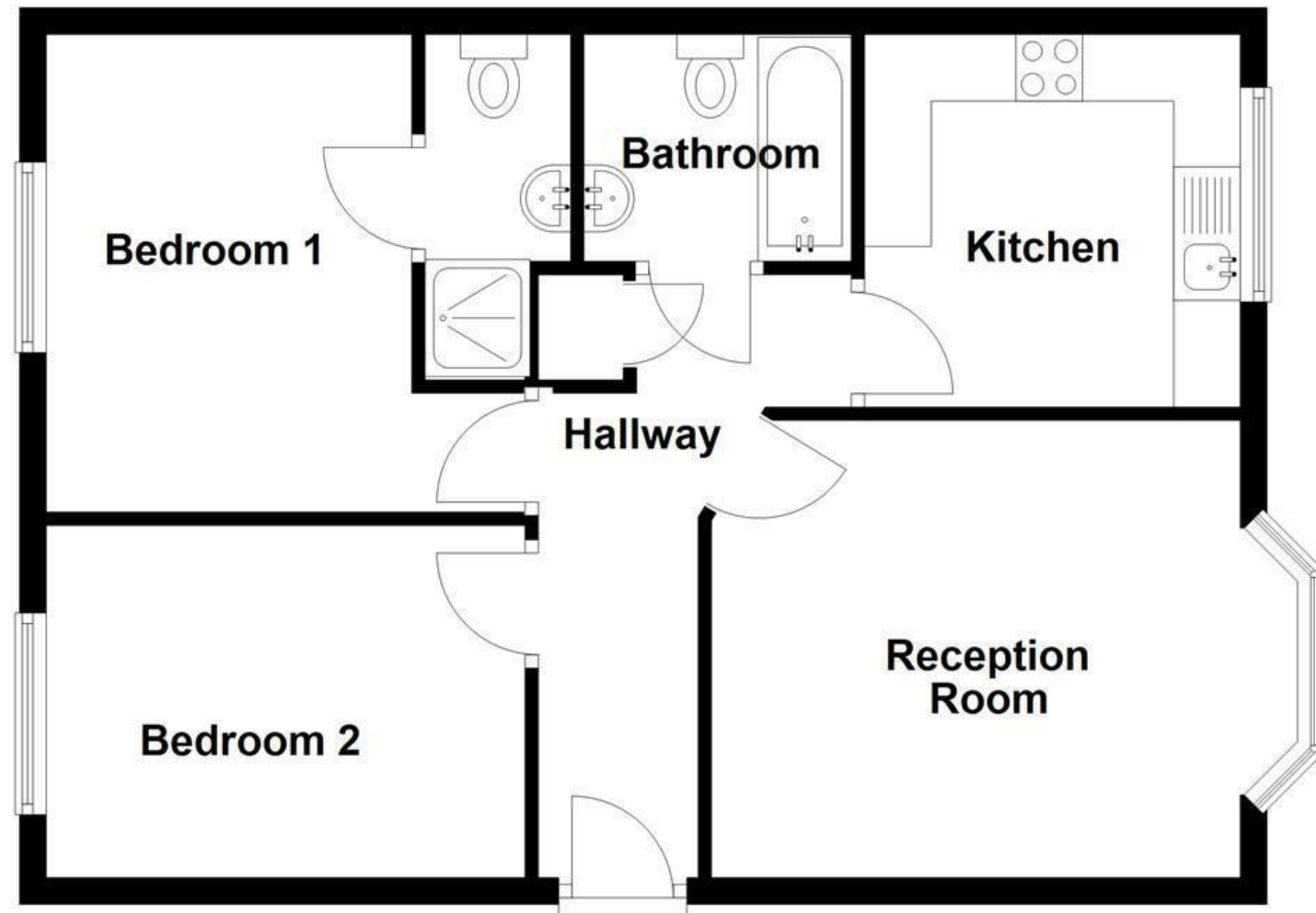

Ground Floor



Energy Efficiency Rating		
	Current	Potential
Very energy efficient - lower running costs		
(92 plus) A		
(81-91) B		
(69-80) C		
(55-68) D		
(39-54) E		
(21-38) F		
(1-20) G		
Not energy efficient - higher running costs		
England & Wales		EU Directive 2002/91/EC

These particulars, whilst believed to be accurate are set out as a general outline only for guidance and do not constitute any part of an offer or contract. Intending purchasers should not rely on them as statements of representation of fact, but must satisfy themselves by inspection or otherwise as to their accuracy. No person in this firm's employment has the authority to make or give any representation or warranty in respect of the property.

Derby Court, Bury, BL9 6WG

Offers Over £150,000

TWO BEDROOM GROUND FLOOR APARTMENT

Welcome to this charming two-bedroom ground floor apartment located in the desirable Derby Court, Bury. This delightful residence boasts a spacious living room, perfect for relaxation and entertaining. The apartment features two well-appointed bedrooms and two bathrooms, providing ample space for comfort and convenience.

The property is neutrally finished, allowing you to easily personalise the space to your taste. It is an ideal choice for a single occupant or a couple seeking the ease of ground floor living. Additionally, the apartment benefits from dedicated parking as well as visitor parking, ensuring that you and your guests have hassle-free access.

Situated in a prime location, this apartment offers convenient access to nearby amenities, making daily errands and leisure activities effortlessly manageable. Whether you are looking to enjoy the local shops, cafes, or parks, everything you need is just a stone's throw away.

This property presents an excellent opportunity for those seeking a modern and comfortable living space in a vibrant community. Do not miss the chance to make this lovely apartment your new home.

For the latest upcoming properties, make sure you are following our Instagram @keenans.ea and Facebook @keenansstateagents

Derby Court, Bury, BL9 6WG

Offers Over £150,000

 2  2  1  D

- Ground Floor Apartment
- Ensuite to Main Bedroom
- Leasehold
- Allocated and Vistor Parking
- Two Bedrooms
- Close To Amenities
- EPC Rating D
- Spacious Living Room
- Neutrally Finished
- Council Tax Band B

Entrance

Via communal lobby to ground floor entrance door to inner hall.

Inner Hallway

Doors to reception room, two bedrooms, bathroom, and kitchen.

Reception Room

15'1 x 11'3 (4.60m x 3.43m)

UPVC double glazed bay window, storage heater, television point, remote fire, wood effect flooring.

Bedroom One

11'9 x 11'8 (3.58m x 3.56m)

UPVC double glazed window, storage heater, door to ensuite.

Ensuite

8'6 x 3'7 (2.59m x 1.09m)

Dual flush WC, vanity top wash basin with mixer taps, direct feed shower, partially tiled elevations, tiled flooring.

Bedroom Two

11'8 x 8'8 (3.56m x 2.64m)

UPVC double glazed window, storage heater.

Bathroom

6'7 x 5'7 (2.01m x 1.70m)

Dual flush WC, vanity top wash basin with mixer taps, panel bath with mixer taps, partially tiled elevations, tiled flooring.

Kitchen

UPVC double glazed window, wall and base units with laminate work surfaces, oven with four ring electric hob, extractor hood and tiled splashbacks, stainless steel sink, draining board and mixer taps, integrated dishwasher and fridge freezer, tiled flooring.

External

Communally maintained gardens, parking and visitor parking.



Tel: 01617510340

www.keenans-estateagents.co.uk