

The Meadows, Cherry Burton, Beverley, HU17 7SD

Guide Price £375,000

🛏 3 🚿 2 🛋 3



REFERENCE BA0665

This particular property is situated in a very popular and highly desirable road within the village and occupies a deceptively spacious plot. Typical of its era, rooms are very well proportioned and benefit from a high level of natural light. The accommodation, especially to the ground floor, offers great flexibility in how the rooms could be used and there may also be scope to remodel the internal accommodation is so required and subject to building regulation approval. Overall the property presents well and although a certain level of upgrading may be required there is a great opportunity to create a fantastic and contemporary styled home in this very well served and sought after village.

- Well proportioned Lounge
- Dining Room/Study
- Kitchen/Breakfast Room
- Utility Room
- Ground Floor Shower Room
- Three/ Four Bedrooms
- Bathroom
- Oil Fired CH/ Double Glazing
- Good Sized Private Rear Garden
- Double Garage/ Driveway Parking

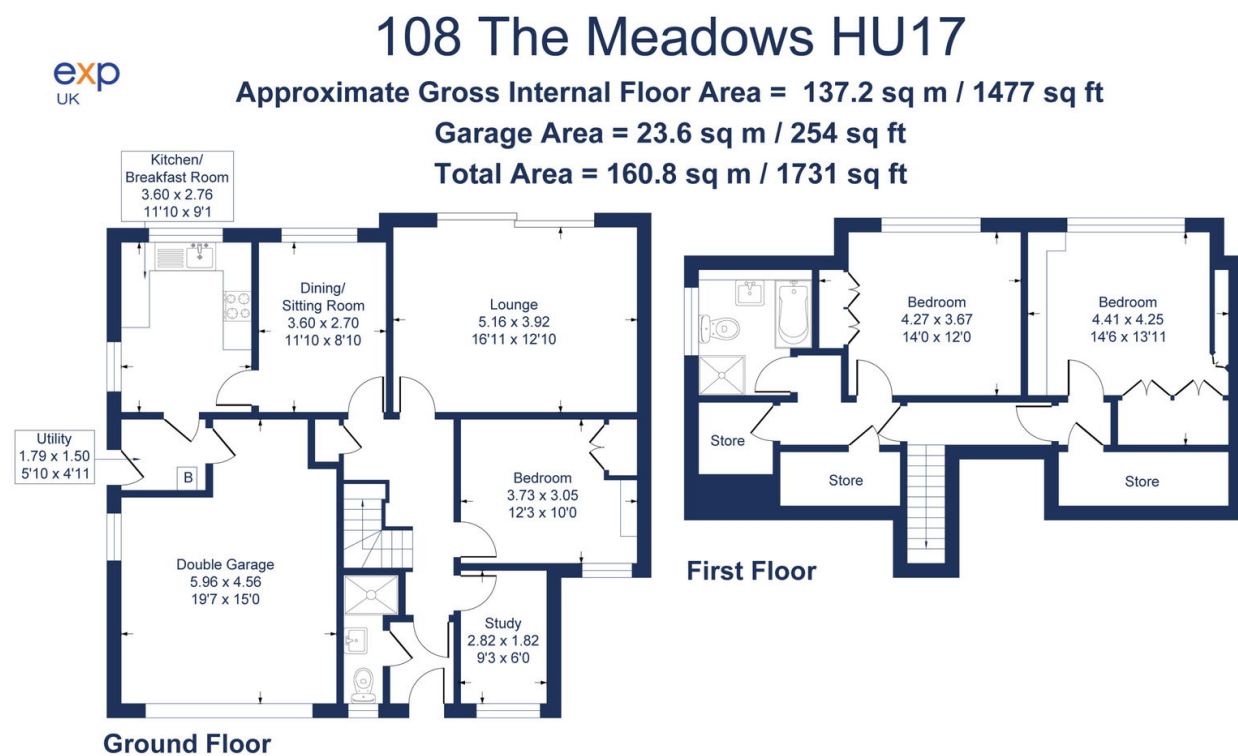

Illustration for identification purposes only, measurements are approximate, not to scale.