

Mill Lane, Bishop Burton, Beverley, HU17 8QT

Offers Over £925,000

4 3 3



BA0665

The village of Bishop Burton is a favoured, former Estates Village located approximately three miles west of Beverley and is regarded as a picturesque setting, surrounded by open countryside and with a very attractive open green space and village ponds. The village is served by a general store, post office, Church and public house. More comprehensive shopping can be found in Beverley and Market Weighton.

The Mill has been owned by my clients since 1993 and is the skilful integration of a former wind powered corn mill with a character period property, that occupies a plot of about half an acre, adjacent to open countryside in one of the prettiest Wolds villages. Improved and maintained to a very high standard, this home presents a superb opportunity for those discerning buyers looking for a comfortable and unique home.

- 23ft Drawing Room
- Dining Room
- Garden Room
- 32ft Bespoke Fitted Kitchen/Breakfast Room
- Utility Room
- 20ft Principle Bedroom Suite/En Suite Bathroom
- Bedroom Two En-Suite Shower Room
- Two Further Double Bedrooms
- Mature Landscaped South Facing Gardens
- Detached (20x18ft) Garage/ Driveway parking

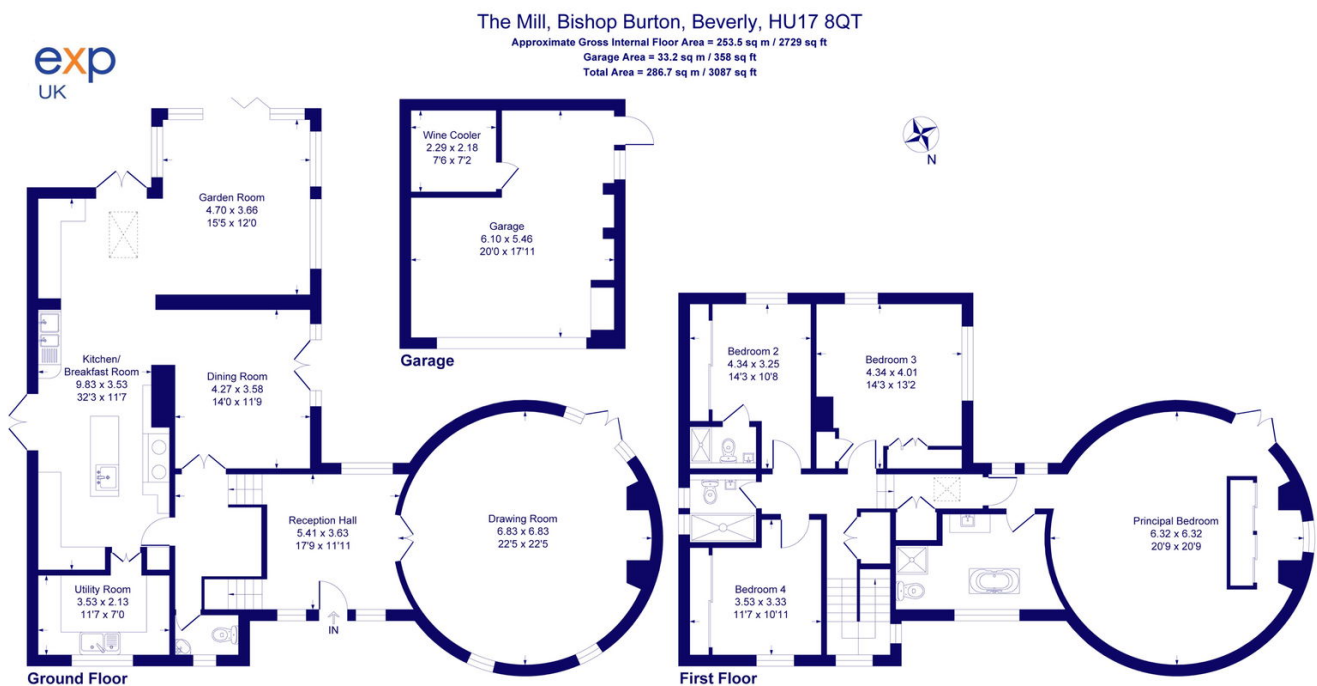

Illustration for identification purposes only, measurements are approximate, not to scale.