



BEN APPELLA

exp[®] UK



@ben.appella@exp.uk.com

benappella.exp.uk.com

07766 905 441

North End, Bishop Burton, Beverley, East Riding of Yorkshire, HU17 8JJ

Offers Over £750,000

 3  3  3



- Scenic Village Location
- 2023 Build
- Magnificent 30ft Live in Kitchen/Dining Room
- Utility Room
- 18ft Lounge
- Master Bedroom, En Suite Bathroom, Dressing Room
- Two Further Bedrooms/En Suite Shower Rooms/ Dressing Room
- First Floor Study/ Sitting Room
- Gardens and Additional Wooded copse
- Parking for Several Vehicles



Once in a while a property comes to the market that truly encapsulates great design, character, modern and practical internal finishings and a superb location. Dairy Barn is exactly that property. Converted from what was an agricultural building in 2023 this property retains great aesthetic appeal and nestles comfortably within its gardens offering fine South Westerly views to the front. All rooms are well proportioned with a great sense of light throughout. Quality materials have been used in the build to ensure the inherent character of the property is retained. Each bedroom is served by its own En-Suite, with two of the bedrooms having dressing rooms. The 18ft Lounge overlooks the rear garden and provides a very comfortable space to relax whilst the 30ft Kitchen/Live in Dining Room has been fitted with a comprehensive range of storage solutions and integrated appliances and is an ideal area for all year round entertaining with a seamless connection to the outside space.

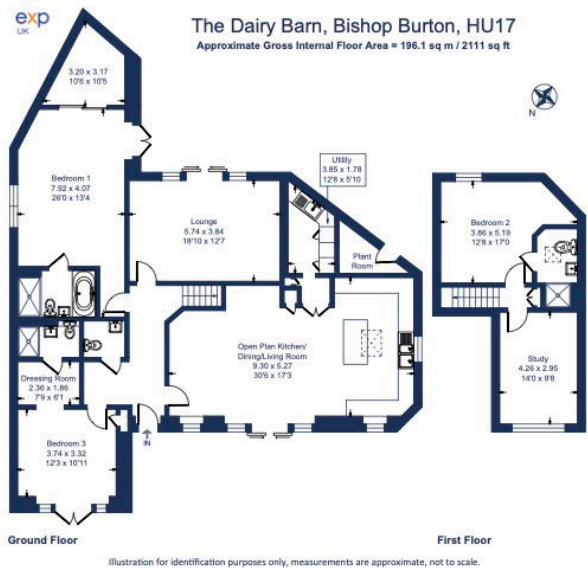

Score	Energy rating	Current	Potential
92+	A		
81-91	B		
69-80	C		73 C
55-68	D	66 D	
39-54	E		
21-38	F		
1-20	G		

The graph shows this property's current and potential energy rating.