



LINDA TAYLOR

exp[®] UK

@ linda.taylor@exp.uk.com

🌐 lindataylor.exp.uk.com

📞 07572 063 555

11 Green Lane, Tickton

£215,000

2 1 1



- Beautifully Presented
- 2 Double Bedrooms
- Detached Single Garage
- Driveway
- Well maintained rear Garden
- Open Views to the rear
- Main Services Connected
- EPC D , Council Tax Band B
- Move In Condition
- REF LT 0509



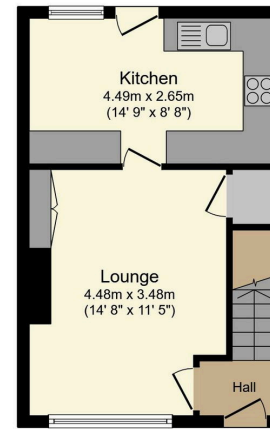

Ground Floor
Floor area 32.5 m² (349 sq.ft.)

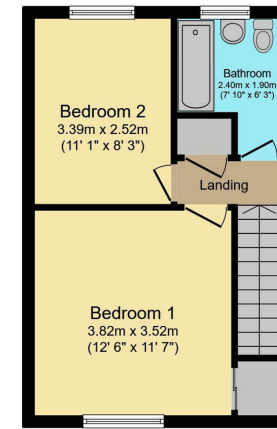

First Floor
Floor area 32.5 m² (349 sq.ft.)

TOTAL: 64.9 m² (699 sq.ft.)

This floor plan is for illustrative purposes only. It is not drawn to scale. Any measurements, floor areas (including any total floor area), openings and orientations are approximate. No details are guaranteed, they cannot be relied upon for any purpose and do not form any part of any agreement. No liability is taken for any error, omission or misstatement. A party must rely upon its own inspection(s). Powered by www.Propertybox.co

Please quote reference LT0509 A charming semi-detached house in the Village of Tickton near Beverley, featuring two spacious bedrooms, a well-appointed bathroom, an inviting reception room, dining kitchen with some integrated appliances, promising comfort, flexibility, and a unique living experience. With side drive, detached single garage, open views to the rear of the garden and patio, this is a fabulous starter home for first time buyers or anyone looking to downsize. Tickton has a local primary school and nursery, a village shop, a short car journey brings you to the market town of Beverley with access to the railway station, buses or why not take a short journey to the East Coast, via car, train or bus. The local garden centre is a great place with an abundance of plants and gifts as well as a café. All in all a fantastic place to live with a welcoming community. Call today to book your viewing.

